

**THIS DRAWING IS ISSUED  
 FOR REFERENCE ONLY**

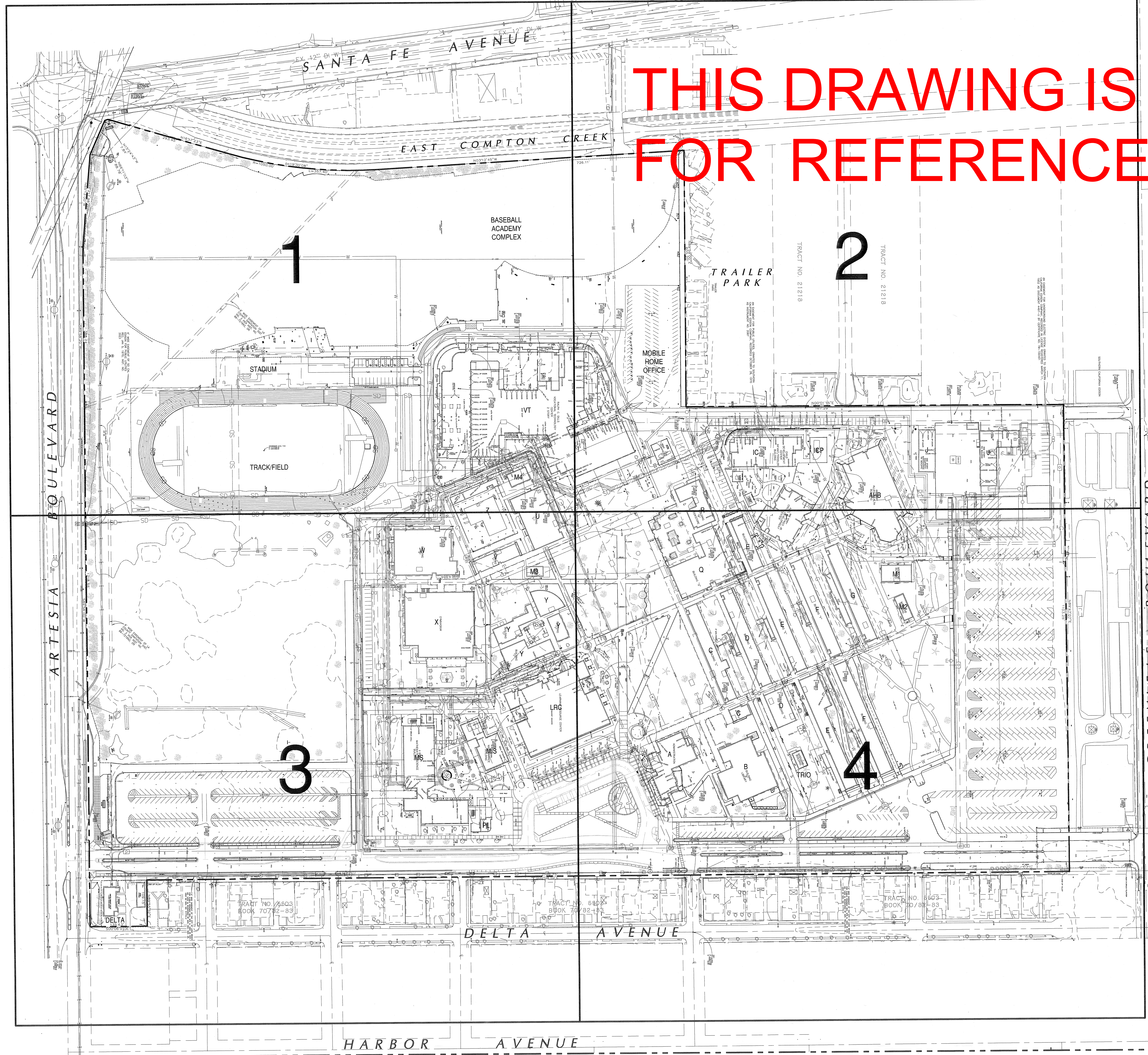

STAMP



CONSULTANTS:

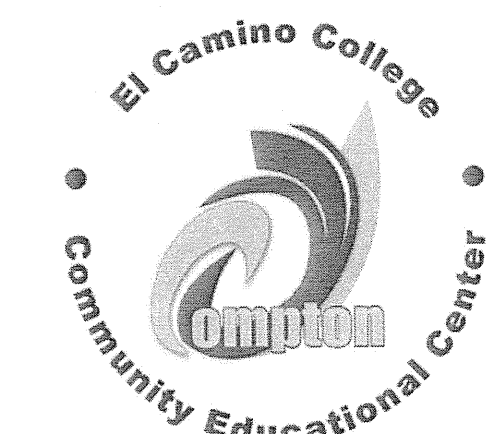

OWNER:

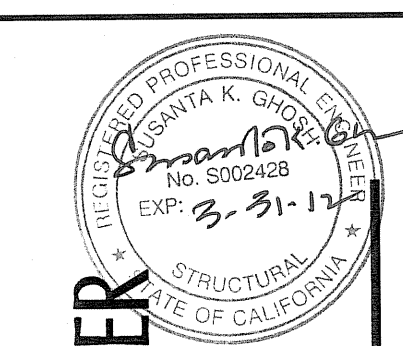

IDENTIFICATION STAMP  
 DIV. OF THE STATE ARCHITECT  
 APP03 1 1 3 7 8 0  
 DATE JUN 2 2011

**CAMPUS DIRECTORY**

- A ADMINISTRATION
- AHB ALLIED HEALTH BUILDING
- B LIBRARY
- C ACADEMIC / BUSINESS AFFAIRS / HR
- D WELCOME CENTER / STUDENT SUPPORT
- DELTA FOSTER / KINSHIP CARE EDUCATION
- E SOCIAL SCIENCE / FAMILY STUDIES
- F JOURNALISM / LANGUAGE / WRITING LAB / DSPAS
- G SPANISH / ACADEMIC SENATE / ASSESSMENT CTR.
- GH GREENHOUSE
- HC INFANT CARE DEVELOPMENT BLDG.
- ICP INFANT / TODDLER PLAYGROUND
- J MAINTENANCE
- LRC LEARNING RESOURCE CTR.
- M1 ESL / PHILOSOPHY
- M2 UNION INSTITUTE
- M3 CAMPUS POLICE
- M4 CAMPUS POLICE LOCKER ROOMS
- M5 MATH / SCIENCE
- MS MANAGEMENT INFORMATION SYSTEMS
- PL PLANETARIUM
- Q STUDENT LOUNGE / CAFETERIA
- R BOOK STORE
- T CHILD DEVELOPMENT CTR.
- TRIO TALENT SEARCH / UPWARD BOUND / MATH & SCIENCE
- U EOPAS / CARE / WOMEN'S LOCKER ROOM
- V CLASSROOMS
- VT VOCATIONAL / TECH
- W1 PHYS. ED. / MEN'S LOCKER ROOM
- X GYMNASIUM
- Y MUSIC / THEATRE ARTS
- Z SWIMMING POOL

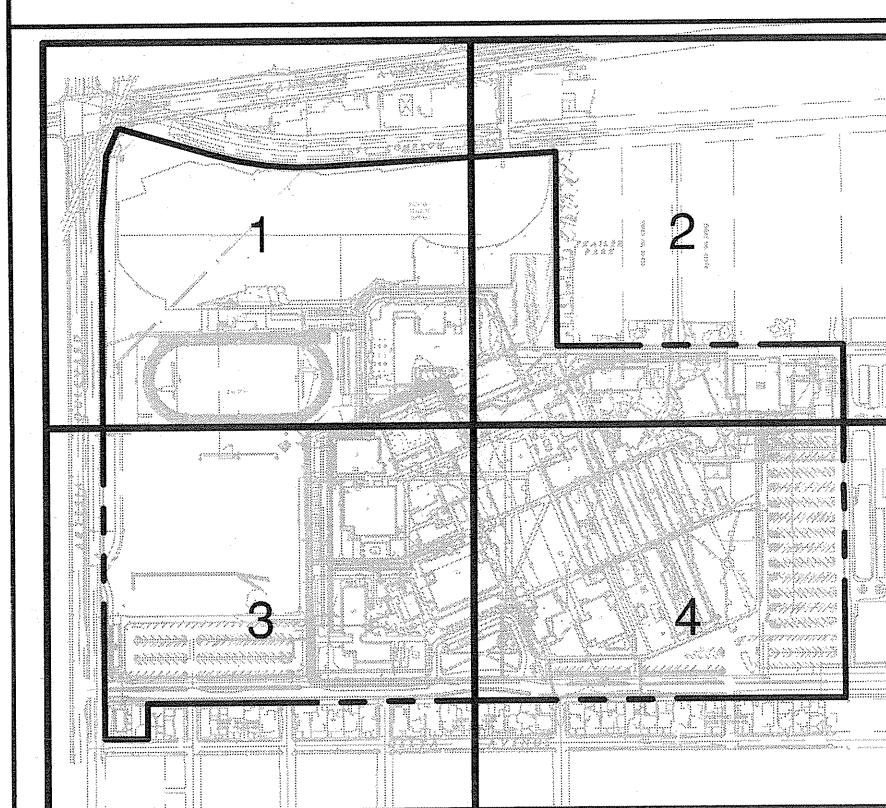

KEY PLAN

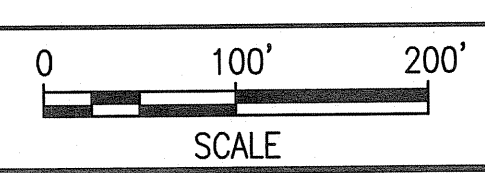

MASTER SURVEY - OVERALL

COMPTON COMMUNITY COLLEGE DISTRICT  
 EL CAMINO COLLEGE  
 COMPTON COMMUNITY EDUCATIONAL CENTER  
 UTILITY INFRASTRUCTURE - PHASE 2  
 CONTRACT DOCUMENTS

PROJECT: 1111 E. ARTESIA BLVD. - COMPTON, CA 90221

DRAWN BY: K.H./N.F. CHECKED BY: S.G./C.C.

DATE: 04/07/11

REVISIONS		
NO.	DESCRIPTION	DATE
1	DSA SUBMITTAL	11/30/10
2	ISSUED FOR REVISION NO. 1	04/07/11

DRAWING TITLE:  
**MASTER SURVEY  
 (OVERALL)  
 (FOR REFERENCE ONLY)**

DRAWING NO:

**C1.0**

P:\2008\105107 Compton Community College\WMS SHEET\Phase 2\105107-C1.DWG pld.dwg 05/07/2011 11:39am, ldon