

# EL CAMINO COLLEGE COMPTON CENTER



WINTER CLASS SCHEDULE 2009



[www.compton.edu](http://www.compton.edu)

EL CAMINO COLLEGE COMPTON CENTER  
1111 E Artesia Blvd. Compton CA 90221 310-900-1600

WINTER SESSION BEGINS JANUARY 7

## Winter Session 2009 Calendar

Continuing Student Web/Telephone Registration Begins	Tuesday, November 18
Last Day for F-1 Visa Students Outside the United States to Apply	Monday, December 1
New and Returning Student Web/Telephone Registration Begins	Monday, December 8
Last Day for F-1 Visa Students Inside the United States to Apply	Monday, December 15
Winter Holiday Break - Campus Closed	Saturday, December 22 - Tuesday, January 1
Admissions and Records Reopens to the Public	Monday, January 5
First Day to Apply for Spring Graduation and Certificates	Monday, January 5
All Web/Telephone Registration Ends for Winter 2009 at 11:59pm	Tuesday, January 6
Classes Begin	Wednesday, January 7
Add Period and Program Change Period Begins	Wednesday, January 7
Add Period and Program Change Period Ends	Tuesday, January 13
Last Day to Drop and be Eligible for a Refund of Enrollment Fee	Tuesday, January 13
Last Day to Drop Without Notation on Permanent Record	Thursday, January 15
Martin Luther King's Holiday - Campus Closed	Monday, January 19
Last Day to Drop with a "W"	Friday, January 30
Last Day of Winter Session	Tuesday, February 10

*Weekend Classes are not held during Winter Session*

## Table of Contents General Information

How to Reach Us	2
Steps to Registration	3
Fees	4
Cross Enrollment	6
Policies and Services	6
Prerequisites	6
Financial Aid Charts	11
Distance Education	13
Study Abroad	20
Campus Maps	22



### How to Reach Us:

**Academic Affairs (C-32): 310-900-1600, ext. 2133**

**Student Services (Administration Building):  
310-900-1600, ext. 2023**

#### Academic Division Office Telephone Numbers

Behavioral and Social Science/Fine Arts	ext. 2210
Business/Computer Information Systems	ext. 2271
Counseling	ext. 2076
Human Services/Nursing/Child Development	ext. 2700
Humanities/ESL/Foreign Languages	ext. 2234
Mathematics and Natural Science	ext. 2332
Vocational/Technical; Family and Consumer Studies; Physical Education/Health Education	ext. 2620

#### Student Services Telephone Numbers

Admissions and Records Office (Administration Building)	ext. 2050
Assessment Center	ext. 2830
Associated Student Body / Student Life (R-61)	ext. 2802
Athletics	ext. 2949

Bookstore	ext. 2820
Bursar's Office (C-36)	ext. 2104
CalWORKs	ext. 2072
Campus Police	ext. 2999
Child Development Center	ext. 2902
Counseling (Administration Building)	ext. 2076
Special Resource Center - (DSP&S)	ext. 2402
EOP&S/CARE (U-6)	ext. 2912
Financial Aid (E-12)	ext. 2935
International Students (Administration Building)	ext. 2043
Job Placement / Career Center (VT-109)	ext. 2788
Learning Resource Center (G-33, G-39)	ext. 2535
Library	ext. 2175
Scholarship/Foundation Office (C-33)	ext. 2971
Student Support Services (D-29)	ext. 2502
Transfer Center (D-29)	ext. 2764
Veterans Office (Administration Building)	ext. 2043
Welcome Center/Outreach (D-28)	ext. 2763

### Register Online

Contact Us on the Web [www.compton.edu](http://www.compton.edu) | High School Recruiter [comoutreach@elcamino.edu](mailto:comoutreach@elcamino.edu)



## STEP 1 | Admission

### Who is eligible for Admission?

Anyone 18 years of age or older qualifies for admission to El Camino College Compton Center. If under the age of 18, you will qualify if you have 1) graduated from high school or 2) passed the California High School Certificate of Proficiency Test.

El Camino College Compton Center may admit as a special part-time or special full-time student anyone in grades 11 or 12 who, in the opinion of the provost, may benefit from instruction. Concurrently enrolled 11th and 12th grade students must comply with all policies, follow all procedures, and meet all requirements by the published deadlines for each semester and/or session.

### California Residence Requirement

#### Can I apply as a California resident?

To attend El Camino College Compton Center as a resident of California, a student is required to have been a legal resident of the state, as defined in the California Education Code, for more than one year immediately preceding the residence determination date. The residence determination date is the day preceding the first day of the semester or session.

In addition you must meet the two-year intent provisions of California residency code, and must not have engaged in any actions that are contrary to establishing residency in the state of California.

#### How Do I Apply?

Apply online by visiting: [www.compton.edu](http://www.compton.edu) and clicking on **Apply Online** - it's that easy! New and returning students (those with an absence of two consecutive semesters, excluding Summer and Winter Session) must complete an application. Don't forget to submit official transcripts from all accredited colleges, and trade schools attended. If you are applying for Advanced Placement credit, then you must submit your official high school transcripts.

## Step 2 | Assessment

### How Do I Make Arrangements For Testing?

Personal identification with a photograph and your El Camino College Compton Center I.D. number are required to take tests and receive results.

You must have an application on file prior to any testing. Testing should be completed as soon as possible after you file your admission application. Read the catalog description of classes which interest you to learn if there is any testing recommended or needed. Keep in mind that all placement tests are part of the multiple measures of the assessment process. Be sure to take testing results with you when you go for your academic advisement or educational planning sessions.

The placement tests for English, English

as a Second Language, and Math are computerized and given on a drop-in basis—no appointment is necessary. Other tests, such as the Chemistry Placement Test, are given on an appointment-basis only. Please contact the Assessment Center for further information at 310-900-1600 ext. 2830.

All testing is done on Campus at the Assessment Center. Testing must be completed before you register for courses. Retesting is limited and may not be done after you have enrolled in any course related to the test.

## STEP 3 | Orientation

Welcome to El Camino College Compton Center! All students are encouraged to participate in orientation and to become familiar with the center and its resources.

Sign-up for Winter 2009 student orientations in the Counseling Department, located in the Administration Building. Students learn about campus services and programs through the orientation provided by the Counseling Department.

For more information about campus orientations, please contact the Counseling Department at 310-900-1600 ext. 2076.

## STEP 4 | Counseling/ Advisement

### How can I get help selecting classes?

Counseling services are available to students through scheduled appointments. A student who has selected a major field of study is strongly encouraged to see one of the counselors assigned to that field; an undeclared or undecided student may see any counselor.

As an integral part of the matriculation program, counseling services are intended to assist students in clarifying career and life goals and in developing an appropriate course of study based on a student's goals, aptitudes and interests.

Drop-in advisement is available Monday through Thursday from 8 a.m. to 6:30 p.m. and Fridays from 8 a.m. to 4:30 p.m. for students who have questions which do not require transcript review. The drop-in advisement schedule is subject to change, based on counselor availability. Please call the Counseling Department in advance for the daily schedule at 310-900-1600 ext. 2076.



## STEP 5 | Registration

### How do I prepare to register?

#### Ready – Set – Register!

- Be sure you meet any prerequisites and corequisites.
- Meet with a counselor to ensure your schedule is in line with your educational goals.

#### New Procedure

Registration appointment information for continuing students will be available beginning November 10, 2008. For new and returning students, this information will be available on or after December 1. Please go online to [www.compton.edu](http://www.compton.edu), click on **MyECC - Registration Appointment Time**. You may also check by telephone by calling (310) 516-9339.

**Before you go online or register by telephone, you must confirm your registration date and time.**

#### When Do I Register?

Find out your registration date and time - it is available online at: [www.compton.edu](http://www.compton.edu) - click on **MyECC - Registration Appointment Time**.

*Students may not register prior to the assigned date and time.*

#### How Do I Register?

Register online at [www.compton.edu](http://www.compton.edu) and click on **MyECC** or by telephone at 310-516-9339. You will be given clear, easy-to-follow, step-by-step instructions. Computers are available for student use in the Welcome Center, Financial Aid, Admission Office Informational Center, VT 209, and Library.

## STEP 6 | Pay Fees

All students who enroll in credit classes must pay an enrollment fee. Students must pay the appropriate enrollment fee at the time of registration. Financial assistance (Board of Governor's Fee Waiver) is available to pay the registration fees and the health fee if the student is eligible. A Board of Governor's Fee Waiver application is available online at [www.compton.edu](http://www.compton.edu) - **MyECC**, or apply at the Financial Aid Office.

Until all fees are paid, students will not be able to purchase parking permits, receive transcripts, or register for upcoming semesters.

The general fee requirement shall not apply to students enrolled in the non-credit courses specified in Education Code Section 84711.

Out-of-state students who have a Free Application for Federal Student Aid (FAFSA) on file in the Financial Aid Office are encouraged to submit the preliminary documents for review as early as possible. **Students are responsible for paying all fees and charges even if they applied for financial aid by the established deadlines.**

## Fees

You are liable for all fees unless you drop the class by the refund deadline date. Fees are due within 7 days of phone or Web registration. Walk-In Registrants: Fees are due at time of registration. All fees are subject to change.

### ALL FEES ARE SUBJECT TO CHANGE

Enrollment Fee	.....\$20 for each credit unit
Parking - Car	.....\$12 for session
ASB Student Discount Sticker	.....\$10 for session
ASB Representation Fee	.....50¢ for session
Out-of-State Fee	.....\$181 per unit plus \$20 per unit
Out-of-Country Fee	.....\$195 per unit plus \$20 per unit
Auditing	.....\$15 per unit
Transcripts (first two free)	..\$3 each, \$5 for next day or hand-carry

### Bursar's Office Hours - (C36)

Monday, Tuesday, Thursday, 8:30 a.m. - 4:00 p.m.; Wednesday, 8:30 a.m. - 6:30 p.m.;  
Friday 8:30 a.m. - 1:00 p.m.

### First Two Weeks of the Session Hours:

Monday - Thursday, 8:30 a.m. - 6:30 p.m.; Friday, 8:30 a.m. - 1:00 p.m.

## Financial Assistance

All students are encouraged to apply for financial aid by visiting the Financial Aid Office Web site at:

[www.compton.edu](http://www.compton.edu). Begin by clicking the Apply Online button and follow the instructions for a new student (never attended college) or returning student (break in enrollment) or continuing student (no break in enrollment) column. Please review the available resources on the financial aid Web site under the Information Desk, Programs, Services and Free Calculators.

California residents may wish to apply for a Board of Governor's Fee Waiver (BOGW) to pay for their enrollment fees. Students are encouraged to complete the Free Application for Federal Student Aid (FAFSA) to determine eligibility for all federal, state and institutional programs. Some students in certain programs such as CalWORKS, CARE, or EOP&S may also complete the fee waiver application in addition to the FAFSA form. Please see enclosed applications.

## Fee Payment

For any fee paid, the college will accept personal checks drawn on United States banks, money orders or cash.

Also honored will be VISA, American Express, MasterCard and Discover credit cards. Checks returned by a student's bank for any reason will result in (1) suspension from enrollment, (2) denial of subsequent registration and (3) detention of transcript until the financial obligation

has been satisfied. A service charge of \$20 will be charged on any returned check.

## Refunds of Fees

Students must drop their classes through the online system located in the Administration Building, by phone or by Web, according to the following schedule:

Classes must be dropped by Tuesday, January 13, 2009.

To receive a refund for a parking permit, you must return your permit to the cashier's window within this same time period. Refund checks will be mailed before the end of the semester.

If your address has changed, please update the change in the Admissions Office.

## Non-Resident Refund Policy

To receive a refund of your non-resident tuition, you must drop your classes through the on-line system in the Admissions and Records Office (Administration Building) according to the following schedule:

100% refund for classes dropped by Tuesday, January 13, 2009.

50% refund for classes dropped by Tuesday, January 20, 2009.

Refund checks will be mailed by March 16, 2009.

## California Residency

To attend El Camino College Compton Center as a qualified California resident, you must have established legal residence in the state one year and one day prior to the start of the term. In addition, you must meet the two-year intent provisions of California residency code and must not have engaged in any actions that are contrary to establishing residency in the state of California. The burden of proof to clearly demonstrate both physical presence in California and intent to establish California residence lies with the student in accordance with Education Code Section 68040.

The residence of an unmarried student under the age of 19 is determined by the legal residence of the parents. A married minor determines residency from the date of marriage and must comply with all provisions of residency as cited above. A person may not derive residence from a spouse.

## Priority Registration

In compliance with Section 51825 of Title 5, California Administrative Code, priority registration will be implemented in this way:

1. Special registration assistance to the handicapped or disadvantaged students as defined by statute for the purpose of providing equalization of education.

2. Students will receive priority registration according to this ranking system and criteria:

- Registration priority will be awarded as follows:

A. First priority: continuing students

B. Second priority: new and readmit students

- For fall and spring semesters, the enrollment of continuing students in accordance with priority system established on the basis of these factors:

A. One point for each unit completed at El Camino College Compton Center plus one point for each unit in which the student is currently enrolled (midterm) with a maximum of 60 points.

B. Points awarded according to the total units in the current program after the 12th week as follows: 0 to 3 units equals 0 points; 3.5 to 6 units equals 2 points; 6.5 to 9 units equals 4 points; 9.5 units to 15 points equals 6 points and 15.5 plus units equals 10 points.

C. A reward of 15 points to students for maintaining their original unit load from the start of the semester through

the 12th week.

D. A reward of 10 points to students with 2.0 or higher cumulative GPA

E. Day and evening programs are used to divide the student body into a day or extended day priority system. One or more day classes constitutes a day program.

3. The early enrollment of students who meet one of these guidelines:

- Instruction program requires time off campus limiting the choice of class periods on campus.
- The instructional activity requires a block of time associated with scheduled classes for such activities as practice, meetings, counseling and off-campus travel.
- First semester F-1 visa students.

## Adds and Drops

It is the student's responsibility to process an official withdrawal from class. Failure to do so may result in a letter grade of A through F. A student may drop a class or classes within the refund period and add another class or classes using the fees already paid.

If a student drops after the refund deadline, payment of fees for the classes is forfeited. Any added class will require additional fees.

A student may drop a class before the refund deadline and add a class with no additional fees. If a student drops a class after the refund deadline in order to add the same class at a different time/date/instructor, the student must request a lateral transfer or level transfer from both instructors. All transfers are processed through the Admissions and Records Office.

## Withdrawal from Class

**It is the student's responsibility to process an official withdrawal from class at the Admissions and Records Office. Failure to complete this process may result in a letter grade of A through F recorded on the student's permanent record.**

It is the high school student's responsibility to submit all required documentation on time and complete by the published deadlines. Failure to do so will jeopardize the student's enrollment for the semester/session.

## Photo Identification and ASB Stickers

All students are required to obtain a free El Camino College Compton Center identification card. These cards are available in the Student Life Office Monday - Thursday, 8 a.m. - 8:30 p.m. and Friday, 8 a.m. - 4:30 p.m.

These cards serve as photo identification, and are required for library services, campus activities, access to the Learning Resource Center and Open Computer Labs, and to verify attendance in classes.

All students are encouraged to purchase an optional ASB sticker for their photo identification cards during registration at the Bursar's Office. The ASB sticker offers a variety of discounts at businesses, theaters, ASB sponsored events, and athletics events. El Camino College Compton Center students can also utilize ASB stickers on the El Camino College campus including access to Activities Center table games, free admission to all campus athletic events and a discount on tickets at district-sponsored Center for the Arts events. Funds generated from the cards help support student activities. The \$10 sticker fee per semester is nonrefundable. The initial card is free and renewed each semester.

## Attendance

**If you enroll in a class and you do not attend the first scheduled meeting of the class, you may be dropped from the roster and your place may be given to a waiting student.**

## Children in Classrooms

Children are not permitted in classrooms while class is in session. Attendance in class is limited to officially enrolled students and authorized visitors or guests only. In addition, students shall not allow children to be left unattended or unsupervised anywhere on campus. It is the responsibility of each faculty member to inform students of this requirement.

## Student Records

Congress has provided in the "Family Education Rights and Privacy Act" that students have certain rights of access to their education records. A copy of the Act is located in the Library. Please contact the Admissions Office for any information regarding your rights under the Act.

## Equivalent Courses

[www.elcamino.edu/admissions/catalog.asp](http://www.elcamino.edu/admissions/catalog.asp)

Courses completed at other colleges and universities may be used to meet a prerequisite. Some high school courses, as stated in the college catalog, may also be used to meet a prerequisite.

Students who have completed equivalent courses at another college or in high school must have copies of necessary transcripts. Do not delay. Order transcripts and clear prerequisites prior to registration. Clearance for an equivalent course may be obtained in the Counseling Department or the Academic Affairs Office (C-32) located in the Administration Building.

## Transcripts

If you plan to attend under veterans or Social Security benefits, receive academic advisement to become matriculated, or need to have coursework at other colleges reviewed for prerequisite clearance, you must request college transcripts from all schools you have attended be sent to the El Camino College Records Office.

If you plan to graduate from El Camino College with a degree or certificate and wish to have course work taken at other colleges considered for graduation, you must request official transcripts to be mailed from the other colleges to the El Camino College Records Office. Hand carried transcripts from the student or any other party will not be accepted.

Your first two El Camino College transcripts are free. Additional transcripts incur a fee as determined by college policy and payable at the time of the transcript request. Transcripts are processed on a first in, first out basis.



## Cross Enrollment at CSU Dominguez Hills

El Camino College Compton Center students who are eligible may cross-enroll at CSU Dominguez Hills without formal admission and without payment of state university tuition, in a maximum of one baccalaureate-level course per

semester on a space available basis. Such enrollment would be at the discretion of the appropriate campus authorities on each of the campuses.

A student must meet the requirements of cross enrollment to be eligible.

*Additional information on requirements and procedures may be obtained at the El Camino College Compton Center Admissions and Records Office or Counseling Department, located in the Administration Building.*



**Information about the following policies and services can be found online at:**

### Adds and Drops

[www.elcamino.edu/admissions](http://www.elcamino.edu/admissions)

### Audit of Courses

[www.elcamino.edu/admissions/credit.asp](http://www.elcamino.edu/admissions/credit.asp)

### Challenging a Prerequisite or Corequisite

[www.elcamino.edu/admissions/catalog.asp](http://www.elcamino.edu/admissions/catalog.asp)

### Non-resident Refund Policy

[www.elcamino.edu/admissions/fees.asp](http://www.elcamino.edu/admissions/fees.asp)

### Prerequisite and Corequisite Information

[www.elcamino.edu/admissions/catalog.asp](http://www.elcamino.edu/admissions/catalog.asp)

### Standards of Scholarship

[www.elcamino.edu/admissions/catalog.asp](http://www.elcamino.edu/admissions/catalog.asp)

### Assessment and Testing

<http://www.compton.edu/student-services/supportservices/assessmentcenter/Pages/default.aspx>

### CalWORKs/TANF/GAIN

<http://www.compton.edu/student-services/supportservices/CalWORKSTANFGAIN/Pages/default.aspx>

### Counseling

<http://www.compton.edu/student-services/supportservices/counseling/Pages/default.aspx>

### EOPS/CARE

<http://www.compton.edu/student-services/supportservices/eopscare/Pages/default.aspx>

### Library

<http://www.compton.edu/library/Pages/default.aspx>

### Job Placement/Career Center

<http://www.compton.edu/student-services/supportservices/jobplacementcareercenter/Pages/default.aspx>

### Matriculation

<http://www.compton.edu/student-services/supportservices/matriculation/Pages/default.aspx>

### Special Resource Center

<http://www.compton.edu/student-services/supportservices/specialresourcecenter/Pages/default.aspx>

### Student Support Services

<http://www.compton.edu/student-services/supportservices/trio/Pages/STUDENTSUPPORTSERVICESPROGRAM.aspx>

### Transcripts

[www.elcamino.edu/admissions/transcripts.asp](http://www.elcamino.edu/admissions/transcripts.asp)

### Transfer Center

<http://www.compton.edu/student-services/supportservices/transfercenter/Pages/default.aspx>



# El Camino College – Compton Center Financial Aid Office

## 2008-2009 Board of Governors Fee Waiver Application

This is an application to have your **ENROLLMENT FEES WAIVED**. This **FREE WAIVER** is for California residents only. If you need money to help with books, supplies, food, rent, transportation and other costs, please complete a **FREE APPLICATION FOR FEDERAL STUDENT AID (FAFSA)** immediately. Contact the Financial Aid Office for more information. The **FAFSA** is available at [www.fafsa.ed.gov](http://www.fafsa.ed.gov) or at the Financial Aid Office.

**Note:** Students who are exempt from paying nonresident tuition under **Education Code Section 68130.5 (AB 540)** are NOT California residents. If you are NOT a California resident, you are not eligible for a fee waiver. Do not complete this application. You may apply for financial aid by completing the FAFSA.

Name: \_\_\_\_\_ Student ID # \_\_\_\_\_  
Last First Middle Initial

Email (if available): \_\_\_\_\_ Telephone Number: (\_\_\_\_) \_\_\_\_\_

Home Address: \_\_\_\_\_ Date of Birth: \_\_\_\_/\_\_\_\_/\_\_\_\_  
Street City Zip Code

Has the Admissions or Registrar's Office determined that you are a California resident?  Yes  No

### IMPLEMENTATION OF THE CALIFORNIA DOMESTIC PARTNER RIGHTS AND RESPONSIBILITIES ACT

The California Domestic Partner Rights and Responsibilities Act extends new rights, benefits, responsibilities and obligations to individuals in domestic partnerships registered with the California Secretary of State under Section 297 of the Family Code. If **you** are in a Registered Domestic Partnership (RDP), you will be treated as an Independent married student to determine eligibility for this Enrollment Fee Waiver and will need to provide income and household information for your domestic partner. If you are a dependent student and your parent is in a Registered Domestic Partnership, you will be treated the same as a student with married parents and income and household information will be required for the parent's domestic partner.

**Note:** These provisions apply to state student financial aid ONLY, and not to federal student financial aid.

Are you or your parent in a Registered Domestic Partnership with the California Secretary of State under Section 297 of the Family Code? (Answer "Yes" if you or your parent are separated from a Registered Domestic Partner but have **NOT FILED** a Notice of Termination of Domestic Partnership with the California Secretary of State's Office.)  Yes  No

If you answered "Yes" to the question above treat the Registered Domestic Partner as a spouse. You are required to include your domestic partner's income and household information or your parent's domestic partner's income and household information in Questions 3, 6, 7, 8, 9, 10, 11, 12.

Student Marital Status:  Single  Married  Divorced  Separated  Widowed  Registered Domestic Partnership

### DEPENDENCY STATUS

- Were you born before January 1, 1985?  Yes  No
- As of today, are you married or in a Registered Domestic Partnership (RDP)? (Answer "Yes" if you are separated but not divorced or have not filed a termination notice to dissolve partnership.)  Yes  No
- Do you have children who receive more than half of their support from you, or other dependents who live with you (other than your children and spouse/RDP) who receive more than half of their support from you, now and through June 30, 2009?  Yes  No
- Are (a) both your parents deceased, or (b) are you (or were you until age 18) a ward/dependent of the court?  Yes  No
- Are you a veteran of the U.S. Armed Forces or currently serving on active duty for purposes other than training?  Yes  No

• If you answered "Yes" to any of the questions 1 - 5, you are considered an **INDEPENDENT** student for enrollment fee waiver purposes and must provide income and household information about yourself (and your spouse or RDP if applicable). Skip to Question #8.

• If you answered "No" to all questions 1 - 5, complete the following questions:

- If your parent(s) or his/her RDP filed or will file a 2007 U.S. Income Tax Return, were you, or will you be claimed on their tax return as an exemption by either or both of your parents?  Will Not File  Yes  No
- Do you live with one or both of your parent(s) and/or his/her RDP?  Yes  No

• If you answered "No" to questions 1 - 5 and "Yes" to either question 6 or 7, you must provide income and household information about your PARENT(S)/RDP. Please answer questions for a **DEPENDENT** student in the sections that follow.

• If you answered "No" or "Parent(s) will not file" to question 6, and "No" to question 7, you are a **dependent student for all student aid except this enrollment fee waiver**. You may answer questions as an **INDEPENDENT** student on the rest of this application, but please try to get your PARENT information and file a FAFSA so you may be considered for other student aid. You cannot get other student aid without your parent(s) information.

### METHOD A ENROLLMENT FEE WAIVER

- Are you (the student ONLY) currently receiving monthly cash assistance for yourself or any dependents from:  
TANF/CalWORKs?  Yes  No  
SSI/SSP (Supplemental Security Income/State Supplemental Program)?  Yes  No  
General Assistance?  Yes  No
- If you are a dependent student, are your parent(s)/RDP receiving monthly cash assistance from TANF/CalWORKs or SSI/SSP as a primary source of income?  Yes  No

• If you answered "Yes" to question 8 or 9 you are eligible for an **ENROLLMENT FEE WAIVER**. Sign the Certification at the end of this form. You are required to show current proof of benefits. Complete a FAFSA to be eligible for other financial aid opportunities.

**METHOD B ENROLLMENT FEE WAIVER** =====

- 10. **DEPENDENT STUDENT:** How many persons are in your parent(s)/RDP household? (Include yourself, your parent(s)/RDP, and anyone who lives with your parent(s)/RDP and receives more than 50% of their support from your parents/RDP, now and through June 30, 2009.) \_\_\_\_\_
- 11. **INDEPENDENT STUDENT:** How many persons are in your household? (Include yourself, your spouse/RDP, and anyone who lives with you and receives more than 50% of their support from you, now and through June 30, 2009.) \_\_\_\_\_
- 12. **2007 Income Information**

	DEPENDENT STUDENT: PARENT(S)/ RDP INCOME	INDEPENDENT STUDENT: STUDENT ( & SPOUSE'S/ RDP) INCOME
a. Adjusted Gross Income (If 2007 U.S. Income Tax Return was filed, enter the amount from Form 1040, line 37; 1040A, line 21; 1040EZ, line 4).	\$ _____	\$ _____
b. All other income (Include <b>ALL money</b> received in 2007 that is not included in line (a) above (such as TANF benefits, disability, Social Security, child support).	\$ _____	\$ _____
<b>TOTAL</b> Income for 2007 (Sum of a + b)	\$ _____	\$ _____

The Financial Aid Office will review your income and let you know if you qualify for an ENROLLMENT FEE WAIVER under Method B. If you do not qualify using this simple method, you should file a FAFSA.

**SPECIAL CLASSIFICATIONS ENROLLMENT FEE WAIVERS**

- 13. Do you have certification from the CA Department of Veterans Affairs that you are eligible for a dependent's fee waiver?  
*Submit certification.*  Yes  No
- 14. Do you have certification from the National Guard Adjutant General that you are eligible for a dependent's fee waiver?  
*Submit certification.*  Yes  No
- 15. Are you eligible as a recipient of the Congressional Medal of Honor or as a child of a recipient?  
*Submit documentation from the Department of Veterans Affairs.*  Yes  No
- 16. Are you eligible as a dependent of a victim of the September 11, 2001, terrorist attack?  
*Submit documentation from the CA Victim Compensation and Government Claims Board.*  Yes  No
- 17. Are you eligible as a dependent of a deceased law enforcement/fire suppression personnel killed in the line of duty?  
*Submit documentation from the public agency employer of record.*  Yes  No

• If you answered "Yes" to any of the questions from 13-17, you are eligible for an ENROLLMENT FEE WAIVER and perhaps other fee waivers or adjustments. Sign the Certification below. Contact the Financial Aid Office if you have questions.

**CERTIFICATION FOR ALL APPLICANTS: READ THIS STATEMENT AND SIGN BELOW**

I hereby swear or affirm, under penalty of perjury, that all information on this form is true and complete to the best of my knowledge. If asked by an authorized official, I agree to provide proof of this information, which may include a copy of my and my spouse/registered domestic partner and/or my parent's/registered domestic partner's 2007 U.S. Income Tax Return(s). I also realize that any false statement or failure to give proof when asked may be cause for the denial, reduction, withdrawal, and/or repayment of my waiver. I authorize release of information regarding this application between the college, the college district, and the Chancellor's Office of the California Community Colleges.

\_\_\_\_\_  
Applicant's Signature Date Parent Signature (Dependent Students Only) Date

**California Information Privacy Act**

State and federal laws protect an individual's right to privacy regarding information pertaining to oneself. The California Information Practices Act of 1977 requires the following information be provided to financial aid applicants who are asked to supply information about themselves. The principal purpose for requesting information on this form is to determine your eligibility for financial aid. The Chancellor's Office policy and the policy of the community college to which you are applying for aid authorize maintenance of this information. Failure to provide such information will delay and may even prevent your receipt of financial assistance. This form's information may be transmitted to other state agencies and the federal government if required by law. Individuals have the right of access to records established from information furnished on this form as it pertains to them.

The officials responsible for maintaining the information contained on this form are the financial aid administrators at the institutions to which you are applying for financial aid. The SSN may be used to verify your identity under record keeping systems established prior to January 1, 1975. If your college requires you to provide an SSN and you have questions, you should ask the financial aid officer at your college for further information. The Chancellor's Office and the California community colleges, in compliance with federal and state laws, do not discriminate on the basis of race, religion, color, national origin, gender, age, disability, medical condition, sexual orientation, domestic partnership or any other legally protected basis. Inquiries regarding these policies may be directed to the financial aid office of the college to which you are applying.

**FOR OFFICE USE ONLY**

<input type="checkbox"/> BOGFW-A <input type="checkbox"/> TANF/CalWORKs <input type="checkbox"/> SSI/SSP <input type="checkbox"/> GA	<input type="checkbox"/> BOGFW-B _____ <input type="checkbox"/> BOGFW-C	<input type="checkbox"/> Special Classification <input type="checkbox"/> Veteran <span style="margin-left: 20px;"><input type="checkbox"/> National Guard Dependent</span> <input type="checkbox"/> Medal of Honor <span style="margin-left: 20px;"><input type="checkbox"/> 9/11 Dependent</span> <input type="checkbox"/> Dep. of deceased law enforcement/fire personnel	RDP <input type="checkbox"/> Student <input type="checkbox"/> Parent	<input type="checkbox"/> Student is not eligible
---	---	--	--	--

Comments: \_\_\_\_\_

Certified by: \_\_\_\_\_ Date: \_\_\_\_\_





# El Camino College – Compton Center Financial Aid Office

## Solicitud para la Exención (fee waiver) del Pago de la Matrícula 2008-2009

Esta es una solicitud para recibir una exención de las cuotas de inscripción. Esta exención (fee waiver) es exclusivamente para residentes de California. Si necesitas ayuda económica para la compra de libros, útiles escolares, alimentos, pago de renta, transportación y otros gastos, por favor de llenar la SOLICITUD GRATUITA DE AYUDA FEDERAL PARA ESTUDIANTES (FAFSA por sus siglas en inglés). La FAFSA está disponible en la red [www.fafsa.ed.gov](http://www.fafsa.ed.gov) o en la Oficina de la Ayuda Económica. **Nota aclaratoria:** Los estudiantes que han sido exentos del pago de inscripción como no residentes de California, según la Cláusula 68130.5 (AB 540) del Código de Educación no se consideran residentes de California para efectos de esta solicitud. Si tú no eres residente de California, no eres elegible para ser exento del pago de inscripción, por lo tanto, no llenes este formulario. Usted puede aplicar para ayuda económica llenando la solicitud FAFSA.

Nombre: \_\_\_\_\_ Número de ID #/SSN \_\_\_\_\_  
Apellido Nombre Inicial del Segundo Nombre

Correo electrónico (opcional): \_\_\_\_\_ Número de Teléfono: (\_\_\_\_) \_\_\_\_\_

Domicilio: \_\_\_\_\_ Fecha de Nacimiento: \_\_\_\_/\_\_\_\_/\_\_\_\_  
Calle Ciudad Código Postal

¿Ha determinado la Oficina de Registros y Admisiones que es usted residente de California?  Sí  No

### IMPLEMENTACION DEL DECRETO DE CALIFORNIA SOBRE LOS DERECHOS Y RESPONSABILIDADES

El Acta de California sobre Derechos y Responsabilidades de Parejas Domésticas extiende nuevos derechos, beneficios, responsabilidades y obligaciones a las personas que forman parte de una Relación Doméstica Registrada con la Secretaría del Estado de California bajo la sección 297 del Código de Familia. Si tú estas registrado en una relación doméstica bajo *Registered Domestic Partnership* (RDP por sus siglas en inglés), entonces serás considerado como un estudiante independiente-casado, a fin de determinar la elegibilidad para esta exención de cuotas de inscripción. Debes proveer información sobre tu familia y de los ingresos de tu pareja doméstica. Si eres un estudiante dependiente y tu padre/madre está en una relación de RDP, serás considerado como un estudiante con padres casados, por lo cual también tienes que proveer el ingreso de la pareja doméstica de tu padre/madre.

**Nota aclaratoria:** Estas cláusulas se aplican sólo a los solicitantes de la ayuda económica estatal y por lo tanto, excluyen a toda ayuda económica federal.

¿Esta Usted (Ud) o su(s) padre/madre viviendo con una pareja registrada como RDP con la Secretaria del Estado de California bajo la cláusula 297 del Código de Familia? (Responde "sí" si su padre/madre están separados de una pareja RDP, SIN HABER PRESENTADO un aviso de Terminación [*Notice of Termination of Domestic Partnership*] en la Oficina de la Secretaria del Estado de California)?  Sí  No

Si respondiste "sí" a la pregunta anterior tiene que incluir a su pareja doméstica registrada como cónyuge. Debe de incluir la información familiar y el ingreso destu pareja, o de la pareja doméstica de su padre/madre en las preguntas 3, 6, 7, 8, 9, 10, 11, 12.

Estado Civil del Estudiante:  Soltero/a  Casado/a  Divorciado/a  Separado/a  Viudo/a  Pareja Doméstica Registrada (RDP)

### Estado de Dependencia =====

- ¿Nació antes del 1 de enero de 1985?  Sí  No
- En la actualidad, ¿está casado(a), o vive con una pareja de Relación Doméstica Registrada (RDP)? (Responde "sí" si estás separado pero no divorciado, o si no has presentado un aviso de terminación para disolver tu relación.)  Sí  No
- ¿Tiene hijos que reciben de Ud más de la mitad de tu manutención, o otros dependientes que viven con Ud (aparte de sus hijos y cónyuge) que reciban de Ud más de la mitad de tu manutención, ahora mismo y hasta el 30 de junio del 2009?  Sí  No
- ¿Es Ud huérfano, o está bajo la tutela legal o **estuvo** bajo la tutela legal hasta la edad de los 18 años?  Sí  No
- ¿Es veterano de las Fuerzas Armadas de los Estados Unidos?  Sí  No

• Si respondió "sí" a cualquiera de las preguntas del 1 al 5, es considerado estudiante INDEPENDIENTE y deberá proporcionar su información familiar y de ingreso de su cónyuge o RDP, si es aplicable. Pasa a la pregunta #8.

• Si respondió "no" a todas las preguntas del 1 al 5, llene las siguientes preguntas:

- Si su/s padre/s o su RDP presentaron o van a presentar una Declaración de Impuestos del año 2007, ¿fue o será considerado como dependiente de alguno o ambos padres?  No presentarán Declaración de Impuestos  Sí  No
- ¿Vive con alguno o ambos padres, y/o su RDP?  Sí  No

• Si respondió "no" a las preguntas 1 a 5 y "sí" a la pregunta 6 ó 7, deberás proporcionar la información familiar y los ingresos de su/s padre/s o RDP. Llene las preguntas para estudiantes DEPENDIENTES en las secciones que sigue.

• Si respondió "no" o "su/s padre/s no presentarán" en la pregunta 6 y "no" a la pregunta 7, es Ud un estudiante dependiente para toda la ayuda estudiantil, a excepción de esta solicitud de exención de las cuotas de inscripción. Llena las preguntas que siguen como estudiante INDEPENDIENTE, pero intenta obtener la información de su/s padre/s y presente la solicitud FAFSA para que sea considerado para otro tipo de ayuda económica. No puedes recibir otra ayuda económica sin la información de su/s padre/s.

### METODO A =====

- Actualmente, ¿está recibiendo (sólo el estudiante) mensualmente ayuda monetaria de: TANF/CalWORKs?  Sí  No  
SSI/SSP ¿(Programa de Ingreso Suplementario de Seguridad)?  Sí  No  
¿Asistencia General?  Sí  No

9. Si es estudiante dependiente, ¿están su/s padre/s o RDP recibiendo ayuda monetaria de: TANF/CalWorks, SSI/SSP como fuente principal de sus ingresos?  Sí  No

**Si respondiste "sí" a la pregunta 8 ó 9, eres elegible para una Exención de Cuotas de Inscripción. Firma la certificación al final de este formulario. Se te requerirá mostrar comprobación reciente de beneficios. Solicita a la Oficina de Ayuda Económica una FAFSA para ser elegible para otras oportunidades de ayuda económica.**

**METODO B** =====

10. **Estudiante Dependiente:** ¿Cuántas personas hay en la familia de Ud/sus padre/s? (incluyéndolo a Ud, sus padre/s y cualquier otra persona que viva con Ud/sus padres o RDP y reciba más del 50% de su manutención, ahora mismo y hasta el 30 de junio del 2009.) \_\_\_\_\_

11. **Estudiante Independiente:** ¿Cuántas personas hay en su familia? (incluyéndolo a Ud, su cónyuge/RDP y cualquier otra persona que viva con usted y reciba más del 50% de su manutención, ahora mismo y hasta el 30 de junio del 2009.) \_\_\_\_\_

12. **Información sobre los Ingresos del 2007**

	Estudiante Dependiente: Ingreso del Padre/s o RDP	Estudiante Independiente: Ingreso del Estudiante, cónyuge o RDP
a. Ingreso Bruto Ajustado (Si se presentó la Declaración de Impuestos del 2007, escribe la cantidad del formulario 1040, línea 37; 1040A, línea 21; 1040EZ, línea 4).	\$ _____	\$ _____
b. Todo otro ingreso (Incluye <b>todo el dinero</b> recibido en el 2007 que no está incluido en la líneas de arriba (i.e. beneficios de discapacidad, Seguro Social, pensión alimenticia).	\$ _____	\$ _____
<b>TOTAL</b> de ingresos para el 2007 (Suma de a + b)	\$ _____	\$ _____

**La Oficina de Ayuda Económica revisará sus ingresos y le notificará si es elegible para la Exención de Cuotas de Inscripción bajo el Método B. Si no es elegible usando este método sencillo, le recomendamos que llenes la FAFSA.**

**CLASIFICACIONES ESPECIALES PARA SER EXENTO DEL PAGO DE INSCRIPCION**

13. ¿Tiene una Certificación del Departamento de California de Asuntos para Veteranos que establezca que eres un dependiente elegible para esta exención? *Entrega comprobación.*  Sí  No

14. ¿Tiene una Certificación de la Guardia Nacional General que establezca que eres un dependiente elegible para esta exención? *Entrega comprobación.*  Sí  No

15. ¿Es elegible, como beneficiario de la Medalla de Honor del Congreso o como hijo de alguien quien la recibió? *Entrega constancia del Departamento de Asuntos para Veteranos.*  Sí  No

16. ¿Es elegible como dependiente de una víctima de los atentados terroristas del 11 de septiembre del 2001? *Entrega documentación del CA Victim Compensation and del Government Claims Board.*  Sí  No

17. Es elegible como dependiente de algún agente del orden/personal de control de incendios, muerto en el cumplimiento de su deber? *Entrega documentación de la Agencia pública que haya sido el empleador*  Sí  No

• **Si respondió "sí" a cualquiera de las preguntas de 13 a 17, es elegible para ser exento del pago de Cuotas de Inscripción y tal vez otro tipo de reducción de cuotas. Firme la certificación de abajo. Si tiene preguntas, ponte en contacto con la Oficina de Ayuda Económica.**

**CERTIFICACION PARA TODOS LOS SOLICITANTES: LEE ESTA DECLARACION Y FIRMA ABAJO**

Por medio de la presente juro o afirmo, bajo pena de perjurio, que toda la información en este formulario es verdadera y completa según mi conocimiento. Si personal autorizado me lo pide consentimiento a ofrecer pruebas relacionadas con esta información, las cuales podría incluir una copia de mi Declaración de Impuestos del 2007, la de mi cónyuge y/o la pareja doméstica registrada de mi padre/madre. También reconozco que cualquier declaración falsa, o el incumplimiento en la presentación de pruebas cuando me sean solicitadas podrían ser causa de negación, reducción o retiro y/o devolución de mi exención de cuotas de inscripción. Autorizo el intercambio de información relacionada con esta solicitud entre el colegio, el distrito del colegio y la Oficina del Rector de los Colegios Comunitarios de California.

Firma del solicitante \_\_\_\_\_ Fecha \_\_\_\_\_ Firma del padre (Sólo para Estudiantes Dependientes) \_\_\_\_\_ Fecha \_\_\_\_\_

**Acta de California de Información y Privacidad**

Las leyes federales y estatales protegen el derecho del individuo a la privacidad con respecto a su información personal. El Acta de 1977 de California sobre Prácticas de Información (*California Information Practices Act 1977*) requiere que la siguiente información sea entregada a todos los solicitantes de la ayuda económica de quienes se les ha pedido proveer su información personal. La información que proporcione en este formulario se usará para determinar si usted tiene el derecho a recibir la ayuda económica. La política de la Oficina del Rector de los Colegios Comunitarios (*Chancellor's Office*) y la política del colegio comunitario a quien ha solicitado la ayuda económica autoriza el uso de esta información. La omisión de dicha información demoraría y hasta podría prevenirle de recibir la ayuda económica. La información en este formulario podría ser cedida a otros organismos estatales y al gobierno federal, si es requerido por ley. Los individuos tienen el derecho a acceder su historial personal establecido en base a su información personal proveída. La autoridad responsable de mantener la información incluida en este formulario son los administradores de la ayuda financiera de la institución a la cual está solicitando la ayuda económica. El número de Seguro Social podría ser utilizado para verificar su identidad bajo el sistema de registros establecido antes del 1ro de enero de 1975. Si su colegio comunitario le pide que proporcione su número de Seguro Social y tiene alguna pregunta, pida más información al administrador de la oficina de Ayuda Financiera de su colegio. La Oficina del Rector y los Colegios Comunitarios, de acuerdo con las leyes federales y estatales, no discrimina en base a raza, religión, color, nacionalidad, sexo, edad, incapacidad, condición médica, orientación sexual, relación doméstica registrada, o cualquier otra condición amparada legalmente. Cualquier pregunta sobre estas políticas podrá ser dirigida a la Oficina de Ayuda Financiera del colegio al cual esté solicitando.

**FOR OFFICE USE ONLY**

<input type="checkbox"/> BOGFW-A <input type="checkbox"/> TANF/CalWORKs <input type="checkbox"/> SSI/SSP <input type="checkbox"/> GA	<input type="checkbox"/> BOGFW-B <input type="checkbox"/> BOGFW-C	<input type="checkbox"/> Special Classification <input type="checkbox"/> Veteran <input type="checkbox"/> Medal of Honor <input type="checkbox"/> Dep. of deceased law enforcement/fire personnel	<input type="checkbox"/> National Guard Dependent <input type="checkbox"/> 9/11 Dependent	RDP <input type="checkbox"/> Student <input type="checkbox"/> Parent	<input type="checkbox"/> Student is not eligible
---	--	--	--	--	--

Certified by: \_\_\_\_\_ Date: \_\_\_\_\_

**2008-2009 BOARD OF GOVERNOR’S FEE WAIVER INFORMATION**

<b>PROGRAM BENEFITS</b>	<b>FILING DEADLINES</b>	<b>OTHER INFORMATION</b>
Enrollment Fees Waived	Fall 2008 (8/23/08-12/12/08)	Parent Signature for Dependent Student Method A Documentation Required Processed FAFSA with an EFC
Reduced Parking Fees	Winter 2009 (1/07/09-2/10/09)	
Method A—Health Fees Waived *	Spring 2009 (2/14/09-6/12/09)	
One Application For All 4 Terms	Summer 2009 (6/15/09-8/13/09)	

**Method-C (Apply for Federal Pell Grant, Fee Waiver & Other Aid)**

Complete the Free Application for Federal Student Aid (FAFSA) online at [www.fafsa.ed.gov](http://www.fafsa.ed.gov). Check with your campus Financial Office for available FAFSA Workshops.

- Waive Enrollment Fees
- Determine Federal Pell Grant Maximum Eligibility, Federal Work-Study and Federal Loan Eligibility

Enrollment Status	Units Required	Pell Max. Eligibility
Full Time	12 or more	\$ 4,731 per year
Three-Quarter Time	9-11 units	\$ 3,548 per year
Half-Time	6-8 units	\$ 2,366 per year
Less Than Half-Time	Less than 6 units	\$ 910 per year

**Method-A (Apply for Board of Governors Fee Waiver Only)**

\* Except for Dependent of National Guard

<p>You or your family must receive benefits from one of the following:</p> <ul style="list-style-type: none"> <li>• CalWORKS (AFDC) or Temporary Assistance for Needy Families (TANF)</li> <li>• Supplemental Security Income (SSI) or State Supplementary Program (SSP)</li> <li>• General Assistance (GA)</li> </ul>	<p>Submit one of the following documents:</p> <ul style="list-style-type: none"> <li>• Copy of a <u>current or last</u> month’s check for Cal WORKs SSI, SSP, or GA benefits. Current or last month’s bank statement with direct deposit of SSI benefit is acceptable documentation. Please submit a <b>PHOTOCOPY</b> of your benefit check or bank statement.</li> <li>• Agency Certification Form, verifying eligibility, with an authorized signature, agency stamp, and <u>current date</u></li> </ul>
--	--

**Method-B (Apply for Board of Governors Fee Waiver Only)**

<p>You must meet the following qualifying income standards:</p> <table style="width: 100%; border-collapse: collapse;"> <thead> <tr> <th style="text-align: left;">Number in Household</th> <th style="text-align: left;">Total Income in 2007</th> </tr> </thead> <tbody> <tr><td>1</td><td>\$ 15,315.00</td></tr> <tr><td>2</td><td>\$ 20,535.00</td></tr> <tr><td>3</td><td>\$ 25,755.00</td></tr> <tr><td>4</td><td>\$ 30,975.00</td></tr> <tr><td>5</td><td>\$ 36,195.00</td></tr> <tr><td>6</td><td>\$ 41,415.00</td></tr> <tr><td>7</td><td>\$ 46,635.00</td></tr> <tr><td>8</td><td>\$ 51,855.00</td></tr> </tbody> </table>	Number in Household	Total Income in 2007	1	\$ 15,315.00	2	\$ 20,535.00	3	\$ 25,755.00	4	\$ 30,975.00	5	\$ 36,195.00	6	\$ 41,415.00	7	\$ 46,635.00	8	\$ 51,855.00	<p>You must meet the following qualifying income standards:</p> <table style="width: 100%; border-collapse: collapse;"> <thead> <tr> <th style="text-align: left;">Number in Household</th> <th style="text-align: left;">Total Income in 2007</th> </tr> </thead> <tbody> <tr><td>9</td><td>\$ 57,075.00</td></tr> <tr><td>10</td><td>\$ 62,295.00</td></tr> <tr><td>11</td><td>\$ 67,515.00</td></tr> <tr><td>12</td><td>\$ 72,735.00</td></tr> <tr><td>13</td><td>\$ 77,955.00</td></tr> <tr><td>14</td><td>\$ 83,175.00</td></tr> <tr><td>15</td><td>\$ 88,395.00</td></tr> <tr><td>16</td><td>\$ 93,615.00</td></tr> </tbody> </table>	Number in Household	Total Income in 2007	9	\$ 57,075.00	10	\$ 62,295.00	11	\$ 67,515.00	12	\$ 72,735.00	13	\$ 77,955.00	14	\$ 83,175.00	15	\$ 88,395.00	16	\$ 93,615.00
Number in Household	Total Income in 2007																																				
1	\$ 15,315.00																																				
2	\$ 20,535.00																																				
3	\$ 25,755.00																																				
4	\$ 30,975.00																																				
5	\$ 36,195.00																																				
6	\$ 41,415.00																																				
7	\$ 46,635.00																																				
8	\$ 51,855.00																																				
Number in Household	Total Income in 2007																																				
9	\$ 57,075.00																																				
10	\$ 62,295.00																																				
11	\$ 67,515.00																																				
12	\$ 72,735.00																																				
13	\$ 77,955.00																																				
14	\$ 83,175.00																																				
15	\$ 88,395.00																																				
16	\$ 93,615.00																																				



## 2008-2009 SOLICITUD PARA EXONERACION DE MATRICULA DE ESTUDIOS COMUNITARIOS DE CALIFORNIA

PROGRAM BENEFITS	FILING DEADLINES	Información Adicional
Costos de Matricula Deferidos	Otoño 2008 (23/8/08 – 12/12/08)	Firma de Padre para Estudiante Dependiente
Costos de Estacionamiento Reducidos	Invierno 2009 (7/1/09 – 10/2/09)	Método A requiere documentación
Método A – Cargo de Salud Deferidos *	Primavera 2009 (14/2/09 – 12/6/09)	FAFSA Procesada
Una Aplicación para 4 Semestres	Verano 2009 (15/6/09 – 13/8/09)	

### Método - C (Aplica para Beca Federal Pell, Solicitud para Exoneración de Matricula y otra asistencia financiera)

Llena la Solicitud Gratuita de Ayuda Federal para Estudiantes (FAFSA) a través de Internet en [www.fafsa.ed.gov](http://www.fafsa.ed.gov) . Consulte con la Oficina de Ayuda Financiera de su campus para talleres de FAFSA disponibles para asistencia en llenar la solicitud.

- Defiere Costos de Inscripción
- Determiné elegibilidad máxima para Beca Federal Pell, Programa Federal de Estudio y Trabajo y elegibilidad para Programa de Préstamo Federal

Tiempo de Inscripción	Unidades Requeridos	Elegibilidad Máxima Beca Pell
Tiempo Completo	12 o mas	\$ 4,731 total por año
Tres-Cuartos de Tiempo	9-11 unidades	\$ 3,548 total por año
Medio-Tiempo	6-8 unidades	\$ 2,366 total por año
Menos de Medio-Tiempo	Menos de 6 unidades	\$ 910 total por año

### Metodo – A

(Aplica para Exoneración de Matricula de Estudios Comunitarios de California solamente)

\* Excepto los dependientes de la Guardia Nacional

<p>Tu o tu familia recibe uno de los beneficios de los siguientes:</p> <ul style="list-style-type: none"> <li>● CalWORKS (AFDC) o Temporary Assistance for Needy Families (TANF)</li> <li>● Supplemental Security Income (SSI) o State Supplementary Program (SSP)</li> <li>● General Assistance (GA)</li> </ul>	<p>Somete uno de los siguientes documentos:</p> <ul style="list-style-type: none"> <li>● Una copia de una comprobación para el mes actual o pasado de Cal WORKS SSI, SSP, o de GA. El extracto de cuenta del mes actual o pasado con el deposito directo de SSI es documentación aceptable. Por favor somete una FOTOCOPIA de tu extracto del cheque o de cuenta bancaria.</li> <li>● Formulario de <i>Agency Certification</i> verificando elegibilidad con firma autorizada, estampilla de agencia y fecha actual.</li> </ul>
--	---

### Método – B (Aplica para Exoneración de Matricula de Estudios Comunitarios de California solamente)

Debe de calificar usando los siguientes estándares:

Numero en Hogar	Ingresos Total en 2007
1	\$ 15,315.00
2	\$ 20,535.00
3	\$ 25,755.00
4	\$ 30,975.00
5	\$ 36,195.00
6	\$ 41,415.00
7	\$ 46,635.00
8	\$ 51,855.00

Debe de calificar usando los siguientes estándares:

Numero en Hogar	Ingresos Total en 2007
9	\$ 57,075.00
10	\$ 62,295.00
11	\$ 67,515.00
12	\$ 72,735.00
13	\$ 77,955.00
14	\$ 83,175.00
15	\$ 88,395.00
16	\$ 93,615.00

## Art

(Division of Fine Arts 310-900-1600 ext 2210)

### Art 1 - 3 Units

*Art in Modern Life*

Recommended Preparation: eligibility for English 1A

9500 10:30-12:31pm MTWThF Lecture . . . . . Staff . . . . . E 32  
Section 9500 meets for 5 weeks from: January 7 to February 10, 2009.

## Astronomy

(Division of Natural Sciences 310-900-1600 ext 2332)

### Astronomy 20 - 3 Units

*The Solar System*

Recommended Preparation: eligibility for English 84

Note: Formerly Astronomy 9

#### Evening Hours

9108 4:30-6:55pm MTWTh Lecture . . . . . W. Keig . . . . . MS 126  
Section 9108 meets for 5 weeks from: January 7 to February 10, 2009.

## Biology

(Division of Natural Sciences 310-900-1600 ext 2332)

### Biology 10 - 4 Units

*Fundamentals of Biology*

Recommended Preparation: English 84

9104 10:30-12:31pm MTWThF Lecture . . . . . A. Osanyinpeju . . . . . MS 108  
12:45-3:10pm MTWTh Lab . . . . . A. Osanyinpeju . . . . . MS 108  
Section 9104 meets for 5 weeks from: January 7 to February 10, 2009.

#### Evening Hours

9105 5:00-7:25pm MTWTh Lecture . . . . . E. Wallano . . . . . MS 108  
7:30-9:55pm MTWTh Lab . . . . . E. Wallano . . . . . MS 108  
Section 9105 meets for 5 weeks from: January 7 to February 10, 2009.

### Biology 15 - 3 Units

*Environmental Aspects of Biology*

Recommended Preparation: eligibility for English 84

9100 8:00-10:01am MTWThF Lecture . . . . . E. Boatwright . . . . . MS 103  
Section 9100 meets for 5 weeks from: January 7 to February 10, 2009.

## Chemistry

(Division of Natural Sciences 310-900-1600 ext 2332)

### Chemistry 20 - 5 Units

*Fundamentals of Chemistry*

Prerequisite: Mathematics 40 or 41B with a minimum grade of C in prerequisite or qualification by testing (El Camino College Mathematics Placement Test) and assessment

Recommended Preparation: eligibility for English 84

Note: Credit will not be given to a student who has completed Chemistry 1A

9120 8:00-10:35am MTWThF Lecture . . . . . A. Adeva . . . . . MS 231  
10:40-1:05pm MTWTh Lab . . . . . A. Adeva . . . . . MS 231  
Section 9120 meets for 5 weeks from: January 7 to February 10, 2009.

## Childhood Education

(Division of Behavioral & Social Sciences 310-900-1600 ext 2700)

### Child Development 3 - 3 Units

*Child Development*

Recommended Preparation: eligibility for English 1A

#### Evening Hours

9211 6:00-8:25pm MTWTh Lecture . . . . . Staff . . . . . E 10  
Section 9211 meets for 5 weeks from: January 7 to February 10, 2009.

### Child Development 9 - 3 Units

*The Home, the School, the Community*

Recommended Preparation: eligibility for English 1A

9214 10:30-12:51pm MTWThF Lecture . . . . . H. Hathman . . . . . E 19  
Section 9214 meets for 5 weeks from: January 7 to February 10, 2009.

## Contemporary Health

(Division of Health Sciences & Athletics 310-900-1600 ext 2620)

### Contemporary Health 1 - 3 Units

*Personal and Community Health Issues*

Recommended Preparation: eligibility for English A or 84

9804 8:00-10:01am MTWThF Lecture . . . . . L. Mendoza . . . . . V 70  
Section 9804 meets for 5 weeks from: January 7 to February 10, 2009.

## Distance Education

### See Distance Education Website

<http://www.Compton.edu/Academics/DistanceEducation>

(310-900-1600 ext 2784 or 310-660-6453)

Distance Education courses are offered online, by television, and/or videotape (Telecourses). Online students must have at a minimum: regular access to the Internet and a computer (either a PC with Windows and a Pentium processor or a Macintosh with at least system 9.0), a recent version of a web browser such as Netscape Navigator or Microsoft Explorer, an Internet Service Provider, an email address, and current word processing software as required by the instructor. Some courses may have additional requirements. Computer literacy and experience with computer communication is recommended. Students may use campus computer labs for work in online courses.

Many instructors hold a first class meeting on campus. Students who do not attend the meeting may be dropped by the instructor. Additional on campus meetings may be required. For more information, see the Student Handbooks on our website or contact our office.

## Economics

(Division of Behavioral & Social Sciences 310-900-1600 ext 2210)

### Economics 2 - 3 Units (CAN ECON 4)

*Principles of Economics: Microeconomics Theory*

Prerequisite: Economics 1 with a minimum grade of C

9221 8:00-10:01am MTWThF Lecture . . . . . Staff . . . . . D 34  
Section 9221 meets for 5 weeks from: January 7 to February 10, 2009.

## Distance Education

[www.Compton.edu/Academics/DistanceEducation](http://www.Compton.edu/Academics/DistanceEducation)

Distance Education courses are ideal for those who are looking for a convenient way to take courses. The course content, course credit, and cost per unit is the same as equivalent courses offered on campus. Anyone who is eligible to take courses on campus may enroll in Distance Education courses.

It is strongly recommended that students review the Distance Education Web site at : [www.Compton.edu/Academics/DistanceEducation](http://www.Compton.edu/Academics/DistanceEducation) for additional information regarding requirements, procedures, and other program material. A short assessment is available on the Web site designed to help students determine if they are ready to successfully take college level courses at a distance.

## English

### (Division of Humanities 310-900-1600 ext 2235)

Note: Students must take the English Placement Test to help with the assessment of appropriate skill levels before enrolling in English 80, 82, 84, B, A, 1A, or 72. A student seeking further review of a placement recommendation may obtain appropriate forms through the Counseling Office. Students who earned a 'C' or better in a prerequisite course at another college are not required to take the English Placement Test. These students must present a grade slip or transcript at registration to verify that the prerequisite has been satisfied at another institution. SAT scores may be substituted for the English Placement Test scores. Students should see their counselors for further information.

#### English 80 - 3 Units

##### Basic Language Skills

Recommended Preparation: qualification by testing (English Placement Test) and assessment  
Note: formerly English RA

9600	10:30-12:25pm MTWThF Lecture	E. Craigg	D 34
	12:25-1:05pm MTWThF Lab	E. Craigg	VT 209

Section 9600 meets for 5 weeks from: January 7 to February 10, 2009.

#### English 82 - 3 Units

##### Introduction to Reading Skills

Prerequisite: credit in English 80 or qualification by testing (English Placement Test) and assessment  
Note: formerly English R

9602	7:45-9:40am MTWThF Lecture	P. McLaughlin	D 33
	9:40-10:20am MTWThF Lab	P. McLaughlin	VT 209

Section 9602 meets for 5 weeks from: January 7 to February 10, 2009.

##### Evening Hours

9604	6:00-8:25pm MTWTh Lecture	Staff	D 34
	8:25-9:10pm MTWTh Lab	Staff	VT 209

Section 9604 meets for 5 weeks from: January 7 to February 10, 2009.

#### English 84 - 3 Units

##### Developmental Reading and Writing

Prerequisite: credit in English 82 or qualification by testing (English Placement Test) and assessment  
Note: formerly English 2R

9612	10:30-12:25pm MTWThF Lecture	Staff	D 33
	12:25-1:05pm MTWThF Lab	Staff	VT 209

Section 9612 meets for 5 weeks from: January 7 to February 10, 2009.

##### Evening Hours

9614	6:00-8:25pm MTWTh Lecture	Staff	E 32
	8:25-9:10pm MTWTh Lab	Staff	VT 209

Section 9614 meets for 5 weeks from: January 7 to February 10, 2009.

#### English C - 3 Units

##### Basic English Skills

Recommended Preparation: qualification by testing (English Placement Test) and assessment

9620	10:30-11:45am MTWThF Lecture	J. Quinones	D 40
	11:50-1:05pm MTWThF Lab	J. Quinones	D 40

Section 9620 meets for 5 weeks from: January 7 to February 10, 2009.

#### English B - 3 Units

##### Introduction to the Composing Process

Recommended Preparation: qualification by testing (English Placement Test) and assessment

9625	10:30-11:45am MTWThF Lecture	R. Roach	E 34
	11:50-1:05pm MTWThF Lab	R. Roach	E 34

Section 9625 meets for 5 weeks from: January 7 to February 10, 2009.

#### English A - 3 Units

##### Writing the College Essay

Prerequisite: Credit in English B or qualification by testing (English Placement Test) and assessment

9641	7:45-9:00am MTWThF Lecture	R. Roach	E 34
	9:05-10:20am MTWThF Lab	R. Roach	E 34

Section 9641 meets for 5 weeks from: January 7 to February 10, 2009.

##### Evening Hours

9643	5:00-6:30pm MTWTh Lecture	Staff	F 25
	6:40-8:10pm MTWTh Lab	Staff	F 25

Section 9643 meets for 5 weeks from: January 7 to February 10, 2009.

#### English 1A - 4 Units (CAN ENGL 2)

##### Reading and Composition

Prerequisite: Credit in English A and credit in English 84 or English 7; or qualification by testing (English Placement Test) and assessment

9646	7:45-10:20am MTWThF Lecture	E. Craigg	D 40
------	-----------------------------	-----------	------

Section 9646 meets for 5 weeks from: January 7 to February 10, 2009.

##### Evening Hours

9647	5:30-8:50pm MTWTh Lecture	Staff	C 39
------	---------------------------	-------	------

Section 9647 meets for 5 weeks from: January 7 to February 10, 2009.

#### English 1B - 3 Units (CAN ENGL 4)

##### Literature and Composition

Prerequisite: English 1A with a minimum grade of C

9664	8:00-10:01am MTWThF Lecture	T. Wasserberger	E 32
------	-----------------------------	-----------------	------

Section 9664 meets for 5 weeks from: January 7 to February 10, 2009.

##### Evening Hours

9662	5:30-7:55pm MTWTh Lecture	T. Wasserberger	D 33
------	---------------------------	-----------------	------

Section 9662 meets for 5 weeks from: January 7 to February 10, 2009.

#### English 1C - 3 Units

##### Critical Thinking and Composition

Prerequisite: English 1A with a minimum grade of C

Note: This course satisfies the critical thinking/English composition requirement of IGETC and the critical thinking requirement of the CSU transfer pattern.

9673	6:00-8:25pm MTWTh Lecture	T. Norton	D 40
------	---------------------------	-----------	------

Section 9673 meets for 5 weeks from: January 7 to February 10, 2009.

## English as a Second Language

### (Division of Humanities 310-900-1600 ext 2235)

Note: Students must take the ESL Placement Test to help with the assessment of appropriate skill levels before enrolling in ESL classes. A student seeking review of a placement recommendation may obtain appropriate forms through the Counseling Office. ESL classes taken at another college cannot be used for placement in the ESL program.

#### English as a Second Language 02A - 0 Units

##### Conversation and Grammar Level I

Recommended Preparation: concurrent enrollment in English as a Second Language 03A

9681	8:00-11:20am MTWThF Lecture	A. Cortez-Perez	F 25
------	-----------------------------	-----------------	------

Section 9681 meets for 5 weeks from: January 7 to February 10, 2009.

#### English as a Second Language 02B - 0 Units

##### Conversation and Grammar Level II

Recommended Preparation: qualification by assessment or completion of English as a Second Language 02A; concurrent enrollment in English as a Second Language 03B

9684	5:00-9:15pm MTWTh Lecture	Staff	F 25
------	---------------------------	-------	------

Section 9684 meets for 5 weeks from: January 7 to February 10, 2009.

#### English as a Second Language 02C - 0 Units

##### Conversation and Grammar Level III

Recommended Preparation: qualification by assessment or completion of English as a Second Language 02A and 02B; concurrent enrollment in English as a Second Language 03C

9686	5:00-9:15pm MTWTh Lecture	Staff	F 25
------	---------------------------	-------	------

Section 9686 meets for 5 weeks from: January 7 to February 10, 2009.





## Geology

(Division of Natural Sciences 310-900-1600 ext 2232)

### Geology 1 - 3 Units (CAN GEOL 6)

#### Physical Geology

Recommended Preparation: eligibility for English 84  
 Note: Four units of laboratory science credit will be granted with concurrent or subsequent enrollment in a geology laboratory course.

9130 8:00-10:01am MTWThF Lecture . . . . . L. Clark . . . . . MS 129  
 Section 9130 meets for 5 weeks from: January 7 to February 10, 2009.

#### Evening Hours

9132 5:00-7:25pm MTWTh Lecture . . . . . M. Okbamichael . . . . . MS 129  
 Section 9132 meets for 5 weeks from: January 7 to February 10, 2009.

### Geology 3 - 1 Unit

#### Physical Geology Laboratory

Prerequisite: Geology 1 with a minimum grade of C or concurrent enrollment

9134 10:30-12:31pm MTWThF Lab . . . . . L. Clark . . . . . MS 129  
 Section 9134 meets for 5 weeks from: January 7 to February 10, 2009.

#### Evening Hours

9136 7:30-9:55pm MTWTh Lab . . . . . M. Okbamichael . . . . . MS 129  
 Section 9136 meets for 5 weeks from: January 7 to February 10, 2009.

## Health

(See Contemporary Health)

## History

(Division of Behavioral & Social Sciences 310-900-1600 ext 2210)

### History 1A - 3 Units (CAN HIST 8)

#### United States History to 1877

Recommended Preparation: eligibility for English 1A

9224 10:30-12:31pm MTWThF Lecture . . . . . Staff . . . . . VT 214A  
 Section 9224 meets for 5 weeks from: January 7 to February 10, 2009.

### History 1B - 3 Units (CAN HIST 10)

#### United States History from 1877 to the Present

Recommended Preparation: eligibility for English 1A

Note: History 1A is not a prerequisite.

#### Evening Hours

9226 6:00-8:01pm MTWThF Lecture . . . . . Staff . . . . . VT 214A  
 Section 9226 meets for 5 weeks from: January 7 to February 10, 2009.

## Human Development

(Division of Behavioral & Social Sciences 310-900-1600 ext 2023)

### Human Development 5 - 1 Unit

#### Career Planning

Recommended Preparation: English 84 or ESL 52C and English A or English A-X

9240 1:30-3:00pm TTh Lecture . . . . . Staff . . . . . C 39  
 Section 9240 meets for 5 weeks from: January 8 to February 10, 2009.

### Human Development 8 - 1 Unit

#### Orientation to College and Educational Planning

8:00-9:30am MW Lecture . . . . . Staff . . . . . C 39

Section 9241 meets for 5 weeks from: January 7 to February 9, 2009.

9242 10:30-12:00pm MW Lecture . . . . . Staff . . . . . C 39  
 Section 9242 meets for 5 weeks from: January 7 to February 9, 2009.

## Law

(Division of Business 310-900-1600 ext 2271)

### Law 4 - 4 Units (CAN BUS 12)

#### Legal Environment of Business

Recommended Preparation: English 84

9376 See Distance Education Website . . . . . M. Ahmad . . . . . ONLINE  
 Section 9376 is a Distance Education online course. You must attend the first class meeting on Wednesday, January 7 from 10:00 a.m. to 12:00 p.m. and 5:00 p.m. to 7:00 p.m., in VT 125 or you may be dropped from the course. Before the session begins, you must obtain the Student Handbook for Online courses available in the Distance Education Office or on the Distance Education Website. Section 9376 meets for 5 weeks from: January 7 to February 10, 2009.

## Mathematics

(Division of Mathematical Sciences 310-900-1600 ext 2332)

The El Camino College Mathematics Placement Test and assessment is to be used for initial placement only. Once a student has enrolled in a mathematics course at El Camino, the Mathematics Placement Test cannot be used to skip courses.

### Mathematics 10A - 2 Units

#### Basic Arithmetic Skills, Part I

Note: Students enrolled in this course are required to participate in individual and group activities.

9902 8:00-9:15am MTWThF Lecture . . . . . Staff . . . . . MS 208  
 Section 9902 meets for 5 weeks from: January 7 to February 10, 2009.

#### Evening Hours

9903 4:30-6:00pm MTWTh Lecture . . . . . R. Webb . . . . . MS 208  
 Section 9903 meets for 5 weeks from: January 7 to February 10, 2009.

### Mathematics 10B - 2 Units

#### Basic Arithmetic Skills, Part II

Prerequisite: Mathematics 10A with a minimum grade of C

Note: Students enrolled in this course are required to participate in individual and group activities.

9904 10:30-11:45am MTWThF Lecture . . . . . Staff . . . . . MS 208  
 Section 9904 meets for 5 weeks from: January 7 to February 10, 2009.

#### Evening Hours

9905 6:00-7:30pm MTWTh Lecture . . . . . R. Webb . . . . . MS 208  
 Section 9905 meets for 5 weeks from: January 7 to February 10, 2009.

### Mathematics 25 - 2 Units

#### Pre-Algebra Review

Prerequisite: Mathematics 10B or Mathematics 12 with a minimum grade of C in prerequisite or qualification by testing (El Camino College Mathematics Placement Test) and assessment

9910 9:15-10:30am MTWThF Lecture . . . . . Staff . . . . . MS 208  
 Section 9910 meets for 5 weeks from: January 7 to February 10, 2009.

9912 1:15-2:30pm MTWThF Lecture . . . . . N. Mehdizadeh . . . . . MS 207  
 Section 9912 meets for 5 weeks from: January 7 to February 10, 2009.

#### Evening Hours

9914 4:30-6:00pm MTWTh Lecture . . . . . A. Abbassi . . . . . MS 205  
 Section 9914 meets for 5 weeks from: January 7 to February 10, 2009.

### Mathematics 41A - 3 Units

#### Elementary Algebra, Part I

Prerequisite: Mathematics 23 or Mathematics 25 with a minimum grade of C in prerequisite or qualification by testing (El Camino College Placement Test) and assessment

Note: Students enrolled in this course are required to participate in group activities. Mathematics 41A and 41B together are equivalent to Mathematics 40.

9920 1:15-3:16pm MTWThF Lecture . . . . . A. Abbassi . . . . . MS 205  
 Section 9920 meets for 5 weeks from: January 7 to February 10, 2009.

#### Evening Hours

9922 7:00-9:25pm MTWTh Lecture . . . . . N. Mehdizadeh . . . . . MS 207  
 Section 9922 meets for 5 weeks from: January 7 to February 10, 2009.

Section #	Time	Instructor	Room #
-----------	------	------------	--------

**Mathematics 41B - 3 Units**

*Elementary Algebra, Part II*

Prerequisite: Mathematics 41A with a minimum grade of C or equivalent  
 Note: Students enrolled in this course are required to participate in group activities. Mathematics 41A and 41B together are equivalent to Mathematics 40.

9926 10:30-12:31pm MTWThF Lecture . . . . . D. Roach . . . . . MS 202  
 Section 9926 meets for 5 weeks from: January 7 to February 10, 2009.

**Evening Hours**

9930 6:00-8:25pm MTWTh Lecture . . . . . A. Abbassi . . . . . MS 205  
 Section 9930 meets for 5 weeks from: January 7 to February 10, 2009.

**Mathematics 120 - 3 Units (CAN MATH 2)**

*Nature of Mathematics*

Prerequisite: Mathematics 70 with a minimum grade of C or qualification by testing (El Camino College Mathematics Placement Test) and assessment.  
 Note: You must have satisfied the course prerequisite at El Camino College or another accredited college. A transcript or grade slip is required for verification of a grade from another college.

**Evening Hours**

9934 4:30-6:55pm MTWTh Lecture . . . . . Staff . . . . . MS 207  
 Section 9934 meets for 5 weeks from: January 7 to February 10, 2009.

**Mathematics 130 - 3 Units (CAN MATH 10)**

*College Algebra*

Prerequisite: Mathematics 70 with a minimum grade of C or qualification by testing (El Camino College Mathematics Placement Test) and assessment.  
 Note: No credit will be granted to students who have completed Mathematics 180. You must have satisfied the course prerequisite at El Camino College or another accredited college. A transcript or grade slip is required for verification of a grade from another college.

9935 8:00-10:01am MTWThF Lecture . . . . . D. Roach . . . . . MS 202  
 Section 9935 meets for 5 weeks from: January 7 to February 10, 2009.

9936 1:15-3:16pm MTWThF Lecture . . . . . M. Boroujerdi . . . . . MS 209  
 Section 9936 meets for 5 weeks from: January 7 to February 10, 2009.

**Evening Hours**

9937 7:00-9:25pm MTWTh Lecture . . . . . Staff . . . . . MS 209  
 Section 9937 meets for 5 weeks from: January 7 to February 10, 2009.

**Mathematics 150 - 4 Units (CAN STAT 2)**

*Elementary Statistics with Probability*

Prerequisite: Mathematics 70 with a minimum grade of C or qualification by testing (El Camino College Mathematics Placement Test) and assessment.  
 Note: You must have satisfied the course prerequisite at El Camino College or another accredited college. A transcript or grade slip is required for verification of a grade from another college.

9942 8:00-10:35am MTWThF Lecture . . . . . N. Mehdizadeh . . . . . MS 207  
 Section 9942 meets for 5 weeks from: January 7 to February 10, 2009.

**Evening Hours**

9943 6:00-9:20pm MTWTh Lecture . . . . . M. Ghaflehashi . . . . . MS 212  
 Section 9943 meets for 5 weeks from: January 7 to February 10, 2009.

**Mathematics 170 - 3 Units (CAN MATH 8)**

*Trigonometry*

Prerequisite: Mathematics 60 with a minimum grade of C and Mathematics 70 with a minimum grade of C or qualification by testing (El Camino College Mathematics Placement Test) and assessment  
 Note: You must have satisfied the course prerequisite at El Camino College or another accredited college. A transcript or grade slip is required for verification of a grade from another college.

**Evening Hours**

9946 7:00-9:25pm MTWTh Lecture . . . . . Staff . . . . . MS 210  
 Section 9946 meets for 5 weeks from: January 7 to February 10, 2009.



Section #	Time	Instructor	Room #
-----------	------	------------	--------

**Music**

**(Division of Fine Arts 310-900-1600 ext 2210)**

**Music 11 - 3 Units**

*Music Appreciation Survey*

Recommended Preparation: eligibility for English 1A

9541 1:00-3:25pm MTWThF Lecture . . . . . M. Uch . . . . . Y 80  
 Section 9541 meets for 5 weeks from: January 7 to February 10, 2009.

**Nursing**

**(Division of Health Sciences & Athletics 310-900-1600 ext 2700)**

Enrollment is limited to students who have been accepted into the Nursing Program. Readmission and transfer students must be accepted for entrance into the program in order to enroll in any nursing course. This acceptance/ readmission/transfer policy does not apply to Nursing 48ab or Nursing 145. Nursing 48ab and Nursing 145 may be taken before admission/readmission to the Nursing Program. Nursing courses must be taken in sequence as each course builds on the previous courses.

**Nursing 48ab - 1 Unit**

*Calculating Drugs and Solutions*

Prerequisite: eligibility for Mathematics 70

**Evening Hours**

9851 5:00-6:30pm MW Lecture . . . . . E. Willis . . . . . E 50  
 Section 9851 meets for 5 weeks from: January 7 to February 9, 2009.

**Nursing 151 - 2 Units**

*Human Development and Health*

Enrollment Limitation: admission to the Nursing Program

Note: Formerly Nursing 61

**Evening Hours**

9853 4:30-7:50pm TTh Lecture . . . . . O. Nwabuzor . . . . . E 50  
 Section 9853 meets for 5 weeks from: January 8 to February 10, 2009.

**Nursing 156 - 1 Unit**

*Advanced Nursing Pharmacology*

Prerequisite: Nursing 150, Nursing 151, and Nursing 152 with a minimum grade of C in prerequisite

Note: Formerly Nursing 66B

9854 9:00-10:30am MW Lecture . . . . . S. Thomas . . . . . E 50  
 Section 9854 meets for 5 weeks from: January 7 to February 9, 2009.

**Nursing 210 - 2 Units**

*Implications of Pathophysiology Concepts for Nurses*

Prerequisite: Nursing 153 with a minimum grade of C or equivalent or licensed registered nurse or vocational nurse

9855 9:00-12:20pm TTh Lecture . . . . . D. Heming . . . . . E 50  
 Section 9855 meets for 5 weeks from: January 8 to February 10, 2009.

**Philosophy**

**(Division of Behavioral & Social Sciences 310-900-1600 ext 2563)**

**Philosophy 3 - 3 Units (CAN PHIL 4)**

*Ethics and Society*

Recommended Preparation: eligibility for English 1A

9250 3:30-5:55pm MTWTh Lecture . . . . . D. Smith . . . . . E 33  
 Section 9250 meets for 5 weeks from: January 7 to February 10, 2009.

**Philosophy 5 - 3 Units**

*Critical Thinking and Discourse*

Prerequisite: English 1A with a minimum grade of C

Note: This course satisfies the critical thinking/English composition requirement of IGETC and the critical thinking requirement of the CSU transfer pattern.

9254 10:30-12:55pm MTWTh Lecture . . . . . A. Flemming . . . . . E 39  
 Section 9254 meets for 5 weeks from: January 7 to February 10, 2009.

Section #	Time	Instructor	Room #
-----------	------	------------	--------

## Physics

(Division of Natural Sciences 310-900-1600 ext 2332)

### Physics 11 - 3 Units

*Descriptive Introduction to Physics*

Recommended Preparation: eligibility for English 84

Note: Credit will not be granted to student who has completed a college physics course.

9152 10:30-12:31pm MTWThF Lecture . . . . . W. Keig. . . . . MS 126  
Section 9152 meets for 5 weeks from: January 7 to February 10, 2009.

### Physics 12 - 1 Unit

*Laboratory for Introductory Physics*

Prerequisite: Physics 11 with a minimum grade of C or concurrent enrollment

Note: Credit will not be granted to student who has completed a college physics course with laboratory. Physics 12 satisfies a CSU and IGETC general education laboratory requirement if paired with Physics 11.

9154 1:15-3:16pm MTWThF Lab . . . . . W. Keig. . . . . MS 126  
Section 9154 meets for 5 weeks from: January 7 to February 10, 2009.

### Physics 2A - 4 Units (CAN PHYS 2)

*General Physics*

Prerequisite: Mathematics 170 with a minimum grade of C or equivalent

9150 8:00-10:01am MTWThF Lecture . . . . . M. Khan . . . . . MS 126  
10:15-12:40pm MTWThF Lab . . . . . M. Khan . . . . . MS 126  
Section 9150 meets for 5 weeks from: January 7 to February 10, 2009.

## Political Science

(Division of Behavioral & Social Sciences 310-900-1600 ext 2210)

### Political Science 1 - 3 Units (CAN GOVT 2)

*Governments of the United States and California*

Recommended Preparation: eligibility for English 1A

9267 10:30-12:31pm MTWThF Lecture . . . . . P. Flor . . . . . VT 131  
Section 9267 meets for 5 weeks from: January 7 to February 10, 2009.

## Psychology

(Division of Behavioral & Social Sciences 310-900-1600 ext 2210)

### Psychology 3 - 3 Units

*The Psychology of Thinking*

Prerequisite: English 1A with a minimum grade of C

Note: This course satisfies the critical thinking/English composition requirement of IGETC and the critical thinking requirement of the CSU transfer pattern.

9269 8:00-10:01am MTWThF Lecture . . . . . D. McPatchell . . . . . E 10  
Section 9269 meets for 5 weeks from: January 7 to February 10, 2009.

Section #	Time	Instructor	Room #
-----------	------	------------	--------

### Psychology 5 - 3 Units (CAN PSY 2)

*General Psychology*

Recommended Preparation: eligibility for English 1A

9272 1:00-3:01pm MTWThF Lecture . . . . . H. Williams . . . . . E 10  
Section 9272 meets for 5 weeks from: January 7 to February 10, 2009.

## Spanish

(Division of Humanities 310-900-1600 ext 2554)

### Spanish 1 - 4 Units (CAN SPAN 2)

*Elementary Spanish I*

Recommended Preparation: eligibility for English A

Note: This course is comparable to two years of high school Spanish.

**Evening Hours**

9690 6:00-9:20pm MTWThF Lecture . . . . . Staff . . . . . F 24  
Section 9690 meets for 5 weeks from: January 7 to February 10, 2009.

### Spanish 2 - 4 Units (CAN SPAN 4)

*Elementary Spanish II*

Prerequisite: Spanish 1 with a minimum grade of C or equivalent

Note: The prerequisite for this course is comparable to two years of high school Spanish.

9692 1:00-4:20pm MTWThF Lecture . . . . . Staff . . . . . F 25  
Section 9692 meets for 5 weeks from: January 7 to February 10, 2009.

## Speech Communication

(Division of Fine Arts 310-900-1600 ext 2238)

### Speech Communication 1 - 3 Units (CAN SPCH 4)

*Effective Speaking*

Recommended Preparation: eligibility for English 1A

9566 10:30-12:31pm MTWThF Lecture . . . . . Staff . . . . . E 33  
Section 9566 meets for 5 weeks from: January 7 to February 10, 2009.

**Evening Hours**

9567 6:00-8:01pm MTWThF Lecture . . . . . Staff . . . . . E 38  
Section 9567 meets for 5 weeks from: January 7 to February 10, 2009.

## Theatre

(Division of Fine Arts 310-900-1600 ext 2210)

### Theatre 4 - 3 Units

*Dramatic Literature*

Recommended Preparation: eligibility for English 1A

9585 10:30-12:31pm MTWThF Lecture . . . . . P. Van Niel . . . . . Y 82  
Section 9585 meets for 5 weeks from: January 7 to February 10, 2009.





## Sexual Harassment Policy

It is the policy of the El Camino Community College District and the Compton Community College District to provide an educational, employment and business environment free of unwelcome sexual advances, requests for sexual favor/s, and other verbal or physical conduct or communications constituting sexual harassment as defined and otherwise prohibited by state and federal statutes. Within the El Camino Community College District and the Compton Community College District, sexual harassment is prohibited regardless of the status and/or relationships the affected parties may have.

Sexual harassment violates the policy of the Districts and provisions of the California Fair Employment Act, Education Code and Federal rules, regulations and laws.

Sexual harassment complaint forms are available in the Human Resources Office. Sexual harassment shall be immediately reported to the Compton Center Dean of Human Resources, or to any dean, director, or manager for immediate reporting to the El Camino Community College District's Equal Employment/ Education Officer.

## Discrimination/Sexual Harassment Complaints

El Camino College Compton Center is committed to providing equal opportunity in education and employment. The college affirms its policy to provide fair and equitable treatment of students and employees and prohibit discrimination based on ethnic group identification, national origin, religion, age, sex (harassment), race, color, ancestry, sexual orientation, physical or mental disability, or retaliation.

Students or employees with questions, concerns or complaints of discrimination may contact and/or file an official complaint with these offices or agencies to initiate an El Camino College Compton Center discrimination investigation:

El Camino College Compton Center está comprometido a brindar igualdad de oportunidades de empleo y educación.

Esta institución reitera su política de proveer un trato justo y equitativo a estudiantes y empleados y prohibir la discriminación basada en identificación étnica, nacionalidad, religión, edad, género, raza, color, descendencia, orientación sexual, incapacidad (mental o física), o represalia.

Estudiantes y empleados con preguntas, dudas o quejas de discriminación pueden comunicarse y/o presentar una queja oficialmente con las oficinas o agencias que se nombran a continuación para iniciar una investigación de discriminación por parte de El Camino College Compton Center:

### Students:

- El Camino College Compton Center Equal Employment Officer, Ms. Rachelle Sasser, Human Resources Office, (310) 900-1600, ext. 2140 (310) 660-3473
- Chancellor's Office, Mr. Ralph Black, Assistant General Counsel, California Community Colleges, 1102 Q St., Sacramento, CA 95814-6511
- U.S. Department of Education, Office for Civil Rights, Old Federal Building, 50 United Nations Plaza, Room 239 San Francisco, CA 94102
- California Department of Fair Employment and Housing 611 W. Sixth St., Suite 1600, Los Angeles, CA 90017-3316
- U.S. Equal Employment Opportunity Commission, 255 E. Temple Street, 4th Floor Los Angeles, CA 90012

### Employees:

- El Camino College Compton Center, Equal Employment Officer, Ms. Rachelle Sasser, Human Resources Office, (310) 900-1600, ext. 2140 (310) 660-3473
- Chancellor's Office, Mr. Ralph Black, Assistant General Counsel, California Community Colleges, 1102 Q St., Sacramento, CA 95814-6511
- California Department of Fair Employment and Housing 611 W. Sixth St., Suite 1600, Los Angeles, CA 90017-3316
- U.S. Equal Employment Opportunity Commission, 255 E. Temple Street, 4th Floor Los Angeles, CA 90012

## Special Resource Center (DSP&S)

The DSP&S offers a wide range of classes, supportive services and equipment designed to meet the educational needs of students with disabilities.

Eligibility is determined by specially trained staff. Each student is assessed on an individual basis. Specific educational needs are identified and a plan is developed with each student.

Examples of services or accommodations include sign language interpreters, testing accommodations, or printed materials available in alternate formats.

Courses are designed to address the specific and unique needs of students with disabilities. These courses are listed under "Educational Development" in this Schedule of Classes and are described in the college catalog.

El Camino College Compton Center recognizes its responsibility to provide an equal opportunity to education for all students. The courses, programs and facilities are designed to accommodate the needs of students with disabilities.

Students with verifiable disabilities who do not wish to avail themselves of the services of the DSP&S Office may still be eligible for reasonable accommodation and service. Contact the Director of Admissions and Records (310) 900-1600, ext. 2050 located in the Admissions and Records Office in the Administration Building for more information.



## Transfer Center

Transfer services are offered Monday through Thursday from 8:30 a.m.-5:30 p.m., and Fridays from 8:30 a.m.-4 p.m. in the Welcome Center, Room D-29. The Transfer Center offers a wide range of activities designed to assist students in transferring successfully to the four-year college or university of their choice. Among the transfer services offered are advisement, regularly scheduled visits by admissions office representatives from four-year colleges and universities, and workshops on major steps in the transfer process. Other services offered include university fairs on the El Camino College Compton Center campus and field trips to major universities. Choose and apply to universities online, explore majors, and much more.

## Library

The Library is open Monday - Thursday, 8 a.m.-8 p.m., Friday and Saturday, 9 a.m.-2 p.m. The Library is closed on Sundays and holidays. The collection includes books, periodicals, and over a dozen online computer databases.

A campus photo ID is required to check materials out of the library and for use of the computers in the facility. The Textbook Collection provides materials for use within the library. For additional information call the El Camino College Compton Center Library at 310-900-1600, ext. 2175.

## Learning Resource Center

The Learning Resources Center (LRC) is open to all currently enrolled El Camino College Compton Center students. The LRC includes the Open Lab and the LRC Tutorial Program. The hours are Monday - Thursday, 8 a.m. - 8 p.m., Friday, 8 a.m. - 4 p.m., and Saturday, 8 a.m. - noon.

The LRC houses an extensive media collection to supplement instruction in many disciplines. The LRC and other open computer labs (Math and Science and Vocational/Technology) provide individualized computer-assisted instruction in reading and math. The LRC Tutorial Program offers free drop-in tutoring for over 40 subjects.

## Abel B. Sykes Jr. Child Development Center

The Abel B. Sykes Jr. Child Development Center is accepting applications for Fall 2008 enrollment of infants, toddlers, preschool and school age children. If you are a student and/or working parent you may be eligible for FREE or low-cost child care. For further information, please call (310) 900-1600 ext. 2902 or drop by our office, which is located at the Compton Center Campus in Building T behind the Bookstore.

## Open Labs

**Dills Vocational Technology Center Open Lab:**

Monday - Thursday, 8 a.m. - 8 p.m.  
Friday, 8 a.m. - 5 p.m.

**Mathematics and Science Open Lab:**

Monday - Thursday, 8 a.m. - 9 p.m.  
Friday, 8 a.m. - 4:30 p.m.

**Reading Center (VT-209)**

Monday - Thursday, 8 a.m. - 8 p.m.  
Friday, 8 a.m. - 12 p.m.

**Language Lab(F-39)**

Monday - Thursday, 8 a.m. - 8 p.m.  
Friday, 8 a.m. - 12 p.m.

## Compton Center Bookstore

**Hours:**

Monday - Tuesday 9 a.m. to 4 p.m.  
Wednesday & Thursday 11 a.m. to 6 p.m.  
*Closed Friday*

## Compton Center Cafeteria

**Hours:**

Monday - Thursday 8 a.m. to 2 p.m.  
Friday 8 a.m. to 2 p.m.

## Reciprocal Services for All Students

For your convenience...reciprocal services are available to students enrolled at both El Camino College and El Camino College Compton Center. Students in good standing at either campus have access to services at both campuses, including the bookstore, library and computer labs. Additionally, one parking permit is valid at both campuses.



## Study Abroad for Winter 2009

*Two different study abroad programs will be held during the Winter 2009 intersession.*

### Guadalajara, Mexico

The Guadalajara program will run from January 11 - January 31, 2009 with Art 7 (Art History of Mexico and Central and South America), Spanish 1 (Elementary Spanish 1), and Spanish 24 (Introduction to Spanish and Latin American Language and Cultures) offered. Total program cost of \$2,050.00 includes airfare, lodging, and various excursions. This program also offers an extension to Mexico City at an additional cost. For more information contact Dr. Nitza Llado at 310-660-3189, or via e-mail at [nlado@elcamino.edu](mailto:nlado@elcamino.edu).

### New Zealand/Australia

The New Zealand/Australia program will run from January 7 - January 28, 2009 with History 4 (History of Modern Civilization) and Political Science 2 (Comparative Politics) offered. The cost of the program includes airfare, lodging, and various excursions. This program also offers an extension to Fiji at an additional cost. For more information contact Professor Arthur Verge at 310-660-3759, or via e-mail at [averge@elcamino.edu](mailto:averge@elcamino.edu) or [arthurverge@aol.com](mailto:arthurverge@aol.com).

### Financial Aid is available to interested/qualified students.

Please contact Molly Villalobos in the Financial Aid & Scholarship office at 310-660-3488, or via e-mail at [mvillalo@elcamino.edu](mailto:mvillalo@elcamino.edu).



## SAVE CASH!! HELP YOUR SCHOOL!!! Get Your Auxiliary Services Benefits (ASB) Sticker Today!!

For only \$10 you can purchase an El Camino College Compton Center ASB sticker and save money on movies, Disneyland tickets, clothing, fast food and more.

ASB stickers can be purchased during registration or at the Bursar's Office.

The ASB sticker offers a variety of discounts at businesses, theaters, ASB sponsored events, and athletics events. El Camino College Compton Center students can also utilize ASB stickers on the El Camino College Campus including access to Activities Center table games, free admission to all campus athletic events and a discount on tickets at District-sponsored Center for the Arts events. Funds generated from the cards help support student activities.

**BUY A STICKER . . . SAVE MONEY!!**



# ABEL B. SYKES, JR. CHILD DEVELOPMENT CENTER



**IS NOW ACCEPTING APPLICATIONS FOR CHILDCARE SERVICES  
FREE OR LOW COST CARE MAY BE AVAILABLE TO THOSE WHO  
QUALIFY**

## **THE CENTER SERVES**

**Infants/Toddlers (Birth - 2 years)**

*M-F: 7:45am - 6:30pm*

*F: 7:45am - 5:00pm*

**Preschool Children (3 - 5 years)**

*M-TH: 7:45am - 6:30pm*

*F: 7:45am - 5:00pm*

**School age Children (6 - 12 years)**

*After School*

**Saturday (as available)**

*8:00am - 3:00pm*

**For more information**

**Please call: Sheila Scott, Administrative Assistant @ (310) 900-1600 X2902**

**The Child Development Center is located behind the Bookstore and  
Student Life Office**

CAMPUS DIRECTORY 2007 - 2008

- A - Administration, Provost/CEO, Admissions & Records, Counseling, Student Services
- AHB - Allied Health Building (Closed during Renovation)
- B - Library, Health and Human Services Division, Nursing
- C - Academic Affairs, Business Affairs, Human Resources
- D - Welcome Center, Transfer Center, Student Support Services, Outreach and School Relations
- DELTA - Foster and Kinship Care Education
- E - Social Science, Family Studies, Ethnic Studies, TV Studio, Digital Photography, Financial Aid
- F - Journalism Lab, Language/Writing Lab, Special Resource Center (DSP&S)
- G - Spanish, Academic Senate, Assessment Center
- IC - Child Development Center- Infant/Toddler Building
- J - Maintenance
- LRC - Learning Resource Center
- MS - Math/ Science
- MIS - Management Information Systems
- M1 - ESL/Philosophy
- M3 - Police Department
- Q - Student Lounge, Cafeteria, Faculty & Staff Lounge
- R - Bookstore/ Student Life
- T - Abel B. Sykes, Jr. Building- Child Development Center
- TRIO - Talent Search, Upward Bound, Upward Bound Math & Science
- U - EOP&S/ CARE, Women's Locker Room
- V - Classrooms
- VT - Engineering, Business, CIS, Machine Shop, Diesel, Auto Shop, Welding, CalWorks, Job Placement & Career Center, Print Shop
- W - Physical Education, Athletics, Men's Locker Room
- X - Gymnasium
- Y - Music, Theater Arts
- Z - Swimming Pool

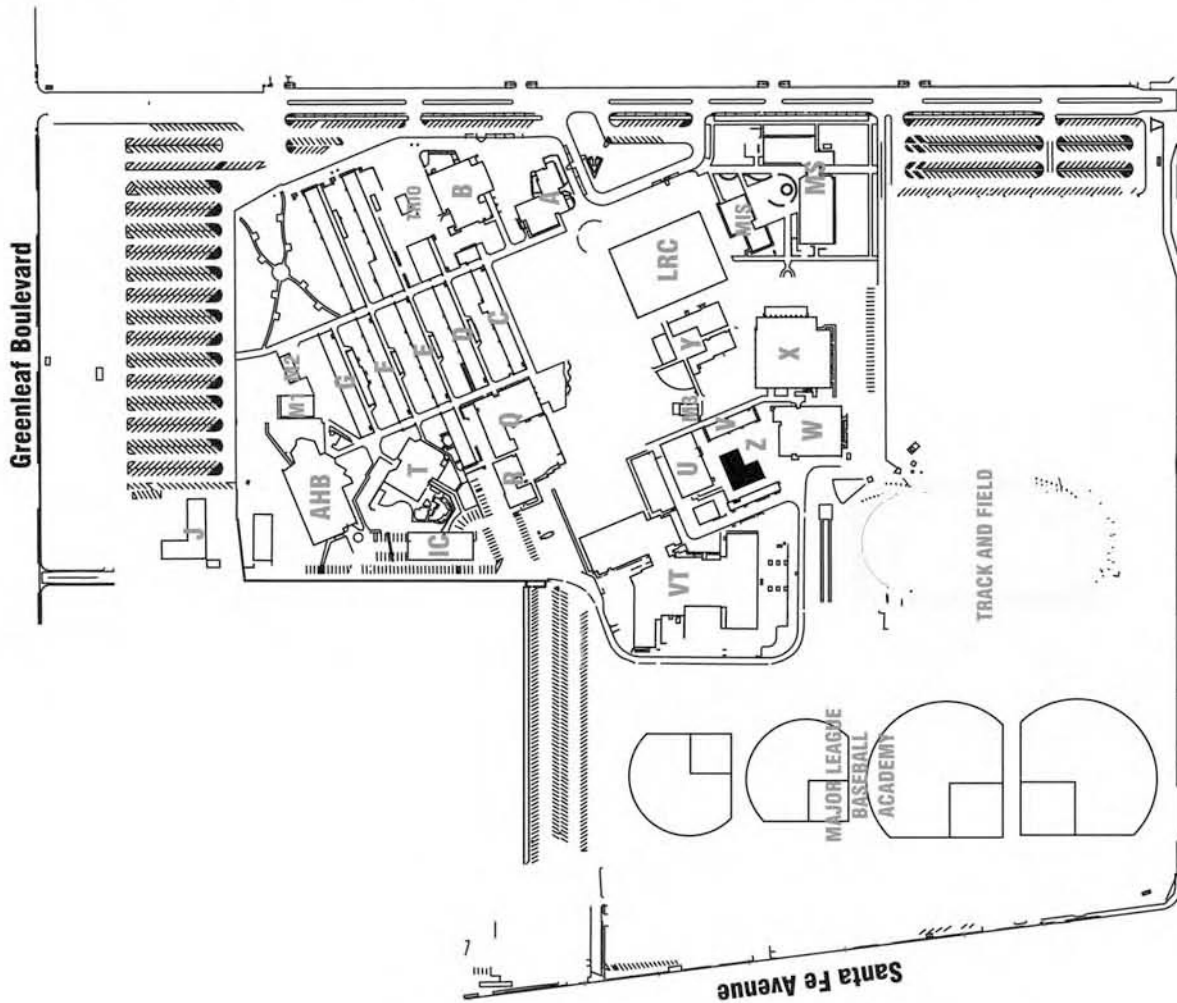

**EL CAMINO COLLEGE - COMPTON CENTER**

1111 E. Artesia Boulevard - Compton, CA 90221 (310) 900-1600 [www.compton.edu](http://www.compton.edu)

**DIRECTORIO del CAMPUS 2007-2008**

A - Administración, Superintendente/Ejecutivo, Ingresos y Documentos, Conserjerías y Servicios Estudiantiles

AHB - Edificio de Salud Aliada (cerrado durante renovación)

B - Biblioteca, Divisiones de la Salud y Servicios Humanos, Enfermería

C - Asuntos Académicos, Asuntos de Negocios, Recursos Humanos

D - Centro de Bienvenida, Centro de Traslados, Servicios de Apoyo Estudiantil, Servicio Acogedor y Relaciones Colegiales

Delta - Enseñanza Acogedora y Cuidado Parentesco

E - Ciencias Sociales, Estudios de Familia, Estudios Étnicos, Estudio (salón) de Televisión, Fotografía Digital, Ayuda Financiera

F - Laboratorios para Periodismo, Idiomas/Ensallos y Centro de Recursos Especiales (DSP&S)

G - Español, Senado Académico, Centro de Evaluación

IC - Centro para el Desarrollo de Infantes/Niños Pequeños

J - Mantenimiento

LRC - Centro de Recursos de Aprendizaje

MS - Matemáticas/Ciencias

MIS - Sistemas de Información Administrativa

M1 - Filosofía/ Inglés Como Segundo Idioma(ESL)

M3 - Departamento de Policía

Q - Salón Estudiantil de Descanso, Cafetería, Salón de la Ejecutiva y Empleados

R - Librería/Vida Estudiantil

T - Edificio Abel B. Sykes, Jr, Centro de Desarrollo de Niños

TRIO - Búsqueda de Talento, Camino Hacia el Éxito, Éxito con Matemáticas y Ciencias

U - CARE/ EOP&S, Area para Vestuarios de Mujeres

V - Las Aulas/Salones de Clases

VT - Ingeniería, Negocios, CIS, Taller de Maquinas, Diesel, Taller de Autos, Soldadura, CalWorks, Posiciones de Empleos y Centro para Carreras, Imprenta

W - Educación Física, Atletismo, Vestuarios (salón) de Hombres

X - Gimnasio

Y - Música, Artes de Teatro

Z - Piscina (alberca)

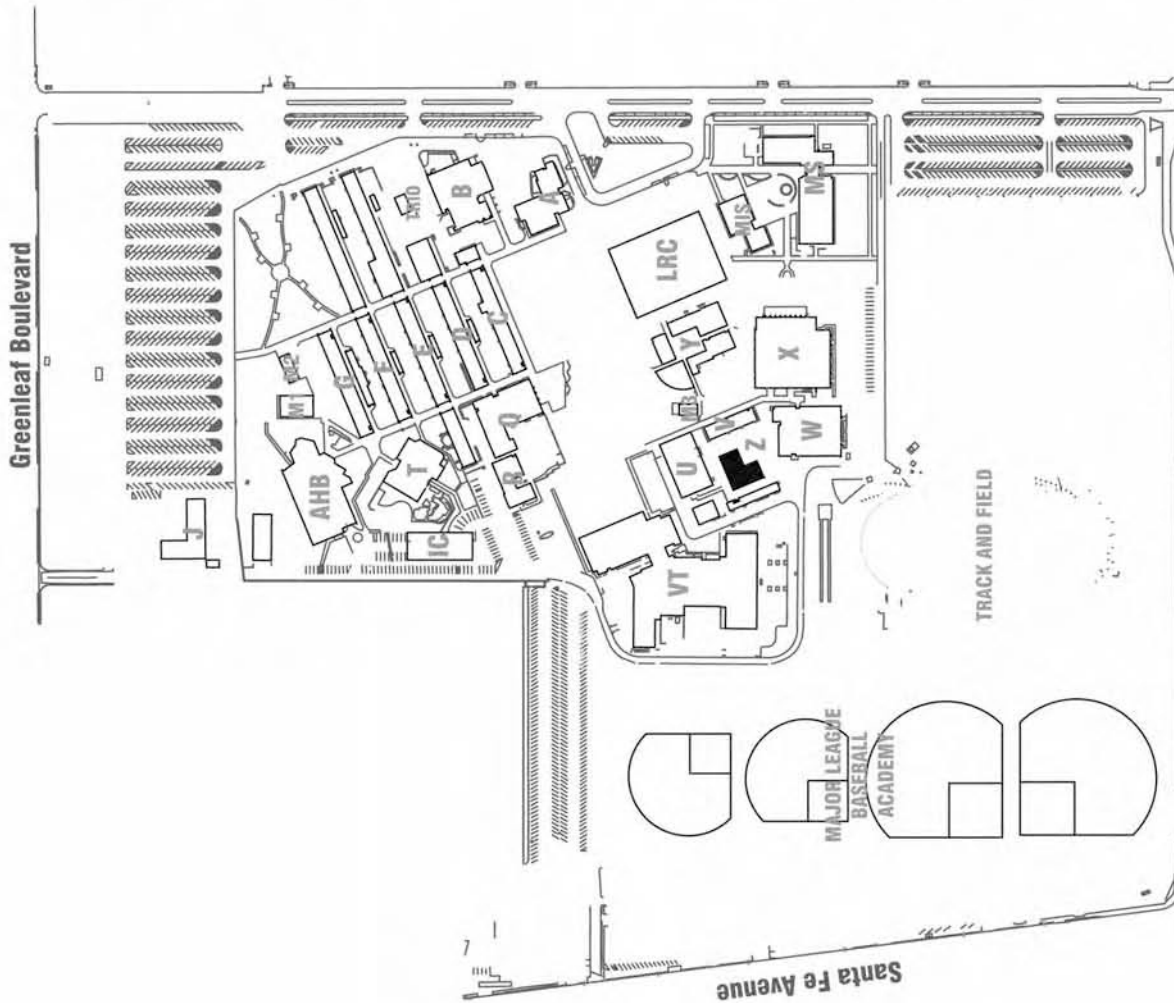

**Artesia Boulevard**  
**EL CAMINO COLLEGE - COMPTON CENTER**

1111 E. Artesia Boulevard - Compton, CA 90221 (310) 900-1600 [www.compton.edu](http://www.compton.edu)