

EL CAMINO COLLEGE COMPTON CENTER



SUMMER 2009



www.compton.edu

EL CAMINO COLLEGE COMPTON CENTER
1111 E Artesia Blvd. Compton CA 90221 310-900-1600

SUMMER SESSION BEGINS JUNE 15

Summer 2009 First Five-Week Session

First Five-Week Session Begins	Monday, June 15, 2009
Last Day to Drop & Be Eligible for a Refund	Friday, June 19, 2009
Last Day to Add	Thursday, June 18, 2009
Last Day to Drop Without Notation on Permanent Record	Tuesday, June 23, 2009
Last Day to Drop with a "W"	Tuesday, July 7, 2009
Independence Day Holiday (Campus Closed)	Thursday, July 2, 2009
First Five-Week Session Ends	Friday, July 17, 2009

Summer 2009 Second Five-Week Session

Second Five-Week Session Begins	Monday, July 20, 2009
Last Day to Drop & Be Eligible for a Refund	Friday, July 24, 2009
Last Day to Add	Thursday, July 23, 2009
Last Day to Drop Without Notation on Permanent Record	Tuesday, July 28, 2009
Last Day to Drop with a "W"	Tuesday, August 11, 2009
Second Five-Week Session Ends	Friday, August 21, 2009

Summer 2009 Eight-Week Session

Eight-Week Session Begins	Monday, June 22, 2009
Last Day to Drop & Be Eligible for 100% Non-Resident Tuition Refund	Friday, June 26, 2009
Last Day to Add	Tuesday, June 30, 2009
Independence Day Observed (Campus Closed)	Thursday, July 2, 2009
Last Day to Drop Without Notation on Permanent Record	Tuesday, July 7, 2009
Last Day to Drop with a "W"	Tuesday, July 28, 2009
Eight-Week Session Ends	Thursday, August 13, 2009

Check your registration appointment online at www.compton.edu
Log on to **MyECC** and click on **Registration Appointment Time**
or call **310-516-9339**.

Table of Contents General Information

How to Reach Us	2
Steps to Registration	3
Fees	4
Cross Enrollment	6
Policies and Services	6
Prerequisites	6
Financial Aid Charts	11
Online Classes	13
Distance Education	17
Study Abroad	29
Off-Campus Locations	29
Campus Maps	30



How To Register

Contact Us on the Web
www.compton.edu

or call
310-516-9339

How to Reach Us:

Academic Affairs (C-32): 310-900-1600, ext. 2133
Student Services (Administration Building):
310-900-1600, ext. 2023

Academic Affairs Office Telephone Numbers

Behavioral and Social Science/Fine Arts	ext. 2210
Business/Computer Information Systems	ext. 2271
Counseling	ext. 2076
Human Services/Nursing/Child Development	ext. 2700
Humanities/ESL/Foreign Languages	ext. 2234
Mathematics and Natural Science	ext. 2332
Vocational/Technical; Family and Consumer Studies; Physical Education/Health Education	ext. 2620

Student Services Telephone Numbers

Admissions and Records Office (Administration Building)	ext. 2050
Assessment Center	ext. 2830
Associated Student Body / Student Life (R-61)	ext. 2802

Athletics	ext. 2949
Bookstore	ext. 2820
Bursar's Office (C-36)	ext. 2104
CalWORKs	ext. 2072
Compton Center Police:	
Immediate Response	310-660-310
Front Desk/Non-emergency	310-900-1600 ext. 2999
Child Development Center	ext. 2902
Counseling (Administration Building)	ext. 2076
Special Resource Center - (DSP&S)	ext. 2402
EOP&S/CARE (U-6)	ext. 2912
Financial Aid/Scholarships (E-12)	ext. 2935
International Students (Administration Building)	ext. 2043
Job Placement / Career Center (VT-109)	ext. 2788
Learning Resource Center (G-33, G-39)	ext. 2535
Library	ext. 2175
Student Support Services (D-29)	ext. 2502
Transfer Center (D-29)	ext. 2764
Veterans Office (Administration Building)	ext. 2043
Welcome Center/Outreach (D-28)	ext. 2763
Women in Industry and Technology	ext. 2779

STEP 1 | Admission

Who is eligible for Admission?

Anyone 18 years of age or older qualifies for admission to El Camino College Compton Center. If under the age of 18, you will qualify if you have 1) graduated from high school or 2) passed the California High School Certificate of Proficiency Test.

El Camino College Compton Center may admit as a special part-time or special full-time student anyone in grades 11 or 12 who, in the opinion of the provost, may benefit from instruction. Concurrently enrolled 11th and 12th grade students must comply with all policies, follow all procedures, and meet all requirements by the published deadlines for each semester and/or session.

California Residence Requirement

Can I apply as a California resident?

To attend El Camino College Compton Center as a resident of California, a student is required to have been a legal resident of the state, as defined in the California Education Code, for more than one year immediately preceding the residence determination date. The residence determination date is the day preceding the first day of the semester or session.

In addition you must meet the two-year intent provisions of California residency code, and must not have engaged in any actions that are contrary to establishing residency in the state of California.

How Do I Apply?

Apply online by visiting: www.compton.edu and clicking on **Apply Online** - it's that easy! New and returning students (those with an absence of two consecutive semesters, excluding Summer and Winter Session) must complete an application. Don't forget to submit official transcripts from all accredited colleges and trade schools attended. If you are applying for Advanced Placement credit, then you must submit your official high school transcripts.

Step 2 | Assessment

How Do I Make Arrangements For Testing?

Personal identification with a photograph and your El Camino College Compton Center I.D. number are required to take tests and receive results.

You must have an application on file prior to any testing. Testing should be completed as soon as possible after you file your admission application. Read the catalog description of classes which interest you to learn if there is any testing recommended or needed. Keep in mind that all placement tests are part of the multiple measures of the assessment process. Be sure to take testing results with you when you go for your academic advisement or educational planning sessions.

The placement tests for English, English as a Second Language, and Math are computerized and given on a drop-in basis—no appointment is necessary. Other tests, such as the Chemistry Placement Test, are given on an appointment-basis only. Please contact the Assessment Center for further information at 310-900-1600 ext. 2830.

All testing is done on campus at the Assessment Center. Testing must be completed before you register for courses. Retesting is limited and may not be done after you have enrolled in any course related to the test.

STEP 3 | Orientation

Welcome to El Camino College Compton Center! All students are encouraged to participate in orientation and to become familiar with the center and its resources.

Sign-up for Summer 2009 student orientations in the Counseling Department, located in the Administration Building. Students learn about campus services and programs through the orientation provided by the Counseling Department.

For more information about campus orientations, please contact the Counseling Department at 310-900-1600 ext. 2076.

STEP 4 | Counseling/ Advisement

How can I get help selecting classes?

Counseling services are available to students through scheduled appointments. A student who has selected a major field of study is strongly encouraged to see one of the counselors assigned to that field; an undeclared or undecided student may see any counselor.

As an integral part of the matriculation program, counseling services are intended to assist students in clarifying career and life goals and in developing an appropriate course of study based on a student's goals, aptitudes and interests.

Drop-in advisement is available Monday through Thursday from 8 a.m. to 6:30 p.m. and Fridays from 8 a.m. to 4:30 p.m. for students who have questions which do not require transcript review. The drop-in advisement schedule is subject to change, based on counselor availability. Please call the Counseling Department in advance for the daily schedule at 310-900-1600 ext. 2076.



STEP 5 | Registration

Ready – Set – Register!

How do I prepare to register?

- Be sure you meet any prerequisites and corequisites.
- Meet with a counselor to ensure your schedule is in line with your educational goals.

Procedure

Registration appointment information for continuing students will be available beginning May 1, 2009. For new and returning students, this information will be available on or after May 15. Please go online to www.compton.edu, click on **MyECC - Registration Appointment Time**. You may also check by telephone by calling (310) 516-9339.

Before you go online or register by telephone, you must confirm your registration date and time.

When Do I Register?

Find out your registration date and time - it is available online at: www.compton.edu - click on **MyECC - Registration Appointment Time**.

Students may not register prior to the assigned date and time.

How Do I Register?

Register online at www.compton.edu and click on **MyECC** or by telephone at 310-516-9339. You will be given clear, easy-to-follow, step-by-step instructions. Computers are available for student use in the Welcome Center, Financial Aid, Admission Office Informational Center, VT 209, and Library.

STEP 6 | Pay Fees

All students who enroll in credit classes must pay an enrollment fee. Students must pay the appropriate enrollment fee at the time of registration. Financial assistance (Board of Governor's Fee Waiver) is available to pay the registration fees and the health fee if the student is eligible. A Board of Governor's Fee Waiver application is available online at www.compton.edu - **MyECC**, or apply at the Financial Aid Office.

Until all fees are paid, students will not be able to purchase parking permits, receive transcripts, or register for upcoming semesters.

The general fee requirement shall not apply to students enrolled in the non-credit courses specified in Education Code Section 84711.

Out-of-state students who have a Free Application for Federal Student Aid (FAFSA) on file in the Financial Aid Office are encouraged to submit the preliminary documents for review as early as possible. **Students are responsible for paying all fees and charges even if they applied for financial aid by the established deadlines.**

Fees

You are liable for all fees unless you drop the class by the refund deadline date. Fees are due within 7 days of phone or Web registration. Walk-In Registrants: Fees are due at time of registration. All fees are subject to change.

ALL FEES SUBJECT TO CHANGE

Enrollment Fee	\$20 for each credit unit
Parking Permit – Car	\$12 per semester
ASB Student Discount Sticker	\$10 per semester
ASB Representation Fee50 cents per semester
Out-of-State Fee	\$190 per unit plus the regular enrollment fee of \$20 per unit
Out-of-Country Fee	\$221 per unit plus the regular enrollment fee of \$20 per unit
Auditing	\$15 per unit
Transcripts (first two free)\$3 each, \$5 for next day or hand-carry to ECC	

Bursar's Office Hours - (C36)

Monday - Thursday: 8:00 a.m. - 6:00 p.m.

Friday: 8:00 a.m. - 1:00 p.m. June 19, June 26, July 24 and July 31, 2009

Financial Assistance

All students are encouraged to apply for financial aid by visiting the Financial Aid Office Web site at: www.compton.edu. Begin by clicking the Apply Online button and follow the instructions for a new student (never attended college) or returning student (break in enrollment) or continuing student (no break in enrollment) column. Please review the available resources on the financial aid Web site under the Information Desk, Programs, Services and Free Calculators. California residents may wish to apply for a Board of Governor's Fee Waiver (BOGW) to pay for their enrollment fees. Students are encouraged to complete the Free Application for Federal Student Aid (FAFSA) to determine eligibility for all federal, state and institutional programs. Some students in certain programs such as CalWORKS, CARE, or EOP&S may also complete the fee waiver application in addition to the FAFSA form. Please see enclosed applications.

Health Services Fee

All fees are subject to change. El Camino College Compton Center students have the option to pay \$14 each semester to cover the operation, supervision, programs, and services of the student health services at El Camino College.

If a Compton student comes to the El Camino College cashier window and asks to use the El Camino College Health Center, he or she will be charged the \$14

fee for the access to those services.

There are exceptions under these conditions:

1. Students receiving financial aid pursuant to Section 72252.1.

2. Low-income students who meet the Board of Governors grant criteria (pursuant to Section 72252) as demonstrated by appropriate support documentation of eligibility; SSI eligibility; or GA eligibility; Veterans Affairs Dependent Fee Waiver Certification; Agency Certification or Income Tax form as they relate to qualifying Income levels; or a combination of these and unmet student need as determined by the Financial Aid Office.

3. Students who depend exclusively upon prayer for healing in accordance with the teachings of a bona fide religious sect, denomination or organization. Students will not be required to pay this fee if they are enrolled only in classes held off campus, only in distance education classes, only in non-credit classes or work site classes. High school students or students enrolled in contract classes only are also exempt.

Refund: Students who withdraw from all courses prior to the close of the second week of the term will be eligible for a refund of the Health Services Fee. Forms to request a refund may be obtained at the Admissions and Records Office.

Health services are provided for students 18 years of age or older who pay the mandatory health fee. High school students permitted to attend the college on a concurrent enrollment basis are not eligible for health services. **College stu-**

dents under 18 years of age subject to other admissions criteria must pay the health fee and submit a parental or guardian consent form to receive health services. Children, including children of students, are not permitted in Student Health Services.

Fee Payment

For any fee paid, the college will accept personal checks drawn on United States banks, money orders or cash.

Also honored will be VISA, American Express, MasterCard and Discover credit cards. Checks returned by a student's bank for any reason will result in (1) suspension from enrollment, (2) denial of subsequent registration and (3) detention of transcript until the financial obligation has been satisfied. A service charge of \$20 will be charged on any returned check.

Refunds of Fees

Students must drop their classes through the online system located in the Administration Building, by phone or by Web, according to the following schedule:

Classes beginning Monday, June 15 must be dropped by Friday, June 19.

Classes beginning Monday, June 22 must be dropped by Thursday, June 25.

Classes beginning Monday, July 20 must be dropped by Friday, July 24.

To receive a refund for a parking permit, you must return your permit to the Bursar's Office (C-36) within this same time period. Refund checks will be mailed before the end of the semester.

If your address has changed, please update the change in the Admissions Office.

Non-Resident Refund Policy

To receive a refund of non-resident tuition, drop your classes through the online system by the refund deadlines listed below:

Five week classes starting June 15:

For 100 % refund, drop classes by Friday, June 19. For 50 % refund, drop classes by Friday, June 26.

Eight week classes starting June 22:

For 100 % refund, drop classes by Friday, June 26. For 50 % refund, drop classes by Wednesday, July 1.

Five week classes starting July 20:

For 100 % refund, drop classes by Friday, July 24. For 50 % refund, drop classes by Friday, July 31.

You may access the online system via the Web, registration phone line, or in the Admissions and Records Office.

There will be no refund for classes dropped after the 2nd week of the session. Refund checks will be mailed by September 30, 2009, to the address you have on file in the online student system. If your address has changed, update your address immediately in the Admissions and Records Office to assure your refund check is mailed to the correct address.

California Residency

To attend El Camino College Compton Center as a qualified California resident, you must have established legal residence in the state one year and one day prior to the start of the term. In addition, you must meet the two-year intent provisions of California residency code and must not have engaged in any actions that are contrary to establishing residency in the state of California. The burden of proof to clearly demonstrate both physical presence in California and intent to establish California residence lies with the student in accordance with Education Code Section 68040.

The residence of an unmarried student under the age of 19 is determined by the legal residence of the parents. A married minor determines residency from the date of marriage and must comply with all provisions of residency as cited above. A person may not derive residence from a spouse.

Priority Registration

In compliance with Section 51825 of Title 5, California Administrative Code, priority registration will be implemented in this way:

1. Special registration assistance to the handicapped or disadvantaged students as defined by statute for the purpose of providing equalization of education.

2. Students will receive priority registration according to this ranking system and criteria:

- Registration priority will be awarded as follows:
 - A. First priority: continuing students
 - B. Second priority: new and readmit students
- For fall and spring semesters, the enrollment of continuing students in accordance with priority system established on the basis of these factors:
 - A. One point for each unit completed at El Camino College Compton Center

plus one point for each unit in which the student is currently enrolled (midterm) with a maximum of 60 points.

B. Points awarded according to the total units in the current program after the 12th week as follows: 0 to 3 units equals 0 points; 3.5 to 6 units equals 2 points; 6.5 to 9 units equals 4 points; 9.5 units to 15 points equals 6 points and 15.5 plus units equals 10 points.

C. A reward of 15 points to students for maintaining their original unit load from the start of the semester through the 12th week.

D. A reward of 10 points to students with 2.0 or higher cumulative GPA

E. Day and evening programs are used to divide the student body into a day or extended day priority system. One or more day classes constitutes a day program.

3. The early enrollment of students who meet one of these guidelines:

- Instruction program requires time off campus limiting the choice of class periods on campus.
- The instructional activity requires a block of time associated with scheduled classes for such activities as practice, meetings, counseling and off-campus travel.
- First semester F-1 visa students.

Adds and Drops

It is the student's responsibility to process an official withdrawal from class. Failure to do so may result in a letter grade of A through F. A student may drop a class or classes within the refund period and add another class or classes using the fees already paid.

If a student drops after the refund deadline, payment of fees for the classes is forfeited. Any added class will require additional fees.

A student may drop a class before the refund deadline and add a class with no additional fees. If a student drops a class after the refund deadline in order to add the same class at a different time/date/instructor, the student must request a lateral transfer or level transfer from both instructors. All transfers are processed through the Admissions and Records Office.

Withdrawal from Class

It is the student's responsibility to process an official withdrawal from class at the Admissions and Records Office. Failure to complete this

process may result in a letter grade of A through F recorded on the student's permanent record.

It is the high school student's responsibility to submit all required documentation on time and complete by the published deadlines. Failure to do so will jeopardize the student's enrollment for the semester/session.

Photo Identification and ASB Stickers

All students are required to obtain a free El Camino College Compton Center identification card. These cards are available in the Student Life Office Monday - Thursday, 8 a.m. - 8:30 p.m.

These cards serve as photo identification, and are required for Library services, campus activities, access to the Learning Resource Center and Open Computer Labs, and to verify attendance in classes.

All students are encouraged to purchase an optional ASB sticker for their photo identification cards during registration at the Bursar's Office. The ASB sticker offers a variety of discounts at businesses, theaters, ASB sponsored events, and athletics events. El Camino College Compton Center students can also utilize ASB stickers on the El Camino College campus including access to Activities Center table games, free admission to all campus athletic events and a discount on tickets at district-sponsored Center for the Arts events. Funds generated from the cards help support student activities. The \$10 sticker fee per semester is nonrefundable.

Attendance

If you enroll in a class and you do not attend the first scheduled meeting of the class, you may be dropped from the roster and your place may be given to a waiting student.

Children in Classrooms

Children are not permitted in classrooms while class is in session. Attendance in class is limited to officially enrolled students and authorized visitors or guests only. In addition, students shall not allow children to be left unattended or unsupervised anywhere on campus. It is the responsibility of each faculty member to inform students of this requirement.

Student Records

Congress has provided in the "Family Education Rights and Privacy Act" that students have certain rights of access to their education records. A copy of the Act is located in the Library. Please contact the Admissions Office for any information regarding your rights under the Act.

Equivalent Courses

www.elcamino.edu/admissions/catalog.asp

Courses completed at other colleges and universities may be used to meet a prerequisite. Some high school courses, as stated in the college catalog, may also be used to meet a prerequisite.

Students who have completed equivalent courses at another college or in high school must have copies of necessary transcripts. Do not delay. Order transcripts and clear prerequisites prior to registration. Clearance for an equivalent course may be obtained in the

Counseling Department or the Academic Affairs Office (C-32) located in the Administration Building.

Transcripts

If you plan to attend under veterans or Social Security benefits, receive academic advisement to become matriculated, or need to have coursework at other colleges reviewed for prerequisite clearance, you must request college transcripts from all schools you have attended be sent to the El Camino College Records Office.

If you plan to graduate from El Camino College with a degree or certificate and wish to have course work taken at other colleges considered for graduation, you must request official transcripts to be mailed from the other colleges to the El Camino College Records Office. Hand carried transcripts from the student or any other party will not be accepted.

Your first two El Camino College transcripts are free. Additional transcripts

incur a fee as determined by college policy and payable at the time of the transcript request. Transcripts are processed on a first in, first out basis.

Cross Enrollment at CSU Dominguez Hills

El Camino College Compton Center students who are eligible may cross-enroll at CSU Dominguez Hills without formal admission and without payment of state university tuition, in a maximum of one baccalaureate-level course per semester on a space available basis. Such enrollment would be at the discretion of the appropriate campus authorities on each of the campuses.

A student must meet the requirements of cross enrollment to be eligible

Additional information on requirements and procedures may be obtained at the El Camino College Compton Center Admissions and Records Office or Counseling Department, located in the Administration Building.

Information about the following policies and services can be found online at:

Adds and Drops

www.elcamino.edu/admissions

Assessment and Testing

<http://www.compton.edu/student-services/supportservices/assessmentcenter/Pages/default.aspx>

Audit of Courses

www.elcamino.edu/admissions/credit.asp

CalWORKs/TANF/GAIN

<http://www.compton.edu/student-services/supportservices/CalWORKSTANFGAIN/Pages/default.aspx>

Challenging a Prerequisite or Corequisite

www.elcamino.edu/admissions/catalog.asp

Counseling

<http://www.compton.edu/student-services/supportservices/counseling/Pages/default.aspx>

EOPS/CARE

<http://www.compton.edu/student-services/supportservices/eopscare/Pages/default.aspx>

Job Placement/Career Center

<http://www.compton.edu/student-services/supportservices/jobplacementcareercenter/Pages/default.aspx>

Library

<http://www.compton.edu/library/Pages/default.aspx>

Matriculation

<http://www.compton.edu/student-services/supportservices/matriculation/Pages/default.aspx>

Non-resident Refund Policy

www.elcamino.edu/admissions/fees.asp

Prerequisite and Corequisite Information

www.elcamino.edu/admissions/catalog.asp

Special Resource Center

<http://www.compton.edu/student-services/supportservices/specialresourcecenter/Pages/default.aspx>

Standards of Scholarship

www.elcamino.edu/admissions/catalog.asp

Student Support Services

<http://www.compton.edu/student-services/supportservices/trio/Pages/STUDENT SUPPORT SERVICESPROGRAM.aspx>

Transcripts

www.elcamino.edu/admissions/transcripts.asp

Transfer Center

<http://www.compton.edu/student-services/supportservices/transfercenter/Pages/default.aspx>



El Camino College – Compton Center Financial Aid Office

2008-2009 Board of Governors Fee Waiver Application

This is an application to have your **ENROLLMENT FEES WAIVED**. This **FEE WAIVER** is for California residents only. If you need money to help with books, supplies, food, rent, transportation and other costs, please complete a **FREE APPLICATION FOR FEDERAL STUDENT AID (FAFSA)** immediately. Contact the Financial Aid Office for more information. The FAFSA is available at www.fafsa.ed.gov or at the Financial Aid Office.

Note: Students who are exempt from paying nonresident tuition under **Education Code Section 68130.5 (AB 540)** are NOT California residents. If you are NOT a California resident, you are not eligible for a fee waiver. Do not complete this application. You may apply for financial aid by completing the FAFSA.

Name: _____ Student ID # _____
Last First Middle Initial

Email (if available): _____ Telephone Number: (____) _____

Home Address: _____ Date of Birth: ____/____/____
Street City Zip Code

Has the Admissions or Registrar's Office determined that you are a California resident? Yes No

IMPLEMENTATION OF THE CALIFORNIA DOMESTIC PARTNER RIGHTS AND RESPONSIBILITIES ACT

The California Domestic Partner Rights and Responsibilities Act extends new rights, benefits, responsibilities and obligations to individuals in domestic partnerships registered with the California Secretary of State under Section 297 of the Family Code. If you are in a Registered Domestic Partnership (RDP), you will be treated as an Independent married student to determine eligibility for this Enrollment Fee Waiver and will need to provide income and household information for your domestic partner. If you are a dependent student and your parent is in a Registered Domestic Partnership, you will be treated the same as a student with married parents and income and household information will be required for the parent's domestic partner.

Note: These provisions apply to state student financial aid ONLY, and not to federal student financial aid.

Are you or your parent in a Registered Domestic Partnership with the California Secretary of State under Section 297 of the Family Code? (Answer "Yes" if you or your parent are separated from a Registered Domestic Partner but have **NOT FILED** a Notice of Termination of Domestic Partnership with the California Secretary of State's Office.) Yes No

If you answered "Yes" to the question above treat the Registered Domestic Partner as a spouse. You are required to include your domestic partner's income and household information or your parent's domestic partner's income and household information in Questions 3, 6, 7, 8, 9, 10, 11, 12.

Student Marital Status: Single Married Divorced Separated Widowed Registered Domestic Partnership

DEPENDENCY STATUS

- Were you born before January 1, 1985? Yes No
- As of today, are you married or in a Registered Domestic Partnership (RDP)? (Answer "Yes" if you are separated but not divorced or have not filed a termination notice to dissolve partnership.) Yes No
- Do you have children who receive more than half of their support from you, or other dependents who live with you (other than your children and spouse/RDP) who receive more than half of their support from you, now and through June 30, 2009? Yes No
- Are (a) both your parents deceased, or (b) are you (or were you until age 18) a ward/dependent of the court? Yes No
- Are you a veteran of the U.S. Armed Forces or currently serving on active duty for purposes other than training? Yes No

• If you answered "Yes" to any of the questions 1 - 5, you are considered an **INDEPENDENT** student for enrollment fee waiver purposes and must provide income and household information about yourself (and your spouse or RDP if applicable). Skip to Question #8.

• If you answered "No" to all questions 1 - 5, complete the following questions:

- If your parent(s) or his/her RDP filed or will file a 2007 U.S. Income Tax Return, were you, or will you be claimed on their tax return as an exemption by either or both of your parents? Will Not File Yes No
- Do you live with one or both of your parent(s) and/or his/her RDP? Yes No

• If you answered "No" to questions 1 - 5 and "Yes" to either question 6 or 7, you must provide income and household information about your PARENT(S)/RDP. Please answer questions for a **DEPENDENT** student in the sections that follow.

• If you answered "No" or "Parent(s) will not file" to question 6, and "No" to question 7, you are a dependent student for all student aid except this enrollment fee waiver. You may answer questions as an **INDEPENDENT** student on the rest of this application, but please try to get your PARENT information and file a FAFSA so you may be considered for other student aid. You cannot get other student aid without your parent(s) information.

METHOD A ENROLLMENT FEE WAIVER

- Are you (the student ONLY) currently receiving monthly cash assistance for yourself or any dependents from:
TANF/CalWORKs? Yes No
SSI/SSP (Supplemental Security Income/State Supplemental Program)? Yes No
General Assistance? Yes No
- If you are a dependent student, are your parent(s)/RDP receiving monthly cash assistance from TANF/CalWORKs or SSI/SSP as a primary source of income? Yes No

• If you answered "Yes" to question 8 or 9 you are eligible for an **ENROLLMENT FEE WAIVER**. Sign the Certification at the end of this form. You are required to show current proof of benefits. Complete a FAFSA to be eligible for other financial aid opportunities.

METHOD B ENROLLMENT FEE WAIVER

10. **DEPENDENT STUDENT:** How many persons are in your parent(s)/RDP household? (Include yourself, your parent(s)/RDP, and anyone who lives with your parent(s)/RDP and receives more than 50% of their support from your parents/RDP, now and through June 30, 2009.) _____
11. **INDEPENDENT STUDENT:** How many persons are in your household? (Include yourself, your spouse/RDP, and anyone who lives with you and receives more than 50% of their support from you, now and through June 30, 2009.) _____
12. **2007 Income Information**

	DEPENDENT STUDENT: PARENT(S)/RDP INCOME	INDEPENDENT STUDENT: STUDENT (& SPOUSE'S/ RDP) INCOME
a. Adjusted Gross Income (If 2007 U.S. Income Tax Return was filed, enter the amount from Form 1040, line 37; 1040A, line 21; 1040EZ, line 4).	\$ _____	\$ _____
b. All other income (include ALL money received in 2007 that is not included in line (a) above (such as TANF benefits, disability, Social Security, child support).	\$ _____	\$ _____
TOTAL Income for 2007 (Sum of a + b)	\$ _____	\$ _____

The Financial Aid Office will review your income and let you know if you qualify for an **ENROLLMENT FEE WAIVER** under Method B. If you do not qualify using this simple method, you should file a FAFSA.

SPECIAL CLASSIFICATIONS ENROLLMENT FEE WAIVERS

13. Do you have certification from the CA Department of Veterans Affairs that you are eligible for a dependent's fee waiver?
Submit certification. Yes No

14. Do you have certification from the National Guard Adjutant General that you are eligible for a dependent's fee waiver?
Submit certification. Yes No

15. Are you eligible as a recipient of the Congressional Medal of Honor or as a child of a recipient?
Submit documentation from the Department of Veterans Affairs. Yes No

16. Are you eligible as a dependent of a victim of the September 11, 2001, terrorist attack?
Submit documentation from the CA Victim Compensation and Government Claims Board. Yes No

17. Are you eligible as a dependent of a deceased law enforcement/fire suppression personnel killed in the line of duty?
Submit documentation from the public agency employer of record. Yes No

• If you answered "Yes" to any of the questions from 13-17, you are eligible for an **ENROLLMENT FEE WAIVER** and perhaps other fee waivers or adjustments. Sign the Certification below. Contact the Financial Aid Office if you have questions.

CERTIFICATION FOR ALL APPLICANTS: READ THIS STATEMENT AND SIGN BELOW

I hereby swear or affirm, under penalty of perjury, that all information on this form is true and complete to the best of my knowledge. If asked by an authorized official, I agree to provide proof of this information, which may include a copy of my and my spouse/registered domestic partner and/or my parent's/registered domestic partner's 2007 U.S. Income Tax Return(s). I also realize that any false statement or failure to give proof when asked may be cause for the denial, reduction, withdrawal, and/or repayment of my waiver. I authorize release of information regarding this application between the college, the college district, and the Chancellor's Office of the California Community Colleges.

Applicant's Signature _____ Date _____ Parent Signature (Dependent Students Only) _____ Date _____

California Information Privacy Act

State and federal laws protect an individual's right to privacy regarding information pertaining to oneself. The California Information Practices Act of 1977 requires the following information be provided to financial aid applicants who are asked to supply information about themselves. The principal purpose for requesting information on this form is to determine your eligibility for financial aid. The Chancellor's Office policy and the policy of the community college to which you are applying for aid authorize maintenance of this information. Failure to provide such information will delay and may even prevent your receipt of financial assistance. This form's information may be transmitted to other state agencies and the federal government if required by law. Individuals have the right of access to records established from information furnished on this form as it pertains to them.

The officials responsible for maintaining the information contained on this form are the financial aid administrators at the institutions to which you are applying for financial aid. The SSN may be used to verify your identity under record keeping systems established prior to January 1, 1975. If your college requires you to provide an SSN and you have questions, you should ask the financial aid officer at your college for further information. The Chancellor's Office and the California community colleges, in compliance with federal and state laws, do not discriminate on the basis of race, religion, color, national origin, gender, age, disability, medical condition, sexual orientation, domestic partnership or any other legally protected basis. Inquiries regarding these policies may be directed to the financial aid office of the college to which you are applying.

FOR OFFICE USE ONLY

<input type="checkbox"/> BOGFW-A <input type="checkbox"/> TANF/CalWORKs <input type="checkbox"/> SSI/SSP <input type="checkbox"/> GA	<input type="checkbox"/> BOGFW-B <hr style="width: 50px; margin: 0 auto;"/> <input type="checkbox"/> BOGFW-C	<input type="checkbox"/> Special Classification <input type="checkbox"/> Veteran <input type="checkbox"/> National Guard Dependent <input type="checkbox"/> Medal of Honor <input type="checkbox"/> 9/11 Dependent <input type="checkbox"/> Dep. of deceased law enforcement/fire personnel	RDP <input type="checkbox"/> Student <input type="checkbox"/> Parent	<input type="checkbox"/> Student is not eligible
---	---	--	--	--

Comments: _____

Certified by: _____ Date: _____



El Camino College – Compton Center Financial Aid Office

Solicitud para la Exención (fee waiver) del Pago de la Matrícula 2008-2009

Esta es una solicitud para recibir una exención de las cuotas de inscripción. Esta exención (fee waiver) es exclusivamente para residentes de California. Si necesitas ayuda económica para la compra de libros, útiles escolares, alimentos, pago de renta, transportación y otros gastos, por favor de llenar la SOLICITUD GRATUITA DE AYUDA FEDERAL PARA ESTUDIANTES (FAFSA por sus siglas en inglés). La FAFSA está disponible en la red www.fafsa.ed.gov o en la Oficina de la Ayuda Económica. **Nota aclaratoria:** Los estudiantes que han sido exentos del pago de inscripción como no residentes de California, según la Cláusula 68130.5 (AB 540) del Código de Educación no se consideran residentes de California para efectos de esta solicitud. Si tú no eres residente de California, no eres elegible para ser exento del pago de inscripción, por lo tanto, no lenes este formulario. Usted puede aplicar para ayuda económica llenando la solicitud FAFSA.

Nombre: _____ Número de ID #/SSN _____
Apellido Nombre Inicial del Segundo Nombre

Correo electrónico (opcional): _____ Número de Teléfono: (____) _____

Domicilio: _____ Fecha de Nacimiento: ____/____/____
Calle Ciudad Código Postal

¿Ha determinado la Oficina de Registros y Admisiones que es usted residente de California? Sí No

IMPLEMENTACION DEL DECRETO DE CALIFORNIA SOBRE LOS DERECHOS Y RESPONSABILIDADES

El Acta de California sobre Derechos y Responsabilidades de Parejas Domésticas extiende nuevos derechos, beneficios, responsabilidades y obligaciones a las personas que forman parte de una Relación Doméstica Registrada con la Secretaria del Estado de California bajo la sección 297 del Código de Familia. Si tú estas registrado en una relación doméstica bajo Registered Domestic Partnership (RDP por sus siglas en inglés), entonces serás considerado como un estudiante independiente-casado, a fin de determinar la elegibilidad para esta exención de cuotas de inscripción. Debes proveer información sobre tu familia y de los ingresos de tu pareja doméstica. Si eres un estudiante dependiente y tu padre/madre está en una relación de RDP, serás considerado como un estudiante con padres casados, por lo cual también tienes que proveer el ingreso de la pareja doméstica de tu padre/madre.

Nota aclaratoria: Estas cláusulas se aplican sólo a los solicitantes de la ayuda económica estatal y por lo tanto, excluyen a toda ayuda económica federal.

¿Esta Usted (Ud) o su(s) padre/madre viviendo con una pareja registrada como RDP con la Secretaria del Estado de California bajo la cláusula 297 del Código de Familia? (Responde "sí" si su padre/madre están separados de una pareja RDP, SIN HABER PRESENTADO un aviso de Terminación [Notice of Termination of Domestic Partnership] en la Oficina de la Secretaria del Estado de California)? Sí No

Si respondiste "sí" a la pregunta anterior tiene que incluir a su pareja doméstica registrada como cónyuge. Debe de incluir la información familiar y el ingreso destu pareja, o de la pareja doméstica de su padre/madre en las preguntas 3, 6, 7, 8, 9, 10, 11, 12.

Estado Civil del Estudiante: Soltero/a Casado/a Divorciado/a Separado/a Viudo/a Pareja Doméstica Registrada (RDP)

Estado de Dependencia =====

- ¿Nació antes del 1 de enero de 1985? Sí No
- En la actualidad, ¿está casado(a), o vive con una pareja de Relación Doméstica Registrada (RDP)? (Responde "sí" si estás separado pero no divorciado, o si no has presentado un aviso de terminación para disolver tu relación.) Sí No
- ¿Tiene hijos que reciben de Ud más de la mitad de tu manutención, o otros dependientes que viven con Ud (aparte de sus hijos y cónyuge) que reciban de Ud más de la mitad de tu manutención, ahora mismo y hasta el 30 de junio del 2009? Sí No
- ¿Es Ud huérfano, o está bajo la tutela legal o estuvo bajo la tutela legal hasta la edad de los 18 años? Sí No
- ¿Es veterano de las Fuerzas Armadas de los Estados Unidos? Sí No

• Si respondió "sí" a cualquiera de las preguntas del 1 al 5, es considerado estudiante INDEPENDIENTE y deberá proporcionar su información familiar y de ingreso de su cónyuge o RDP, si es aplicable. Pasa a la pregunta #8.

• Si respondió "no" a todas las preguntas del 1 al 5, llene las siguientes preguntas:

- Si su/s padre/s o su RDP presentaron o van a presentar una Declaración de Impuestos del año 2007, ¿fue o será considerado como dependiente de alguno o ambos padres? No presentarán Declaración de Impuestos Sí No
- ¿Vive con alguno o ambos padres, y/o su RDP? Sí No

• Si respondió "no" a las preguntas 1 a 5 y "sí" a la pregunta 6 ó 7, deberá proporcionar la información familiar y los ingresos de su/s padre/s o RDP. Llene las preguntas para estudiantes DEPENDIENTES en las secciones que sigue.

• Si respondió "no" o "su/s padre/s no presentarán" en la pregunta 6 y "no" a la pregunta 7, es Ud un estudiante dependiente para toda la ayuda estudiantil, a excepción de esta solicitud de exención de las cuotas de inscripción. Llene las preguntas que siguen como estudiante INDEPENDIENTE, pero intenta obtener la información de su/s padre/s y presente la solicitud FAFSA para que sea considerado para otro tipo de ayuda económica. No puedes recibir otra ayuda económica sin la información de su/s padre/s.

METODO A =====

- Actualmente, ¿está recibiendo (sólo el estudiante) mensualmente ayuda monetaria de: TANF/CalWORKs? Sí No
SSI/SSP ¿(Programa de Ingreso Suplementario de Seguridad)? Sí No
¿Asistencia General? Sí No

9. Si es estudiante dependiente, ¿están su/s padre/s o RDP recibiendo ayuda monetaria de: TANF/CalWorks, SSI/SSP como fuente principal de sus ingresos? Sí No

Si respondiste "sí" a la pregunta 8 ó 9, eres elegible para una Exención de Cuotas de Inscripción. Firma la certificación al final de este formulario. Se te requerirá mostrar comprobación reciente de beneficios. Solicita a la Oficina de Ayuda Económica una FAFSA para ser elegible para otras oportunidades de ayuda económica.

METODO B

10. **Estudiante Dependiente:** ¿Cuántas personas hay en la familia de Ud/sus padre/s? (incluyéndolo a Ud, sus padre/s y cualquier otra persona que viva con Ud/sus padres o RDP y reciba más del 50% de su manutención, ahora mismo y hasta el 30 de junio del 2009.) _____
11. **Estudiante Independiente:** ¿Cuántas personas hay en su familia? (incluyéndolo a Ud, su cónyuge/RDP y cualquier otra persona que viva con usted y reciba más del 50% de su manutención, ahora mismo y hasta el 30 de junio del 2009.) _____
12. **Información sobre los Ingresos del 2007**

	Estudiante Dependiente: Ingreso del Padre/s o RDP	Estudiante Independiente: Ingreso del Estudiante, cónyuge o RDP
a. Ingreso Bruto Ajustado (Si se presentó la Declaración de Impuestos del 2007, escribe la cantidad del formulario 1040, línea 37; 1040A, línea 21; 1040EZ, línea 4).	\$ _____	\$ _____
b. Todo otro ingreso (Incluye todo el dinero recibido en el 2007 que no está incluido en la líneas de arriba (i.e. beneficios de discapacidad, Seguro Social, pensión alimenticia).	\$ _____	\$ _____
TOTAL de ingresos para el 2007 (Suma de a + b)	\$ _____	\$ _____

La Oficina de Ayuda Económica revisará sus ingresos y le notificará si es elegible para la Exención de Cuotas de Inscripción bajo el Método B. Si no es elegible usando este método sencillo, le recomendamos que llenes la FAFSA.

CLASIFICACIONES ESPECIALES PARA SER EXENTO DEL PAGO DE INSCRIPCIÓN

13. ¿Tiene una Certificación del Departamento de California de Asuntos para Veteranos que establezca que eres un dependiente elegible para esta exención? Entrega comprobación. Sí No
14. ¿Tiene una Certificación de la Guardia Nacional General que establezca que eres un dependiente elegible para esta exención? Entrega comprobación. Sí No
15. ¿Es elegible, como beneficiario de la Medalla de Honor del Congreso o como hijo de alguien quien la recibió? Entrega constancia del Departamento de Asuntos para Veteranos. Sí No
16. ¿Es elegible como dependiente de una víctima de los atentados terroristas del 11 de septiembre del 2001? Entrega documentación del CA Victim Compensation and del Government Claims Board. Sí No
17. Es elegible como dependiente de algún agente del orden/personal de control de incendios, muerto en el cumplimiento de su deber? Entrega documentación de la Agencia pública que haya sido el empleador. Sí No

• Si respondió "sí" a cualquiera de las preguntas de 13 a 17, es elegible para ser exento del pago de Cuotas de Inscripción y tal vez otro tipo de reducción de cuotas. Firme la certificación de abajo. Si tiene preguntas, ponte en contacto con la Oficina de Ayuda Económica.

CERTIFICACION PARA TODOS LOS SOLICITANTES: LEE ESTA DECLARACION Y FIRMA ABAJO

Por medio de la presente juro o afirmo, bajo pena de perjurio, que toda la información en este formulario es verdadera y completa según mi conocimiento. Si personal autorizado me lo pide consiento a ofrecer pruebas relacionadas con esta información, las cuales podría incluir una copia de mi Declaración de Impuestos del 2007, la de mi cónyuge y/o la pareja doméstica registrada de mi padre/madre. También reconozco que cualquier declaración falsa, o el incumplimiento en la presentación de pruebas cuando me sean solicitadas podrían ser causa de negación, reducción o retro y/o devolución de mi exención de cuotas de inscripción. Autorizo el intercambio de información relacionada con esta solicitud entre el colegio, el distrito del colegio y la Oficina del Rector de los Colegios Comunitarios de California.

Firma del solicitante Fecha Firma del padre (Sólo para Estudiantes Dependientes) Fecha

Acta de California de Información y Privacidad

Las leyes federales y estatales protegen el derecho del individuo a la privacidad con respecto a su información personal. El Acta de 1977 de California sobre Prácticas de Información (California Information Practices Act 1977) requiere que la siguiente información sea entregada a todos los solicitantes de la ayuda económica de quienes se les ha pedido proveer su información personal. La información que proporciona en este formulario se usará para determinar si usted tiene el derecho a recibir la ayuda económica. La política de la Oficina del Rector de los Colegios Comunitarios (Chancellor's Office) y la política del colegio comunitario a quien ha solicitado la ayuda económica autoriza el uso de esta información. La omisión de dicha información demoraría y hasta podría prevenirle de recibir la ayuda económica. La información en este formulario podría ser cedida a otros organismos estatales y al gobierno federal, si es requerido por ley. Los individuos tienen el derecho a acceder su historial personal establecido en base a su información personal proveída.

La autoridad responsable de mantener la información incluida en este formulario son los administradores de la ayuda financiera de la institución a la cual está solicitando la ayuda económica. El número de Seguro Social podría ser utilizado para verificar su identidad bajo el sistema de registros establecido antes del 1ro de enero de 1975. Si su colegio comunitario le pide que proporcione su número de Seguro Social y tiene alguna pregunta, pida más información al administrador de la oficina de Ayuda Financiera de su colegio. La Oficina del Rector y los Colegios Comunitarios, de acuerdo con las leyes federales y estatales, no discrimina en base a raza, religión, color, nacionalidad, sexo, edad, incapacidad, condición médica, orientación sexual, relación doméstica registrada, o cualquier otra condición amparada legalmente. Cualquier pregunta sobre estas políticas podrá ser dirigida a la Oficina de Ayuda Financiera del colegio al cual está solicitando.

FOR OFFICE USE ONLY

<input type="checkbox"/> BOGFW-A <input type="checkbox"/> TANF/CalWORKs <input type="checkbox"/> SSI/SSP <input type="checkbox"/> GA	<input type="checkbox"/> BOGFW-B _____ <input type="checkbox"/> BOGFW-C	<input type="checkbox"/> Special Classification <input type="checkbox"/> Veteran <input type="checkbox"/> National Guard Dependent <input type="checkbox"/> Medal of Honor <input type="checkbox"/> 9/11 Dependent <input type="checkbox"/> Dep. of deceased law enforcement/fire personnel	RDP <input type="checkbox"/> Student <input type="checkbox"/> Parent	<input type="checkbox"/> Student is not eligible
---	---	--	--	--

Certified by: _____ Date: _____

2008-2009 BOARD OF GOVERNOR'S FEE WAIVER INFORMATION

PROGRAM BENEFITS	FILING DEADLINES	OTHER INFORMATION
Enrollment Fees Waived	Fall 2008 (8/23/08-12/12/08)	Parent Signature for Dependent Student
Reduced Parking Fees	Winter 2009 (1/07/09-2/10/09)	Method A Documentation Required
Method A—Health Fees Waived *	Spring 2009 (2/14/09-6/12/09)	Processed FAFSA with an EFC
One Application For All 4 Terms	Summer 2009 (6/15/09-8/13/09)	

Method-C (Apply for Federal Pell Grant, Fee Waiver & Other Aid)

Complete the Free Application for Federal Student Aid (FAFSA) online at www.fafsa.ed.gov. Check with your campus Financial Aid Office for available FAFSA Workshops.

- Waive Enrollment Fees
- Determine Federal Pell Grant Maximum Eligibility, Federal Work-Study and Federal Loan Eligibility

Enrollment Status	Units Required	Pell Max. Eligibility
Full Time	12 or more	\$ 4,731 per year
Three-Quarter Time	9-11 units	\$ 3,548 per year
Half-Time	6-8 units	\$ 2,366 per year
Less Than Half-Time	Less than 6 units	\$ 910 per year

Method-A (Apply for Board of Governors Fee Waiver Only)

* Except for Dependent of National Guard

<p>You or your family must receive benefits from one of the following:</p> <ul style="list-style-type: none"> • CalWORKS (AFDC) or Temporary Assistance for Needy Families (TANF) • Supplemental Security Income (SSI) or State Supplementary Program (SSP) • General Assistance (GA) 	<p>Submit one of the following documents:</p> <ul style="list-style-type: none"> • Copy of a <u>current or last</u> month's check for Cal WORKS SSI, SSP, or GA benefits. Current or last month's bank statement with direct deposit of SSI benefit is acceptable documentation. Please submit a PHOTOCOPY of your benefit check or bank statement. • Agency Certification Form, verifying eligibility, with an authorized signature, agency stamp, and <u>current date</u>
--	--

Method-B (Apply for Board of Governors Fee Waiver Only)

<p>You must meet the following qualifying income standards:</p> <table border="1"> <thead> <tr> <th>Number in Household</th> <th>Total Income in 2007</th> </tr> </thead> <tbody> <tr><td>1</td><td>\$ 15,315.00</td></tr> <tr><td>2</td><td>\$ 20,535.00</td></tr> <tr><td>3</td><td>\$ 25,755.00</td></tr> <tr><td>4</td><td>\$ 30,975.00</td></tr> <tr><td>5</td><td>\$ 36,195.00</td></tr> <tr><td>6</td><td>\$ 41,415.00</td></tr> <tr><td>7</td><td>\$ 46,635.00</td></tr> <tr><td>8</td><td>\$ 51,855.00</td></tr> </tbody> </table>	Number in Household	Total Income in 2007	1	\$ 15,315.00	2	\$ 20,535.00	3	\$ 25,755.00	4	\$ 30,975.00	5	\$ 36,195.00	6	\$ 41,415.00	7	\$ 46,635.00	8	\$ 51,855.00	<p>You must meet the following qualifying income standards:</p> <table border="1"> <thead> <tr> <th>Number in Household</th> <th>Total Income in 2007</th> </tr> </thead> <tbody> <tr><td>9</td><td>\$ 57,075.00</td></tr> <tr><td>10</td><td>\$ 62,295.00</td></tr> <tr><td>11</td><td>\$ 67,515.00</td></tr> <tr><td>12</td><td>\$ 72,735.00</td></tr> <tr><td>13</td><td>\$ 77,955.00</td></tr> <tr><td>14</td><td>\$ 83,175.00</td></tr> <tr><td>15</td><td>\$ 88,395.00</td></tr> <tr><td>16</td><td>\$ 93,615.00</td></tr> </tbody> </table>	Number in Household	Total Income in 2007	9	\$ 57,075.00	10	\$ 62,295.00	11	\$ 67,515.00	12	\$ 72,735.00	13	\$ 77,955.00	14	\$ 83,175.00	15	\$ 88,395.00	16	\$ 93,615.00
Number in Household	Total Income in 2007																																				
1	\$ 15,315.00																																				
2	\$ 20,535.00																																				
3	\$ 25,755.00																																				
4	\$ 30,975.00																																				
5	\$ 36,195.00																																				
6	\$ 41,415.00																																				
7	\$ 46,635.00																																				
8	\$ 51,855.00																																				
Number in Household	Total Income in 2007																																				
9	\$ 57,075.00																																				
10	\$ 62,295.00																																				
11	\$ 67,515.00																																				
12	\$ 72,735.00																																				
13	\$ 77,955.00																																				
14	\$ 83,175.00																																				
15	\$ 88,395.00																																				
16	\$ 93,615.00																																				

2008-2009 SOLICITUD PARA EXONERACION DE MATRICULA DE ESTUDIOS COMUNITARIOS DE CALIFORNIA

PROGRAM BENEFITS	FILING DEADLINES	Información Adicional
Costos de Matricula Deferidos	Otoño 2008 (23/8/08 – 12/12/08)	Firma de Padre para Estudiante Dependiente
Costos de Estacionamiento Reducidos	Invierno 2009 (7/1/09 – 10/2/09)	Método A requiere documentación
Método A – Cargo de Salud Deferidos *	Primavera 2009 (14/2/09 – 12/6/09)	FAFSA Procesada
Una Aplicación para 4 Semestres	Verano 2009 (15/6/09 – 13/8/09)	

Método - C (Aplica para Beca Federal Pell, Solicitud para Exoneración de Matricula y otra asistencia financiera)

Llena la Solicitud Gratuita de Ayuda Federal para Estudiantes (FAFSA) a través de Internet en www.fafsa.ed.gov. Consulte con la Oficina de Ayuda Financiera de su campus para talleres de FAFSA disponibles para asistencia en llenar la solicitud.

- Defiere Costos de Inscripción
- Determine elegibilidad máxima para Beca Federal Pell, Programa Federal de Estudio y Trabajo y elegibilidad para Programa de Préstamo Federal

Tiempo de Inscripción	Unidades Requeridos	Elegibilidad Máxima Beca Pell
Tiempo Completo	12 o mas	\$ 4,731 total por año
Tres-Cuartos de Tiempo	9-11 unidades	\$ 3,548 total por año
Medio-Tiempo	6-8 unidades	\$ 2,366 total por año
Menos de Medio-Tiempo	Menos de 6 unidades	\$ 910 total por año

Método – A

(Aplica para Exoneración de Matricula de Estudios Comunitarios de California solamente)

* Excepto los dependientes de la Guardia Nacional

<p>Tu o tu familia recibe uno de los beneficios de los siguientes:</p> <ul style="list-style-type: none"> • CalWORKS (AFDC) o Temporary Assistance for Needy Families (TANF) • Supplemental Security Income (SSI) o State Supplementary Program (SSP) • General Assistance (GA) 	<p>Somete uno de los siguientes documentos:</p> <ul style="list-style-type: none"> • Una copia de una comprobación para el mes actual o pasado de Cal WORKs SSI, SSP, o de GA. El extracto de cuenta del mes actual o pasado con el deposito directo de SSI es documentación aceptable. Por favor somete una FOTOCOPIA de tu extracto del cheque o de cuenta bancaria. • Formulario de <i>Agency Certification</i> verificando elegibilidad con firma autorizada, estampilla de agencia y fecha actual.
--	---

Método – B (Aplica para Exoneración de Matricula de Estudios Comunitarios de California solamente)

Debe de calificar usando los siguientes estándares:

Numero en Hogar	Ingresos Total en 2007
1	\$ 15,315.00
2	\$ 20,535.00
3	\$ 25,755.00
4	\$ 30,975.00
5	\$ 36,195.00
6	\$ 41,415.00
7	\$ 46,635.00
8	\$ 51,855.00

Debe de calificar usando los siguientes estándares:

Numero en Hogar	Ingresos Total en 2007
9	\$ 57,075.00
10	\$ 62,295.00
11	\$ 67,515.00
12	\$ 72,735.00
13	\$ 77,955.00
14	\$ 83,175.00
15	\$ 88,395.00
16	\$ 93,615.00

ONLINE CLASSES

Section #	Course Title & Number	Course Instructor
9483	Anthropology 2 - 3 Units	Staff
9405	Academic Strategies 60 - 1 Unit	Staff
9406	Academic Strategies 60 - 1 Unit	Staff
9300	Business 1A - 4 Units	M. Ahmad
9310	Computer Information Systems 13 - 3 Units	M. Khalilzadeh
9311	Computer Information Systems 13 - 3 Units	M. Khalilzadeh
9312	Computer Information Systems 13 - 3 Units	A. Yahye
9314	Computer Information Systems 13 - 3 Units	M. Sahebame
9315	Computer Information Systems 13 - 3 Units	M. Sahebame
9316	Computer Information Systems 30 - 3 Units	M. Khalilzadeh
9409	Computer Information Systems 142 - 3 Units	A. Namazi
9410	Computer Information Systems 143 - 3 Units	A. Namazi
9830	Contemporary Health 1 - 3 Units	L. Mendoza
9486	History 1A - 3 Units	S. Panski
9490	History 1B - 3 Units	S. Panski
9445	Humanities 1 - 3 Units	R. Page
9368	Law 4 - 4 Units	M. Ahmad
9487	Political Science 2 - 3 Units	Staff
9484	Psychology 5 - 3 Units	H. Williams
9489	Sociology 101 - 3 Units	V. Haynes



**FREE
Breakfast
& Lunch**

**Opportunity
to Win
Prizes**

**Guests are
Welcome**

**Free Parking
in Lot A**

NEW STUDENT WELCOME DAY

**Wednesday, August 26, 2009
8:30 am - 2:30 pm**

***Learn all about Compton Center!
Orientation • Registration • Meet New Friends***

Meet with Academic Advisors • Register for Classes
Meet Faculty Members • Learn about Student Services & Policies
Hear about Campus Life from Students • Attend a Resource Fair
Find out about Financial Aid • Receive your Student ID
Take a Campus Tour

***Check in: 8:30 - 9:00 am in the Gym
Located on the South Side of Campus, near Artesia Blvd.***

RSVP: 310-900-1600, Ext. 2765 or outreach@elcamino.edu

EL CAMINO COLLEGE COMPTON CENTER
1111 E. Artesia Blvd. Compton, CA 90221 • www.compton.edu • 310-900-1600

Academic Strategies

(Division of Humanities 310-900-1600 ext 2235)

Academic Strategies 20ab - 2 Units

Prewriting Workshop

9400 11:00-12:30pm MTWTh Lecture Staff E 39
Section 9400 meets for 5 weeks from: June 15 to July 16, 2009.

Evening Hours

9403 4:30-6:00pm MTWTh Lecture Staff D 34
Section 9403 meets for 5 weeks from: July 20 to August 16, 2009.

Academic Strategies 31ab - 2 Units

Study Techniques

9401 11:00-2:20pm TW Lecture Staff G 31
Section 9401 meets for 5 weeks from: July 21 to August 19, 2009.

Academic Strategies 36ab - 2 Units

Sentence Errors and Punctuation

Evening Hours

9402 4:30-6:00pm MTWTh Lecture Staff D 34
Section 9402 meets for 5 weeks from: June 15 to July 16, 2009.

Academic Strategies 60 - 1 Unit

Strategies for Success in Distance Education

9405 See Distance Education Website Staff ONLINE
12:30-2:30pm M Lecture Staff E 32
Section 9405 is a Distance Education course that includes on-campus class meetings. The first class meeting is Monday, June 22, from 12:30 p.m. to 2:30 p.m. in E 32. Before the session begins, you must obtain the Student Handbook for Online Courses available in the Distance Education Office or on the Distance Education website. For more information, visit the Distance Education website. Section 9405 meets for 4 weeks from: June 22 to July 17, 2009.

Evening Hours

9406 See Distance Education Website Staff ONLINE
6:00-8:00pm T Lecture Staff E 32
Section 9406 is a Distance Education course that includes on-campus class meetings. The first class meeting is Tuesday, July 28, from 6:00 p.m. to 8:00 p.m. in E 32. Before the session begins, you must obtain the Student Handbook for Online Courses available in the Distance Education Office or on the Distance Education website. For more information, visit the Distance Education website. Section 9406 meets for 4 weeks from: July 28 to August 21, 2009.

Anatomy

(Division of Natural Sciences 310-900-1600 ext 2332)

Anatomy 30 - 4 Units

Essentials of Anatomy and Physiology

Recommended Preparation: English 84

9101 2:00-3:01pm MTWTh Lecture E. Wallano MS 103
3:05-6:15pm MTWTh Lab E. Wallano MS 110
Section 9101 meets for 8 weeks from: June 22 to August 13, 2009.

Anatomy 32 - 4 Units (CAN BIOL 10)

General Human Anatomy

Recommended Preparation: Anatomy 30 or Biology 10 or Biology 1A; English 84

9103 7:00-8:01am MTWTh Lecture F. Aasi MS 103
8:05-11:15am MTWTh Lab F. Aasi MS 110
Section 9103 meets for 8 weeks from: June 22 to August 13, 2009.
9102 10:00-11:01am MTWTh Lecture A. Osanyinpeju MS 103
11:30-2:40pm MTWTh Lab A. Osanyinpeju MS 110
Section 9102 meets for 8 weeks from: June 22 to August 13, 2009.

Evening Hours

9104 5:30-6:31pm MTWTh Lecture A. Osanyinpeju MS 110
6:45-9:55pm MTWTh Lab A. Osanyinpeju MS 110
Section 9104 meets for 8 weeks from: June 22 to August 13, 2009.

Anthropology

(Division of Behavioral & Social Sciences 310-900-1600 ext 2210)

Anthropology 2 - 3 Units (CAN ANTH 4)

Introduction to Cultural Anthropology

Recommended Preparation: eligibility for English 1A

9483 See Distance Education Website Staff ONLINE
Section 9483 is a Distance Education online course. You must attend the first class meeting on Wednesday, June 24, from 6:00 p.m. to 7:30 p.m., in E 10 or you may be dropped from the course. Before the session begins, you must obtain the Student Handbook for Online courses available in the Distance Education Office or on the Distance Education website. Section 9483 meets for 8 weeks from: June 22 to August 13, 2009.

Art

(Division of Fine Arts 310-900-1600 ext 2210)

Art 1 - 3 Units

Art and Visual Culture in Modern Life

Recommended Preparation: eligibility for English 1A

9500 8:00-10:25am MTWTh Lecture Staff D 42
Section 9500 meets for 5 weeks from: July 20 to August 20, 2009.
9501 11:00-1:25pm MTWTh Lecture V. De Silva D 42
Section 9501 meets for 5 weeks from: June 15 to July 16, 2009.
9502 11:00-1:25pm MTWTh Lecture V. De Silva Y 99
Section 9502 meets for 5 weeks from: July 20 to August 20, 2009.

Art 9 - 3 Units

History of African Art

Recommended Preparation: eligibility for English 1A

9504 1:30-3:55pm MTWTh Lecture V. De Silva D 42
Section 9504 meets for 5 weeks from: June 15 to July 16, 2009.
9503 1:30-3:55pm MTWTh Lecture V. De Silva D 42
Section 9503 meets for 5 weeks from: July 20 to August 20, 2009.

Astronomy

(Division of Natural Sciences 310-900-1600 ext 2332)

Astronomy 12 - 1 Unit

Astronomy Laboratory

Prerequisite: Astronomy 20 or Astronomy 25 with a minimum grade of C in prerequisite or concurrent enrollment

Note: Students should bring a flashlight to the first class meeting.

Evening Hours

9110 7:00-9:25pm MTWTh Lab W. Keig MS 126
Section 9110 meets for 5 weeks from: July 20 to August 20, 2009.

Astronomy 20 - 3 Units

The Solar System

Recommended Preparation: eligibility for English 84

Evening Hours

9112 7:00-9:25pm MTWTh Lecture M. Khan MS 126
Section 9112 meets for 5 weeks from: June 15 to July 16, 2009.

Automotive Collision Repair/Painting

(Division of Industry & Technology 310-900-1600 ext 2620)

Automotive Collision Repair/Painting 6abcd - 3 Units

Automotive Collision Repair Applications

9718 7:00-10:20am MT Lecture W. Bentley VT 187
10:20-4:20pm MT Lab W. Bentley VT 187
Section 9718 meets for 5 weeks from: June 15 to July 14, 2009.

Section #	Time	Instructor	Room #
-----------	------	------------	--------

Automotive Technology

(Division of Industry & Technology 310-900-1600 ext 2620)

Automotive Technology 1 - 2 Units

Introduction to Automotive Service

9723	1:00-2:30pm MTWTh Lecture	F. Lamm	VT 188
	2:30-4:00pm MTWTh Lab	F. Lamm	VT 188

Section 9723 meets for 5 weeks from: June 15 to July 16, 2009.

Automotive Technology 43 - 4 Units

Introduction to Engine Repair

Recommended Preparation: Automotive Technology 1 or equivalent

9722	8:00-9:25am MTWTh Lecture	C. Garrett	VT 188
	9:25-10:50am MTWTh Lab	C. Garrett	VT 188

Section 9722 meets for 8 weeks from: June 22 to August 13, 2009.

Automotive Technology 81 - 3 Units

Automotive Air Conditioning

9724	7:00-10:20am WTh Lecture	W. Bentley	VT 188
	10:30-5:30pm WTh Lab	W. Bentley	VT 188

Section 9724 meets for 5 weeks from: June 15 to July 16, 2009.

Automotive Technology 99abc - 1-3 Units

Independent Study

Enrollment Limitation: Two courses in Automotive Technology with a minimum grade of B in each and acknowledgement by the instructor with whom the student will work

Note: Refer to the El Camino College Catalog for eligibility requirements.

9721	10:30-1:00pm MTWTh Lab	F. Lamm	
------	------------------------	---------	--

Section 9721 meets for 5 weeks from: June 15 to July 16, 2009.

Biology

(Division of Natural Sciences 310-900-1600 ext 2332)

Biology 10 - 4 Units

Fundamentals of Biology

Recommended Preparation: English 84

9140	8:00-9:25am MTWTh Lecture	H. Onwudiwe	MS 108
	9:30-10:55am MTWTh Lab	H. Onwudiwe	MS 108

Section 9140 meets for 8 weeks from: June 22 to August 13, 2009.

Evening Hours

9142	5:30-6:55pm MTWTh Lecture	Staff	MS 108
	7:00-8:25pm MTWTh Lab	Staff	MS 108

Section 9142 meets for 8 weeks from: June 22 to August 13, 2009.

Biology 15 - 3 Units

Environmental Aspects of Biology

Recommended Preparation: eligibility for English 84

9144	8:00-10:25am MTWTh Lecture	Staff	MS 105
------	----------------------------	-------	--------

Section 9144 meets for 5 weeks from: June 15 to July 16, 2009.

Evening Hours

9146	4:30-6:55pm MTWTh Lecture	Staff	MS 129
------	---------------------------	-------	--------

Section 9146 meets for 5 weeks from: June 15 to July 16, 2009.

Business

(Division of Business 310-900-1600 ext 2271)

Business 11 - 3 Units

Accounting for Small Business

Recommended Preparation: eligibility for English 84

Note: Not open to the student who has credit for or is currently enrolled in Business 1A. Not recommended for the student who has completed two years of high school bookkeeping.

9303	8:00-10:25am MTWTh Lecture	R. Joiner	VT 131
------	----------------------------	-----------	--------

Section 9303 meets for 5 weeks from: June 15 to July 16, 2009.

Section #	Time	Instructor	Room #
-----------	------	------------	--------

Business 1A - 4 Units (CAN BUS 2)

Financial Accounting

Recommended Preparation: eligibility for English 1A

9301	10:30-11:55am MTWTh Lecture	R. Joiner	VT 131
	11:55-12:40pm MTWTh Lab	R. Joiner	VT 131

Section 9301 meets for 8 weeks from: June 22 to August 13, 2009.

9300	See Distance Education Website	M. Ahmad	ONLINE
------	--------------------------------	----------	--------

Section 9300 is a Distance Education online course. The first class meeting is Wednesday, June 24 from 11:00 a.m. to 12:00 p.m. or 6:00 p.m. to 7:00 p.m., in VT 125. You must attend this meeting or you may be dropped from the course. Before the session begins, you must obtain the Student Handbook for Online Courses available in the Distance Education Office or on the Distance Education website. Section 9300 meets for 8 weeks from: June 22 to August 13, 2009.

Business 20 - 3 Units

Business Management

Recommended Preparation: eligibility for English 84

9306	8:00-10:25am MTWTh Lecture	R. Joiner	VT 131
------	----------------------------	-----------	--------

Section 9306 meets for 5 weeks from: July 20 to August 20, 2009.

Business 27 - 3 Units

Effective English for Business

Prerequisite: eligibility for English 1A

Evening Hours

9321	5:00-7:25pm MTWTh Lecture	R. Murray	VT 127
------	---------------------------	-----------	--------

Section 9321 meets for 5 weeks from: June 15 to July 16, 2009.

Business 28 - 3 Units

Written Business Communications

Prerequisite: eligibility for English 1A

9322	8:00-10:25am MTWTh Lecture	D. Ross	VT 226A
------	----------------------------	---------	---------

Section 9322 meets for 5 weeks from: July 20 to August 20, 2009.

Business 29 - 3 Units

Oral Business Communications

Recommended Preparation: eligibility for English A

Evening Hours

9324	5:00-7:25pm MTWTh Lecture	R. Murray	VT 127
------	---------------------------	-----------	--------

Section 9324 meets for 5 weeks from: July 20 to August 20, 2009.

Business 52A - 2 Units

Microsoft Word Applications I

Recommended Preparation: eligibility for English 84; keyboarding skill is strongly recommended

9308	9:00-10:01am MW Lecture	A. Garcia	VT 212B
	10:05-11:06am MTWTh Lab	A. Garcia	VT 212B

Section 9308 meets for 8 weeks from: June 22 to August 13, 2009.

Business 60A - 1 Unit

Microcomputer Keyboarding

9309	12:00-1:30pm M Lecture	A. Garcia	VT 212B
	12:00-1:30pm TWTh Lab	A. Garcia	VT 212B

Section 9309 meets for 5 weeks from: June 15 to July 16, 2009.

Chemistry

(Division of Natural Sciences 310-900-1600 ext 2332)

Chemistry 20 - 5 Units

Fundamentals of Chemistry

Prerequisite: Mathematics 40 or 41B with a minimum grade of C in prerequisite or qualification by testing (El Camino College Mathematics Placement Test) and assessment

Recommended Preparation: eligibility for English 84

Note: Credit will not be given to a student who has completed Chemistry 1A.

9116	8:00-10:05am MTWTh Lecture	H. Wu	MS 231
	10:30-11:55am MTWTh Lab	H. Wu	MS 231

Section 9116 meets for 8 weeks from: June 22 to August 13, 2009.

Childhood Education

(Division of Behavioral & Social Sciences 310-900-1600 ext 2700)

Child Development 3 - 3 Units

Child Development

Recommended Preparation: eligibility for English 1A

9203 8:00-10:25am MTWTh Lecture P. West AS 7
Section 9203 meets for 5 weeks from: June 15 to July 16, 2009.

Evening Hours

9204 6:00-8:25pm MTWTh Lecture R. Most AS 7
Section 9204 meets for 5 weeks from: July 20 to August 20, 2009.

Child Development 4 - 3 Units

Survey of Children with Special Needs

Prerequisite: Child Development 3 with a minimum grade of C

9206 11:00-1:25pm MTWTh Lecture H. Hathman E 19
Section 9206 meets for 5 weeks from: July 20 to August 20, 2009.

Evening Hours

9205 6:00-8:25pm MTWTh Lecture Staff E 19
Section 9205 meets for 5 weeks from: June 15 to July 16, 2009.

Child Development 9 - 3 Units

The Home, the School, the Community

Recommended Preparation: eligibility for English 1A

9213 8:00-10:25am MTWTh Lecture S. Scranton E 19
Section 9213 meets for 5 weeks from: July 20 to August 20, 2009.

Child Development 110 - 3 Units

Child Health and Safety

Recommended Preparation: eligibility for English 1A

Note: In order to complete all requirements for AB 243 you must take both Child Development 10 and 11.

9214 8:00-10:25am MTWTh Lecture J. Quinones E 19
Section 9214 meets for 5 weeks from: June 15 to July 16, 2009.

Evening Hours

9215 6:00-8:25pm MTWTh Lecture S. Scranton E 19
Section 9215 meets for 5 weeks from: July 20 to August 20, 2009.

Child Development 117 - 3 Units

Music and Movement for Young Children

Prerequisite: Child Development 3 with a minimum grade of C or equivalent or concurrent enrollment

Note: formerly Child Development 17

9217 11:00-1:25pm MTWTh Lecture L. Taylor E 19
Section 9217 meets for 5 weeks from: June 15 to July 16, 2009.

CNC Programming

(See Machine Tool Technology)

Computer Information Systems

(Division of Business 310-900-1600 ext 2271)

Computer Information Systems 13 - 3 Units (CAN BUS 6)

Introduction to Computers

Recommended Preparation: eligibility for English 84

9311 See Distance Education Website M. Khalizadeh ONLINE
Section 9311 is a Distance Education online course. The first class meeting is Monday, June 22, from 10:00 a.m. to 1:00 p.m. or 5:00 p.m. to 7:00 p.m., in VT 125. Before the session begins, you must obtain the Student Handbook for Online Courses available in the Distance Education Office or on the Distance Education website. For more information, visit the Distance Education website. Section 9311 meets for 8 weeks from: June 22 to August 13, 2009.

Evening Hours

9320 6:00-7:30pm MTWTh Lecture A. Yahye VT 124
7:30-9:55pm MTWTh Lab A. Yahye VT 124
Section 9320 meets for 5 weeks from: July 20 to August 20, 2009.

9310 See Distance Education Website M. Khalizadeh ONLINE
Section 9310 is a Distance Education online course. The first class meeting is Monday, June 22, from 10:00 a.m. to 1:00 p.m. or 5:00 p.m. to 7:00 p.m., in VT 125. Before the session begins, you must obtain the Student Handbook for Online Courses available in the Distance Education Office or on the Distance Education website. For more information, visit the Distance Education website. Section 9310 meets for 8 weeks from: June 22 to August 13, 2009.

9312 See Distance Education Website A. Yahye ONLINE
Section 9312 is a Distance Education online course. The first class meeting is Thursday, June 18, from 12:00 p.m. to 1:00 p.m. or 6:00 p.m. to 7:00 p.m., in VT 124. Before the session begins, you must obtain the Student Handbook for Online Courses available in the Distance Education Office or on the Distance Education website. For more information, visit the Distance Education website. Section 9312 meets for 5 weeks from: June 15 to July 16, 2009.

9314 See Distance Education Website M. Sahebame ONLINE
Section 9314 is a Distance Education online course. The first class meeting is Tuesday, June 16, from 12:00 p.m. to 1:00 p.m. or 6:00 p.m. to 7:00 p.m., in VT 126. Before the session begins, you must obtain the Student Handbook for Online Courses available in the Distance Education Office or on the Distance Education website. For more information, visit the Distance Education website. Section 9314 meets for 5 weeks from: June 15 to July 16, 2009.

9315 See Distance Education Website M. Sahebame ONLINE
Section 9315 is a Distance Education online course. The first class meeting is Tuesday, June 16, from 12:00 p.m. to 1:00 p.m. or 6:00 p.m. to 7:00 p.m., in VT 126. Before the session begins, you must obtain the Student Handbook for Online Courses available in the Distance Education Office or on the Distance Education website. For more information, visit the Distance Education website. Section 9315 meets for 5 weeks from: June 15 to July 16, 2009.

Computer Information Systems 30 - 3 Units

Introduction to eCommerce

Recommended Preparation: Computer Information Systems 13; eligibility for English 84

9316 See Distance Education Website M. Khalizadeh ONLINE
Section 9316 is a Distance Education online course. The first class meeting is Monday, June 22, from 10:00 a.m. to 1:00 p.m. or 5:00 p.m. to 7:00 p.m., in VT 125. Before the session begins, you must obtain the Student Handbook for Online Courses available in the Distance Education Office or on the Distance Education website. For more information, visit the Distance Education website. Section 9316 meets for 8 weeks from: June 22 to August 13, 2009.

Computer Information Systems 142 - 3 Units

Implementing and Administering Network Routers Cisco 3

Prerequisite: Computer Information Systems 141 with a minimum grade of C or equivalent (Successful completion of Cisco CCNA "Semesters 1 and 2 is an equivalent.)

9409 See Distance Education Website A. Namazi ONLINE
Section 9409 is a Distance Education online course. There are no scheduled meetings on campus. You must contact the instructor at anamazi_a@elcamino.edu or call (310) 900-1600 ext 2250 before the start of the session or you may be dropped from the course. Before the session begins, you must obtain the Student Handbook for Online Courses available in the Distance Education Office or on the Distance Education website. For more information, visit the Distance Education website. Section 9409 meets for 5 weeks from: June 15 to July 16, 2009.

Computer Information Systems 143 - 3 Units

LAN and WAN Router Configurations Cisco 4

Prerequisite: Computer Information Systems 142 with a minimum grade of C or equivalent (Successful completion of Cisco CCNA "Semesters" 1, 2, and 3 is an equivalent.)

9410 See Distance Education Website A. Namazi ONLINE
Section 9410 is a Distance Education online course. There are no scheduled meetings on campus. You must contact the instructor at anamazi_a@elcamino.edu or call (310) 900-1600 ext 2250 before the start of the session or you may be dropped from the course. Before the session begins, you must obtain the Student Handbook for Online Courses available in the Distance Education Office or on the Distance Education website. For more information, visit the Distance Education website. Section 9410 meets for 5 weeks from: July 20 to August 20, 2009.

Section #	Time	Instructor	Room #
-----------	------	------------	--------

Contemporary Health

(Division of Health Sciences & Athletics 310-900-1600 ext 2273)

Contemporary Health 1 - 3 Units

Personal and Community Health Issues

Recommended Preparation: eligibility for English A or 84

9832	11:00-1:25pm MTWTh Lecture	L. Biffle	V 70
Section 9832 meets for 5 weeks from: July 20 to August 20, 2009.			
9835	9:30-10:55am MTWTh Lecture	D. Collins	V 70
Section 9835 meets for 8 weeks from: June 22 to August 13, 2009.			

Evening Hours

9834	6:00-8:25pm MTWTh Lecture	A. Turner	V 70
Section 9834 meets for 5 weeks from: June 15 to July 16, 2009.			
9830	See Distance Education Website	L. Mendoza	ONLINE
Section 9830 is a Distance Education online course. You must attend the first class meeting on Monday, June 15, from 6:00 p.m. to 7:30 p.m., in VT 124 or you may be dropped from the course. Before the session begins, you must obtain the Student Handbook for Online Courses available in the Distance Education Office or on the Distance Education website. Section 9830 meets for 5 weeks from: June 15 to July 17, 2009.			

Cosmetology

(Division of Industry & Technology 310-900-1600 ext 2273)

Cosmetology 2abcd - 8 Units

Advanced Cosmetology Procedures

Prerequisite: Cosmetology 1 with a minimum grade of C or completion of 399 hours at a school licensed by the State Board of Cosmetology

9076	8:00-9:10am MTWThF Lecture	Staff	UCB1
	9:20-12:30pm MTWThF Lab	Staff	UCB1
	1:15-4:25pm MTWThF Lab	Staff	UCB1
Students must attend an orientation at the Cosmetology location of their choice, and then obtain a permit from the office of Vocational Technology at the Compton Center. This class will be held at the Universal Beauty College, 718 W. Compton Blvd., Compton, CA 90220. Section 9076 meets for 8 weeks from: June 22 to August 14, 2009.			

9077	8:00-9:10am MTWThF Lecture	Staff	UCB2
	9:20-12:30pm MTWThF Lab	Staff	UCB2
	1:15-4:25pm MTWThF Lab	Staff	UCB2
Students must attend an orientation at the Cosmetology location of their choice, and then obtain a permit from the office of Vocational Technology at the Compton Center. This class will be held at the Universal Beauty College, 8619 S. Vermont Ave., Los Angeles, CA 90044. Section 9077 meets for 8 weeks from: June 22 to August 14, 2009.			

Cosmetology 16abcd - 4 Units

Cosmetology Applications

Prerequisite: Cosmetology 1 or 10 with a minimum grade of C in prerequisite or equivalent

Evening Hours

9074	4:50-6:50pm MTWTh Lab	Staff	UCB1
	7:00-7:50pm MTWTh Lecture	Staff	UCB1
	8:00-9:50pm MTWTh Lab	Staff	UCB1
This class will be held at the Universal Beauty College, 718 W. Compton Blvd., Compton, CA 90220. Section 9074 meets for 8 weeks from: June 22 to August 13, 2009.			

Section #	Time	Instructor	Room #
-----------	------	------------	--------

9075	4:50-6:50pm MTWTh Lab	Staff	UCB2
	7:00-7:50pm MTWTh Lecture	Staff	UCB2
	8:00-9:50pm MTWTh Lab	Staff	UCB2
This class will be held at the Universal Beauty College, 8619 S. Vermont Ave., Los Angeles, CA 90044. Section 9075 meets for 8 weeks from: June 22 to August 13, 2009.			

Dance

(Division of Fine Arts 310-900-1600 ext 2210)

Dance 19ab - 2 Units

Beginning Dance

9521	1:00-2:30pm MW Lecture	M. Phillips	X 21
	2:30-4:55pm MTWTh Lab	M. Phillips	X 21
Section 9521 meets for 5 weeks from: July 20 to August 20, 2009.			

Dance 21abcd - 2 Units

Pilates Mat Class

9523	12:30-1:15pm MTWTh Lecture	C. Taul	X 21
	1:15-3:40pm MTWTh Lab	C. Taul	X 21
Section 9523 meets for 5 weeks from: June 15 to July 16, 2009.			

Dance 22ab - 2 Units

Jazz Dance I

Recommended Preparation: one semester of Dance 19ab

9524	9:00-10:30am MW Lecture	Staff	X 21
	10:30-12:55pm MTWTh Lab	Staff	X 21
Section 9524 meets for 5 weeks from: July 20 to August 20, 2009. Section 9524 is combined with Section 9525.			

Dance 23abcd - 2 Units

Jazz Dance II

Prerequisite: one semester of Dance 22ab with a minimum grade of C or equivalent

9525	9:00-10:30am MW Lecture	Staff	X 21
	10:30-12:55pm MTWTh Lab	Staff	X 21
Section 9525 meets for 5 weeks from: July 20 to August 20, 2009. Section 9525 is combined with Section 9524.			

Distance Education

See Distance Education Website

<http://www.Compton.edu/Academics/DistanceEducation>

(310-900-1600 ext 2784 or 310-660-6453)

The following courses are offered online, by television, and/or videotape (telecourses).

Online students must have at a minimum: regular access to the Internet and a computer (either a PC with Windows and a Pentium processor or a Macintosh with at least system 9.0), a recent version of a web browser such as Netscape Navigator or Microsoft Explorer, an Internet Service Provider, an email address, and current word processing software as required by the instructor. Some courses may have additional requirements. Computer literacy and experience with computer communication is recommended. Students may use campus computer labs for work in online courses.

Many instructors hold a first class meeting on campus. Students who do not attend the meeting may be dropped by the instructor. Additional on campus meetings may be required. For more information, see the Student Handbooks on our website or contact our office. (See the Distance Education Website for more details.)

Distance Education

www.Compton.edu/Academics/DistanceEducation

Distance Education courses are ideal for those who are looking for a convenient way to take courses. The course content, course credit, and cost per unit is the same as equivalent courses offered on campus. Anyone who is eligible to take courses on campus may enroll in Distance Education courses.

It is strongly recommended that students review the Distance Education Web site at :

www.Compton.edu/Academics/DistanceEducation for additional information regarding requirements, procedures, and other program material. A short assessment is available on the Web site designed to help students determine if they are ready to successfully take college level courses at a distance.

Economics

(Division of Behavioral & Social Sciences 310-900-1600 ext 2210)

Economics 1 - 3 Units (CAN ECON 2)

Principles of Economics: Macroeconomics

Recommended Preparation: Economics 5 with a minimum grade of C; Mathematics 70; eligibility for English 1A

Evening Hours

9228 6:00-8:25pm MTWTh Lecture Staff E 39
Section 9228 meets for 5 weeks from: June 15 to July 16, 2009.

Economics 2 - 3 Units (CAN ECON 4)

Principles of Economics: Microeconomics Theory

Prerequisite: Economics 1 with a minimum grade of C

9229 8:00-10:25am MTWTh Lecture Staff E 33
Section 9229 meets for 5 weeks from: July 20 to August 20, 2009.

EMT - Emergency Medical Technician

(See Fire and Emergency Technology)

English

(Division of Humanities 310-900-1600 ext 2235)

Note: Students must take the English Placement Test to help with the assessment of appropriate skill levels before enrolling in English 80, 82, 84, B, A, 1A, or 72. A student seeking further review of a placement recommendation may obtain appropriate forms through the Counseling Office. Students who earned a 'C' or better in a prerequisite course at another college are not required to take the English Placement Test. These students must present a grade slip or transcript at registration to verify that the prerequisite has been satisfied at another institution. SAT scores may be substituted for the English Placement Test scores. Students should see their counselors for further information.

English 80 - 3 Units

Basic Language Skills

Recommended Preparation: qualification by testing (English Placement Test) and assessment

Note: formerly English RA

9603 8:00-10:01am MTWTh Lecture Staff D 40
10:05-11:06am MWF Lab Staff F 39
Section 9603 meets for 5 weeks from: July 20 to August 20, 2009.

9601 11:00-1:20pm MTWTh Lecture Staff D 40
1:05-2:06pm MWF Lab Staff F 39
Section 9601 meets for 5 weeks from: June 15 to July 16, 2009.

9620 11:00-1:05pm MTW Lecture Staff VT 186
11:00-1:05pm Th Lab Staff F 39
Section 9620 meets for 8 weeks from: June 22 to August 13, 2009.

English 82 - 3 Units

Introduction to Reading Skills

Prerequisite: credit in English 80 or qualification by testing (English Placement Test) and assessment

Note: formerly English R

9613 7:50-9:51am MTWTh Lecture P. McLaughlin D 33
9:51-10:52am TTh Lab P. McLaughlin F 39
Section 9613 meets for 5 weeks from: July 20 to August 20, 2009.

9604 12:00-2:01pm MTWTh Lecture P. McLaughlin D 33
2:05-3:06pm MWF Lab P. McLaughlin F 39
Section 9604 meets for 5 weeks from: June 15 to July 16, 2009.

9615 2:00-3:25pm MTWTh Lecture Staff D 40
3:25-4:26pm TTh Lab Staff F 39
Section 9615 meets for 8 weeks from: June 22 to August 13, 2009.

Evening Hours

9605 6:00-9:20pm MTTh Lecture Staff D 40
6:00-9:20pm W Lab Staff F 39
Section 9605 meets for 5 weeks from: June 15 to July 16, 2009.

9612 6:00-9:20pm MTTh Lecture Staff D 40
6:00-9:20pm W Lab Staff F 39
Section 9612 meets for 5 weeks from: July 20 to August 20, 2009.

English 84 - 3 Units

Developmental Reading and Writing

Prerequisite: credit in English 82 or qualification by testing (English Placement Test) and assessment

Note: formerly English 2R

9614 8:00-9:25am MTWTh Lecture Staff E 38
9:25-10:26am TTh Lab Staff F 39
Section 9614 meets for 8 weeks from: June 22 to August 13, 2009.

9616 9:30-11:31am MTWTh Lecture P. McLaughlin E 38
8:00-9:30am TTh Lab P. McLaughlin F 39
Section 9616 meets for 5 weeks from: June 15 to July 16, 2009.

9617 11:00-1:01pm MTWTh Lecture P. McLaughlin D 40
1:05-2:06pm MW Lab P. McLaughlin F 39
Section 9617 meets for 5 weeks from: July 20 to August 20, 2009.

Evening Hours

9618 6:00-9:20pm MWTh Lecture Staff E 38
6:00-9:20pm T Lab Staff F 39
Section 9618 meets for 5 weeks from: June 15 to July 16, 2009.

English C - 3 Units

Basic English Skills

Recommended Preparation: qualification by testing (English Placement Test) and assessment

9623 8:00-9:01am MTWTh Lecture Staff D 32
9:05-10:06am MTWTh Lab Staff D 32
Section 9623 meets for 8 weeks from: June 22 to August 13, 2009.

9619 8:00-9:15am MTWThF Lecture Staff D 34
9:15-10:30am MTWThF Lab Staff D 34
Section 9619 meets for 5 weeks from: July 20 to August 21, 2009.

9622 11:00-12:15pm MTWThF Lecture Staff E 32
12:15-1:30pm MTWThF Lab Staff E 32
Section 9622 meets for 5 weeks from: July 20 to August 21, 2009.

Evening Hours

9621 6:00-9:20pm MW Lecture Staff D 32
6:00-9:20pm TTh Lab Staff D 32
Section 9621 meets for 5 weeks from: June 15 to July 16, 2009.

English B - 3 Units

Introduction to the Composing Process

Recommended Preparation: qualification by testing (English Placement Test) and assessment

9627 8:00-9:15am MTWThF Lecture R. Roach C 39
9:15-10:30am MTWThF Lab R. Roach C 39
Section 9627 meets for 5 weeks from: July 20 to August 21, 2009.

9624 11:00-12:30pm MTWTh Lecture J. Bernaudo D 34
12:30-2:00pm MTWTh Lab J. Bernaudo D 34
Section 9624 meets for 5 weeks from: June 15 to July 17, 2009.

9625 11:00-1:05pm MW Lecture Staff E 33
11:00-1:05pm TTh Lab Staff E 33
Section 9625 meets for 8 weeks from: June 22 to August 13, 2009.

Evening Hours

9626 6:00-9:20pm MW Lecture Staff E 33
6:00-9:20pm TTh Lab Staff E 33
Section 9626 meets for 5 weeks from: June 15 to July 16, 2009.

English A - 3 Units

Writing the College Essay

Prerequisite: Credit in English B or qualification by testing (English Placement Test) and assessment

9630 8:00-9:15am MTWThF Lecture Staff C 39
9:15-10:30am MTWThF Lab Staff C 39
Section 9630 meets for 5 weeks from: June 15 to July 17, 2009.

9633 11:00-12:30pm MTWTh Lecture Staff C 39
12:30-2:00pm MTWTh Lab Staff C 39
Section 9633 meets for 5 weeks from: July 20 to August 21, 2009.

9634 11:00-12:30pm MTWTh Lecture R. Roach D 33
12:30-2:00pm MTWTh Lab R. Roach D 33
Section 9634 meets for 5 weeks from: July 20 to August 21, 2009.

9631 2:00-4:05pm MW Lecture T. Norton E 10
2:00-4:05pm TTh Lab T. Norton E 10
Section 9631 meets for 8 weeks from: June 22 to August 13, 2009.

Evening Hours

9632 6:00-9:20pm MW Lecture Staff C 39
6:00-9:20pm TTh Lab Staff C 39
Section 9632 meets for 5 weeks from: June 15 to July 16, 2009.

Section #	Time	Instructor	Room #
-----------	------	------------	--------

English 1A - 4 Units (CAN ENGL 2)

Reading and Composition

Prerequisite: Credit in English A and credit in English 84 or English 7; or qualification by testing (English Placement Test) and assessment

9640 8:00-11:20am MTWTh Lecture R. Roach D 33
Section 9640 meets for 5 weeks from: June 15 to July 16, 2009.

9642 11:00-2:20pm MTWTh Lecture Staff D 41
Section 9642 meets for 5 weeks from: July 20 to August 20, 2009.

Evening Hours

9641 6:00-9:20pm MTWTh Lecture Staff D 33
Section 9641 meets for 5 weeks from: June 15 to July 16, 2009.

9643 6:00-9:20pm MTWTh Lecture Staff E 10
Section 9643 meets for 5 weeks from: July 20 to August 20, 2009.

English 1B - 3 Units (CAN ENGL 4)

Literature and Composition

Prerequisite: English 1A with a minimum grade of C

9646 8:00-10:25am MTWTh Lecture J. Bernaudo D 34
Section 9646 meets for 5 weeks from: June 15 to July 16, 2009.

9647 11:00-1:25pm MTWTh Lecture T. Wasserberger D 34
Section 9647 meets for 5 weeks from: July 20 to August 20, 2009.

Evening Hours

9648 6:00-9:25pm MTWTh Lecture T. Wasserberger D 33
Section 9648 meets for 5 weeks from: July 20 to August 20, 2009.

English 1C - 3 Units

Critical Thinking and Composition

Prerequisite: English 1A with a minimum grade of C

Note: This course satisfies the critical thinking/English composition requirement of IGETC and the critical thinking requirement of the CSU transfer pattern.

9650 10:30-12:55pm MTWTh Lecture T. Subramaniam D 32
Section 9650 meets for 5 weeks from: June 15 to July 16, 2009.

English 24A - 3 Units

Creative Writing: Introduction to Poetry

Recommended Preparation: eligibility for English 1A

9628 12:00-2:25pm MTWTh Lecture D. Maruyama D 41
Section 9628 meets for 5 weeks from: June 15 to July 16, 2009.

English as a Second Language

(Division of Humanities 310-900-1600 ext 2235)

Note: Students must take the ESL Placement Test to help with the assessment of appropriate skill levels before enrolling in ESL classes. A student seeking review of a placement recommendation may obtain appropriate forms through the Counseling Office. ESL classes taken at another college cannot be used for placement in the ESL program.

English as a Second Language 02A - 0 Units

Conversation and Grammar Level I

Recommended Preparation: concurrent enrollment in English as a Second Language 03A

9671 8:00-11:20am MTWThF Lecture A. Cortez-Perez G 31
Section 9671 meets for 5 weeks from: June 15 to July 17, 2009.

9686 8:00-11:20am MTWThF Lecture Staff F 31
Section 9686 meets for 5 weeks from: July 20 to August 21, 2009.

Evening Hours

9673 5:30-9:45pm MTWTh Lecture A. Cortez-Perez G 31
Section 9673 meets for 5 weeks from: June 15 to July 16, 2009.

9687 5:30-9:45pm MTWTh Lecture L. Porter F 25
Section 9687 meets for 5 weeks from: July 20 to August 20, 2009.

English as a Second Language 02B - 0 Units

Conversation and Grammar Level II

Recommended Preparation: qualification by assessment or completion of English as a Second Language 02A; concurrent enrollment in English as a Second Language 03B

9674 8:00-11:20am MTWThF Lecture L. Porter D 41
Section 9674 meets for 5 weeks from: June 15 to July 17, 2009.

Evening Hours

9675 5:45-10:00pm MTWTh Lecture Staff F 31
Section 9675 meets for 5 weeks from: July 20 to August 20, 2009.

9676 5:30-9:45pm MTWTh Lecture L. Porter F 25
Section 9676 meets for 5 weeks from: June 15 to July 16, 2009.

Section #	Time	Instructor	Room #
-----------	------	------------	--------

English as a Second Language 02C - 0 Units

Conversation and Grammar Level III

Recommended Preparation: qualification by assessment or completion of English as a Second Language 02A and 02B; concurrent enrollment in English as a Second Language 03C

9677 8:00-11:20am MTWThF Lecture S. Lazar F 40
Section 9677 meets for 5 weeks from: June 15 to July 17, 2009.

Evening Hours

9679 5:30-9:45pm MTWTh Lecture S. Lazar F 40
Section 9679 meets for 5 weeks from: June 15 to July 16, 2009.

English as a Second Language 03A - 0 Units

Reading and Writing Level I

Recommended Preparation: concurrent enrollment in English as a Second Language 02A

9680 8:00-11:20am MTWThF Lecture C. Aguilar F 31
Section 9680 meets for 5 weeks from: June 15 to July 17, 2009.

9688 8:00-11:20am MTWThF Lecture L. Porter F 25
Section 9688 meets for 5 weeks from: July 20 to August 21, 2009.

Evening Hours

9682 6:00-9:20pm MTWThF Lecture Staff F 31
Section 9682 meets for 5 weeks from: June 15 to July 17, 2009.

Fashion

(Division of Industry & Technology 310-900-1600 ext 2273)

Fashion 10ab - 3 Units

Clothing Construction I

9746 9:00-10:30am MTWTh Lecture P. Ratcliff VT 214B
10:45-1:10pm MTWTh Lab P. Ratcliff VT 214B
Section 9746 meets for 5 weeks from: June 15 to July 16, 2009. Section 9746 is combined with Section 9747.

Fashion 11ab - 3 Units

Clothing Construction II

Prerequisite: one semester of Fashion 10ab with a minimum grade of C or equivalent

9747 9:00-10:30am MTWTh Lecture P. Ratcliff VT 214B
10:45-1:10pm MTWTh Lab P. Ratcliff VT 214B
Section 9747 meets for 5 weeks from: June 15 to July 16, 2009. Section 9747 is combined with section 9746.

Fire and Emergency Technology

(Division of Industry & Technology 310-900-1600 ext 2273)

Paramedic Program - Applications and information may be obtained from the Industry and Technology Division Office in Technical Arts Room 102 or by calling (310) 660-3600.

Fire and Emergency Technology 1 - 3 Units

Fire Protection Organization

Recommended Preparation: English 84 or eligibility for English 1A

Evening Hours

9748 6:00-8:25pm MTWTh Lecture Staff VT 215
Section 9748 meets for 5 weeks from: June 15 to July 16, 2009.

9749 6:00-8:25pm MTWTh Lecture Staff VT 215
Section 9749 meets for 5 weeks from: July 20 to August 20, 2009.



Geology

(Division of Natural Sciences 310-900-1600 ext 2332)

Geology 1 - 3 Units (CAN GEOL 6)

Physical Geology

Recommended Preparation: eligibility for English 84
Note: Four units of laboratory science credit will be granted with concurrent or subsequent enrollment in a geology laboratory course.

9120	8:00-10:25am MTWTh Lecture	L. Clark	MS 129
Section 9120 meets for 5 weeks from: June 15 to July 16, 2009.			
9122	1:30-3:55pm MTWTh Lecture	L. Clark	MS 129
Section 9122 meets for 5 weeks from: June 15 to July 16, 2009.			
9123	3:30-4:55pm MTWTh Lecture	M. Okbamichael	MS 128
Section 9123 meets for 8 weeks from: June 22 to August 13, 2009.			

Evening Hours

9124	5:00-7:25pm MTWTh Lecture	M. Okbamichael	MS 129
Section 9124 meets for 5 weeks from: July 20 to August 20, 2009.			

Geology 3 - 1 Unit

Physical Geology Laboratory

Prerequisite: Geology 1 with a minimum grade of C or concurrent enrollment

9130	10:30-12:55pm MTWTh Lab	L. Clark	MS 129
Section 9130 meets for 5 weeks from: June 15 to July 16, 2009.			

Evening Hours

9132	7:30-9:55pm MTWTh Lab	M. Okbamichael	MS 129
Section 9132 meets for 5 weeks from: July 20 to August 20, 2009.			

Health

(See Contemporary Health)

History

(Division of Behavioral & Social Sciences 310-900-1600 ext 2210)

History 1A - 3 Units (CAN HIST 8)

United States History to 1877

Recommended Preparation: eligibility for English 1A

9231	11:00-1:25pm MTWTh Lecture	J. Evans	E 32
Section 9231 meets for 5 weeks from: June 15 to July 16, 2009.			

Evening Hours

9234	6:00-8:25pm MTWTh Lecture	J. Evans	E 32
Section 9234 meets for 5 weeks from: June 15 to July 16, 2009.			

9486	See Distance Education Website	S. Panski	ONLINE
Section 9486 is a Distance Education online course. You must attend the first class meeting on Monday, June 22, from 6:00 p.m. to 7:30 p.m., in D 34 or you may be dropped from the course. Before the session begins, you must obtain the Student Handbook for Online courses available in the Distance Education Office or on the Distance Education website. Section 9486 meets for 8 weeks from: June 22 to August 13, 2009.			

History 1B - 3 Units (CAN HIST 10)

United States History from 1877 to the Present

Recommended Preparation: eligibility for English 1A

Note: History 1A is not a prerequisite.

9490	See Distance Education Website	S. Panski	ONLINE
Section 9490 is a Distance Education online course. You must attend the first class meeting on Monday, June 22, from 6:00 p.m. to 7:30 p.m., in E 32 or you may be dropped from the course. Before the session begins, you must obtain the Student Handbook for Online courses available in the Distance Education Office or on the Distance Education website. Section 9490 meets for 8 weeks from: June 22 to August 13, 2009.			

History 17 - 3 Units

History of the Chicano in the United States

Recommended Preparation: eligibility for English 1A

9236	8:00-10:25am MTWTh Lecture	Staff	E 32
Section 9236 meets for 5 weeks from: July 20 to August 20, 2009.			

Human Development

(Division of Behavioral & Social Sciences 310-900-1600 ext 2023)

Human Development 8 - 1 Unit

Orientation to College and Educational Planning

9246	8:00-9:30am MW Lecture	Staff	VT 126
Section 9246 meets for 5 weeks from: June 15 to July 17, 2009.			
9240	8:00-9:01am MW Lecture	Staff	VT 209
Section 9240 meets for 8 weeks from: June 22 to August 12, 2009.			
9241	8:00-9:30am MW Lecture	Staff	VT 126
Section 9241 meets for 5 weeks from: July 20 to August 19, 2009.			
9242	1:30-2:31pm MW Lecture	Staff	VT 209
Section 9242 meets for 8 weeks from: June 22 to August 12, 2009.			
9243	1:30-3:00pm TTh Lecture	Staff	VT 209
Section 9243 meets for 5 weeks from: July 21 to August 20, 2009.			
9244	1:30-3:00pm TTh Lecture	V. Haynes	VT 209
Section 9244 meets for 5 weeks from: June 16 to July 16, 2009.			

Human Development 15 - 2 Units

Student Athlete Orientation to College and Educational Planning

Recommended Preparation: eligibility for English 84

9247	9:00-10:30am MTWTh Lecture	Staff	E 39
Section 9247 meets for 5 weeks from: June 29 to July 30, 2009.			
9248	1:30-3:00pm MTWTh Lecture	Staff	VT 131
Section 9248 meets for 5 weeks from: July 20 to August 20, 2009.			
9249	3:00-4:30pm MTWTh Lecture	Staff	C 39
Section 9249 meets for 5 weeks from: July 20 to August 20, 2009.			

Humanities

(Division of Humanities 310-900-1600 ext 2235)

Humanities 1 - 3 Units

An Introduction to the Humanities

Recommended Preparation: eligibility for English 84

9445	See Distance Education Website	R. Page	ONLINE
Section 9445 is a Distance Education online course. The first class meeting is Monday, June 22, from 6:00 p.m. to 7:00 p.m., in E 10. You must attend this meeting or you may be dropped from the course. Before the session begins, you must obtain the Student Handbook for Online Courses available in the Distance Education Office or on the Distance Education website. Section 9445 meets for 8 weeks from: June 22 to August 13, 2009.			

Law

(Division of Business 310-900-1600 ext 2271)

Law 4 - 4 Units (CAN BUS 12)

Legal Environment of Business

Recommended Preparation: English 84

9368	See Distance Education Website	M. Ahmad	ONLINE
Section 9368 is a Distance Education online course. The first class meeting is Thursday, July 23 from 11:00 a.m. to 12:00 p.m. or 6:00 p.m. to 7:00 p.m., in VT 125. You must attend this meeting or you may be dropped from the course. Before the session begins, you must obtain the Student Handbook for Online Courses available in the Distance Education Office or on the Distance Education website. Section 9368 meets for 5 weeks from: July 20 to August 20, 2009.			



Machine Tool Technology

(Division of Industry & Technology 310-900-1600 ext 2620)

Machine Tool Technology 46 - 3 Units

Basic Machine Tool Operations

Evening Hours

9754	5:30-7:00pm MTWTh Lecture	F. Tung	VT 167
	7:15-10:35pm MTWTh Lab	F. Tung	VT 167

Section 9754 meets for 5 weeks from: June 15 to July 16, 2009.

Machine Tool Technology 47abcd - .5-2 Units

NIMS Level I Credential Preparation

Prerequisite: Machine Tool Technology 101abcd with a minimum grade of C
 Note: Students enrolled in Machine Tool Technology 47abcd are to meet with the instructor the first week of the semester. Lab hours are to be scheduled by the student between the hours of 9:05 a.m. and 12:15 p.m. AND between the hours of 6:50 p.m. and 10:00 p.m., Monday through Thursday.

9753	11:00-3:15pm MTW Lab	Staff	VT 167
------	----------------------	-------	--------

Section 9753 meets for 8 weeks from: June 22 to August 12, 2009.

Mathematics

(Division of Mathematical Sciences 310-900-1600 ext 2332)

The El Camino College Mathematics Placement Test and assessment is to be used for initial placement only. Once a student has enrolled in a mathematics course at El Camino, the Mathematics Placement Test cannot be used to skip courses.

Mathematics 10A - 2 Units

Basic Arithmetic Skills, Part I

Note: Students enrolled in this course are required to participate in individual and group activities.

9904	1:30-3:00pm MTWTh Lecture	Staff	MS 202
------	---------------------------	-------	--------

Section 9904 meets for 5 weeks from: June 15 to July 16, 2009.

Evening Hours

9903	4:30-5:31pm MTWTh Lecture	Staff	MS 207
------	---------------------------	-------	--------

Section 9903 meets for 8 weeks from: June 22 to August 13, 2009.

Mathematics 10B - 2 Units

Basic Arithmetic Skills, Part II

Prerequisite: Mathematics 10A with a minimum grade of C
 Note: Students enrolled in this course are required to participate in individual and group activities.

9905	1:30-3:00pm MTWTh Lecture	Staff	MS 208
------	---------------------------	-------	--------

Section 9905 meets for 5 weeks from: July 20 to August 20, 2009.

Evening Hours

9914	4:30-6:00pm MTWTh Lecture	Staff	MS 202
------	---------------------------	-------	--------

Section 9914 meets for 5 weeks from: June 15 to July 16, 2009.

Mathematics 12 - 4 Units

Basic Arithmetic Skills

9907	8:00-10:35am MTWThF Lecture	M. Shaikh	MS 208
------	-----------------------------	-----------	--------

Section 9907 meets for 5 weeks from: June 15 to July 17, 2009.

9908	8:00-10:05am MTWTh Lecture	Staff	MS 207
------	----------------------------	-------	--------

Section 9908 meets for 8 weeks from: June 22 to August 13, 2009.

9909	3:00-5:35pm MTWThF Lecture	Staff	MS 206
------	----------------------------	-------	--------

Section 9909 meets for 5 weeks from: July 20 to August 21, 2009.

Evening Hours

9910	6:00-8:35pm MTWThF Lecture	Staff	MS 207
------	----------------------------	-------	--------

Section 9910 meets for 5 weeks from: June 15 to July 17, 2009.

Mathematics 23 - 4 Units

Pre-Algebra

Prerequisite: Mathematics 10B or Mathematics 12 with a minimum grade of C in prerequisite or qualification by testing (El Camino College Mathematics Placement Test) and assessment

9916	8:00-10:05am MTWTh Lecture	Staff	MS 206
------	----------------------------	-------	--------

Section 9916 meets for 8 weeks from: June 22 to August 13, 2009.

9913	3:00-5:35pm MTWThF Lecture	Staff	MS 202
------	----------------------------	-------	--------

Section 9913 meets for 5 weeks from: July 20 to August 21, 2009.

9917	2:00-4:35pm MTWThF Lecture	A. Abbassi	MS 205
------	----------------------------	------------	--------

Section 9917 meets for 5 weeks from: June 15 to July 17, 2009.

Evening Hours

9915	6:00-8:05pm MTWTh Lecture	Staff	MS 228
------	---------------------------	-------	--------

Section 9915 meets for 8 weeks from: June 22 to August 13, 2009.

Mathematics 40 - 4 Units

Elementary Algebra

Prerequisite: Mathematics 23 or Mathematics 25 with a minimum grade of C in prerequisite or qualification by testing (El Camino College Mathematics Placement Test) and assessment

Note: Mathematics 40 is equivalent to one year of high school algebra.

9918	8:00-10:35am MTWThF Lecture	N. Mehdizadeh	MS 211
------	-----------------------------	---------------	--------

Section 9918 meets for 5 weeks from: June 15 to July 17, 2009.

9919	11:00-1:35pm MTWThF Lecture	M. Ghafelebashi	MS 212
------	-----------------------------	-----------------	--------

Section 9919 meets for 5 weeks from: July 20 to August 21, 2009.

9921	1:00-3:05pm MTWTh Lecture	N. Mehdizadeh	MS 211
------	---------------------------	---------------	--------

Section 9921 meets for 8 weeks from: June 22 to August 13, 2009.

Evening Hours

9920	6:00-8:35pm MTWThF Lecture	Staff	MS 208
------	----------------------------	-------	--------

Section 9920 meets for 5 weeks from: July 20 to August 21, 2009.

Mathematics 41A - 3 Units

Elementary Algebra, Part I

Prerequisite: Mathematics 23 or Mathematics 25 with a minimum grade of C in prerequisite or qualification by testing (El Camino College Placement Test) and assessment

Note: Students enrolled in this course are required to participate in group activities. Mathematics 41A and 41B together are equivalent to Mathematics 40.

9923	8:00-10:25am MTWTh Lecture	D. Roach	MS 202
------	----------------------------	----------	--------

Section 9923 meets for 5 weeks from: June 15 to July 16, 2009.

Evening Hours

9925	6:00-8:25pm MTWTh Lecture	A. Abbassi	MS 205
------	---------------------------	------------	--------

Section 9925 meets for 5 weeks from: June 15 to July 16, 2009.

Mathematics 41B - 3 Units

Elementary Algebra, Part II

Prerequisite: Mathematics 41A with a minimum grade of C or equivalent
 Note: Students enrolled in this course are required to participate in group activities. Mathematics 41A and 41B together are equivalent to Mathematics 40.

9927	8:00-10:25am MTWTh Lecture	D. Roach	MS 202
------	----------------------------	----------	--------

Section 9927 meets for 5 weeks from: July 20 to August 20, 2009.

Evening Hours

9929	6:00-8:25pm MTWTh Lecture	A. Abbassi	MS 205
------	---------------------------	------------	--------

Section 9929 meets for 5 weeks from: July 20 to August 20, 2009.

Mathematics 60 - 4 Units

Elementary Geometry

Prerequisite: Mathematics 40 or Mathematics 41B or Mathematics 43 with a minimum grade of C in prerequisite or qualification by testing (El Camino College Mathematics Placement Test) or assessment

Note: This course is equivalent to one year of high school geometry.

9930	8:00-11:20am MTWTh Lecture	Staff	MS 208
------	----------------------------	-------	--------

Section 9930 meets for 5 weeks from: July 20 to August 20, 2009.

Mathematics 70 - 5 Units

Intermediate Algebra

Prerequisite: Mathematics 40 or Mathematics 41B with a minimum grade of C in prerequisite or qualification by testing (El Camino College Mathematics Placement Test) and assessment

Note: You must have satisfied the course prerequisite at El Camino College or another accredited college. A transcript or grade slip is required for verification of a grade from another college.

9932	8:00-10:35am MTWTh Lecture	J. Villalobos	MS 210
------	----------------------------	---------------	--------

Section 9932 meets for 8 weeks from: June 22 to August 13, 2009.

9933	11:00-1:35pm MTWTh Lecture	J. Villalobos	MS 210
------	----------------------------	---------------	--------

Section 9933 meets for 8 weeks from: June 22 to August 13, 2009.

9935	1:00-3:35pm MTWTh Lecture	M. Boroujerdi	MS 209
------	---------------------------	---------------	--------

Section 9935 meets for 8 weeks from: June 22 to August 13, 2009.

Evening Hours

9934	6:00-8:35pm MTWTh Lecture	Staff	MS 210
------	---------------------------	-------	--------

Section 9934 meets for 8 weeks from: June 22 to August 13, 2009.

Mathematics 120 - 3 Units (CAN MATH 2)

Nature of Mathematics

Prerequisite: Mathematics 70 with a minimum grade of C or qualification by testing (El Camino College Mathematics Placement Test) and assessment.

Note: You must have satisfied the course prerequisite at El Camino College or another accredited college. A transcript or grade slip is required for verification of a grade from another college.

Evening Hours

9936	6:00-8:25pm MTWTh Lecture	Staff	MS 206
------	---------------------------	-------	--------

Section 9936 meets for 5 weeks from: July 20 to August 20, 2009.

Section #	Time	Instructor	Room #
-----------	------	------------	--------

Mathematics 130 - 3 Units (CAN MATH 10)

College Algebra

Prerequisite: Mathematics 70 with a minimum grade of C or qualification by testing (El Camino College Mathematics Placement Test) and assessment.
 Note: No credit will be granted to students who have completed Mathematics 180. You must have satisfied the course prerequisite at El Camino College or another accredited college. A transcript or grade slip is required for verification of a grade from another college.

9939 11:00-1:25pm MTWTh Lecture D. Roach MS 202
 Section 9939 meets for 5 weeks from: June 15 to July 16, 2009.

9940 11:00-1:25pm MTWTh Lecture D. Roach MS 202
 Section 9940 meets for 5 weeks from: July 20 to August 20, 2009.

Evening Hours

9938 6:00-8:25pm MTWTh Lecture Staff MS 202
 Section 9938 meets for 5 weeks from: July 20 to August 20, 2009.

Mathematics 150 - 4 Units (CAN STAT 2)

Elementary Statistics with Probability

Prerequisite: Mathematics 70 with a minimum grade of C or qualification by testing (El Camino College Mathematics Placement Test) and assessment.
 Note: You must have satisfied the course prerequisite at El Camino College or another accredited college. A transcript or grade slip is required for verification of a grade from another college.

9943 8:00-10:35am MTWThF Lecture M. Ghafelebashi MS 212
 Section 9943 meets for 5 weeks from: June 15 to July 17, 2009.

Evening Hours

9944 6:00-8:35pm MTWThF Lecture Staff MS 207
 Section 9944 meets for 5 weeks from: July 20 to August 21, 2009.

Mathematics 160 - 4 Units (CAN MATH 30)

Calculus for the Biological, Management and Social Sciences I

Prerequisite: Mathematics 130 or Mathematics 180 with a minimum grade of C
 Note: You must have satisfied the course prerequisite at El Camino College or another accredited college. A transcript or grade slip is required for verification of a grade from another college.

Evening Hours

9946 6:00-8:35pm MTWThF Lecture M. Boroujerdi MS 209
 Section 9946 meets for 5 weeks from: June 15 to July 17, 2009.

Mathematics 161 - 3 Units

Calculus for the Biological, Management and Social Sciences II

Prerequisite: Mathematics 160 with a minimum grade of C
 Note: You must have satisfied the course prerequisite at El Camino College or another accredited college. A transcript or grade slip is required for verification of a grade from another college.

Evening Hours

9945 6:00-8:25pm MTWTh Lecture M. Boroujerdi MS 209
 Section 9945 meets for 5 weeks from: July 20 to August 20, 2009.

Mathematics 180 - 5 Units (CAN MATH 16)

Pre-Calculus

Prerequisite: Mathematics 170 with a minimum grade of C
 Note: You must have satisfied the course prerequisite at El Camino College or another accredited college. A transcript or grade slip is required for verification of a grade from another college.

9948 1:00-3:35pm MTWTh Lecture Staff MS 228
 Section 9948 meets for 8 weeks from: June 22 to August 13, 2009.

Medical Terminology

(Division of Health Sciences & Athletics 310-900-1600 ext 2700)

Medical Terminology 1 - 3 Units

Medical Terminology

Recommended Preparation: eligibility for English 1A
 Note: formerly Medical Assistant 4

9856 8:00-11:10am MW Lecture C. Ward E 40
 Section 9856 meets for 8 weeks from: June 22 to August 12, 2009.

Section #	Time	Instructor	Room #
-----------	------	------------	--------

Microbiology

(Division of Natural Sciences 310-900-1600 ext 2332)

Microbiology 33 - 5 Units (CAN BIOL 14)

General Microbiology

Prerequisite: Biology 10 or Anatomy 30 or Anatomy 32 or Physiology 31 or equivalent; and Chemistry 4 or Chemistry 20 or Chemistry 1A or Chemistry 21A or equivalent with a minimum grade of C in prerequisite

Evening Hours

9152 5:15-6:40pm MTWTh Lecture I. James MS 103
 6:45-9:55pm MTWTh Lab I. James MS 107
 Section 9152 meets for 8 weeks from: June 22 to August 13, 2009.

Music

(Division of Fine Arts 310-900-1600 ext 2210)

Music 11 - 3 Units

Music Appreciation Survey

Recommended Preparation: eligibility for English 1A

9542 8:00-10:25am MTWTh Lecture M. Uch. Y 99
 Section 9542 meets for 5 weeks from: July 20 to August 20, 2009.

Music 13 - 3 Units

Survey of Jazz

Recommended Preparation: eligibility for English 1A

9544 9:00-11:25am MTWTh Lecture H. Estrada VT 214A
 Section 9544 meets for 5 weeks from: June 15 to July 16, 2009.

Music 47ab - 2 Units

Beginning Guitar

Note: formerly Music 24A

9546 12:00-1:30pm MTWTh Lecture M. Uch. Y 82
 1:30-3:00pm MW Lab M. Uch. Y 82
 Section 9546 meets for 5 weeks from: July 20 to August 20, 2009. Section 9546 is combined with Section 9547.

Music 48abcd - 2 Units

Intermediate Guitar

Prerequisite: one semester of Music 47ab with a minimum grade of C or equivalent

Note: formerly Music 24B

9547 12:00-1:30pm MTWTh Lecture M. Uch. Y 82
 1:30-3:00pm MW Lab M. Uch. Y 82
 Section 9547 meets for 5 weeks from: July 20 to August 20, 2009. Section 9547 is combined with Section 9546.

Music 80abc - 2 Units

Fundamentals of Electronic Music

Note: formerly Music 80

9549 12:30-2:00pm MW Lecture H. Estrada VT 214A
 2:00-3:30pm MTWTh Lab H. Estrada VT 214A
 Section 9549 meets for 5 weeks from: June 15 to July 16, 2009.

Nursing

(Division of Health Sciences & Athletics 310-900-1600 ext 2700)

Enrollment is limited to students who have been accepted into the Nursing Program. Readmission and transfer students must be accepted for entrance into the program in order to enroll in any nursing course. This acceptance/readmission/transfer policy does not apply to Nursing 48ab or Nursing 145. Nursing 48ab and Nursing 145 may be taken before admission/readmission to the Nursing Program. Nursing courses must be taken in sequence as each course builds on the previous courses.

Nursing 48ab - 1 Unit

Calculating Drugs and Solutions

Prerequisite: eligibility for Mathematics 70

Evening Hours

9850 6:00-8:10pm Th Lecture Staff E 56
 Section 9850 meets for 8 weeks from: June 23 to August 11, 2009.

Section #	Time	Instructor	Room #
-----------	------	------------	--------

Nursing 145 - 2 Units

Introduction to Nursing

Prerequisite: eligibility for English 1A and Mathematics 70
 Note: formerly Nursing 49. This preparatory skills course is open to all prospective Nursing students.

Evening Hours

9852 4:30-8:45pm T Lecture M. Green E 40
 Section 9852 meets for 8 weeks from: June 23 to August 11, 2009.

Nursing 151 - 2 Units

Human Development and Health

Enrollment Limitation: admission to the Nursing Program
 Note: Formerly Nursing 61

Evening Hours

9851 4:30-7:50pm MW Lecture O. Nwabuzor E 40
 Section 9851 meets for 8 weeks from: June 22 through August 12, 2009.

Nursing 155 - 1 Unit

Health Assessment

Prerequisite: Nursing 150, Nursing 151, and Nursing 152 with a minimum grade of C in each prerequisite course

9857 10:30-11:31am M Lecture Staff E 56
 12:00-3:20pm M Lab Staff E 56
 Section 9857 meets for 8 weeks from: June 22 to August 10, 2009.

Nursing 156 - 1 Unit

Advanced Nursing Pharmacology

Prerequisite: Nursing 150, Nursing 151, and Nursing 152 with a minimum grade of C in prerequisite

Note: formerly Nursing 66B

9853 9:00-10:01am TTh Lecture Staff E 40
 Section 9853 meets for 8 weeks from: June 23 to August 13, 2009.

Nursing 210 - 2 Units

Implications of Pathophysiology Concepts for Nurses

Prerequisite: Nursing 153 with a minimum grade of C or equivalent or licensed registered nurse or vocational nurse

9855 2:30-5:50pm TTh Lecture Staff AS 7
 Section 9855 meets for 5 weeks from: June 16 to July 16, 2009.

Nutrition and Foods

(Division of Industry & Technology 310-900-1600 ext 2273)

Nutrition and Foods 11 - 3 Units (CAN FCS 2)

Nutrition

Recommended Preparation: eligibility for English 84

Evening Hours

9755 6:00-8:25pm MTWTh Lecture F. Williams VT 131
 Section 9755 meets for 5 weeks from: June 15 to July 20, 2009.

Nutrition and Foods 15 - 3 Units

Nutrition for Infants and Young Children

Recommended Preparation: eligibility for English 84

Evening Hours

9759 6:00-8:25pm MTWTh Lecture Staff VT 131
 Section 9759 meets for 5 weeks from: July 20 to August 20, 2009.

Paramedical Technician Program

Applications and information may be obtained from the Industry and Technology Division Office in Technical Arts Room 102 or by calling (310) 660-6589.



Section #	Time	Instructor	Room #
-----------	------	------------	--------

Philosophy

(Division of Behavioral & Social Sciences 310-900-1600 ext 2235)

Philosophy 3 - 3 Units (CAN PHIL 4)

Ethics and Society

Recommended Preparation: eligibility for English 1A

Evening Hours

9252 6:00-7:25pm MTWTh Lecture D. Smith D 41
 Section 9252 meets for 8 weeks from: June 22 to August 13, 2009.

Philosophy 8 - 3 Units (CAN PHIL 6)

Introduction to Logic

Recommended Preparation: eligibility for English 1A

9250 8:00-10:25am MTWTh Lecture A. Flemming E 33
 Section 9250 meets for 5 weeks from: June 15 to July 16, 2009.

9256 11:00-1:25pm MTWTh Lecture D. Smith E 39
 Section 9256 meets for 5 weeks from: July 20 to August 20, 2009.

Physical Education

(Division of Health Sciences & Athletics 310-900-1600 ext 2273)

TEAM SPORTS

Physical Education 16abc - 1 Unit

Off Season Training for Men's Intercollegiate Basketball Team

Enrollment Limitation: tryout (high school varsity experience or equivalent skill)
 Note: This course is offered in the spring semester and summer session only.

Evening Hours

9802 8:30-9:31pm MTWTh Lab A. Turner X 20
 Section 9802 meets for 8 weeks from: June 22 to August 13, 2009.

Physical Education 21abc - 1 Unit

Off Season Training for Women's Intercollegiate Cross Country Team

Enrollment Limitation: tryout (high school varsity experience or equivalent skill)

9831 3:30-4:31pm MTWTh Lab G. Baker CFLD
 Section 9831 meets for 8 weeks from: June 22 to August 13, 2009.

Physical Education 26abc - 1 Unit

Off Season Training for Men's Intercollegiate Cross Country

Enrollment Limitation: tryout (high school varsity experience or equivalent skill)

9806 2:00-3:01pm MTWTh Lab G. Baker CFLD
 Section 9806 meets for 8 weeks from: June 22 to August 13, 2009.

Physical Education 36abc - 1 Unit

Off Season Training for Men's Intercollegiate Football Team

Enrollment Limitation: tryout (high school varsity experience or equivalent skill)

Evening Hours

9807 5:00-6:01pm MTWTh Lab S. Fernandes CTRK
 Section 9807 meets for 5 weeks from: June 15 to July 16, 2009.

9808 5:00-6:01pm MTWTh Lab Staff CTRK
 Section 9808 meets for 8 weeks from: June 22 to August 13, 2009.

Physical Education 106abc - 1 Unit

Off Season Training for Women's Intercollegiate Basketball Team

Enrollment Limitation: tryout (high school varsity experience or equivalent skill)
 Note: This course is offered in the spring semester and summer session only.

9816 2:00-4:01pm MTWTh Lab T. McNeil X 20
 Section 9816 meets for 8 weeks from: June 22 to August 13, 2009.

Section #	Time	Instructor	Room #
-----------	------	------------	--------

ACTIVITY CLASSES

Physical Education 1abcd - 1 Unit

Body Conditioning and Physical Fitness

Note: formerly Physical Education 1ab

9800 11:00-1:25pm MTWTh Lab O. Goudeau X 14
Section 9800 meets for 5 weeks from: June 15 to July 16, 2009.

Physical Education 2abcd - 1 Unit

Walking for Fitness

9801 7:00-9:25am MTWTh Lab B. Jackson CTRK
Section 9801 meets for 5 weeks from: July 20 to August 20, 2009.

9803 7:00-9:25am MTWTh Lab B. Jackson CTRK
Section 9803 meets for 5 weeks from: June 15 to July 16, 2009.

Physical Education 54abcd - 1 Unit

Weight Training

9811 8:00-9:30am MTWTh Lab A. Turner X 14
Section 9811 meets for 5 weeks from: June 15 to July 16, 2009.

9813 8:00-9:01am MTWTh Lab A. Youngblood X 14
Section 9813 meets for 8 weeks from: June 22 to August 13, 2009.

9838 11:00-12:01pm MTWTh Lab J. Diaz X 14
Section 9838 meets for 8 weeks from: June 22 to August 13, 2009.

9809 1:00-2:01pm MTWTh Lab A. Turner X 14
Section 9809 meets for 8 weeks from: June 22 to August 13, 2009.

9814 3:15-4:45pm MTWTh Lab A. Turner X 14
Section 9814 meets for 5 weeks from: June 15 to July 16, 2009.

9812 3:15-4:45pm MTWTh Lab A. Turner X 14
Section 9812 meets for 5 weeks from: July 20 to August 20, 2009.

Evening Hours

9815 6:00-7:30pm MTWTh Lab T. McNeil X 14
Section 9815 meets for 5 weeks from: July 20 to August 20, 2009.

9836 6:00-7:30pm MTWTh Lab J. Diaz X 14
Section 9836 meets for 5 weeks from: June 15 to July 16, 2009.

9810 6:30-8:00pm MTWTh Lab Staff X 14
Section 9810 meets for 5 weeks from: June 15 to July 16, 2009.

Physical Education 74abcd - 1 Unit

Soccer

9819 3:00-4:01pm MTWTh Lab J. Gutierrez CFLD
Section 9819 meets for 8 weeks from: June 22 to August 13, 2009.

Physical Education 135abcd - 1 Unit

Sport-Specific, Periodized Training for Athletes

Enrollment Limitation: Tryout (high school varsity experience or equivalent skill)

9826 1:15-2:45pm MTWTh Lab J. Gutierrez CFLD
Section 9826 meets for 5 weeks from: July 20 to August 20, 2009.

Evening Hours

9825 5:00-6:01pm MTWTh Lab S. Williams CTRK
Section 9825 meets for 8 weeks from: June 22 to August 13, 2009.

9827 6:30-7:31pm MTWTh Lab S. Fernandes CFLD
Section 9827 meets for 8 weeks from: June 22 to August 13, 2009.

Physical Education 204abcd - 1 Unit

Badminton

9820 11:00-12:30pm MTWTh Lab A. Youngblood X 20
Section 9820 meets for 5 weeks from: June 15 to July 16, 2009.

Physical Education 217 - 2 Units

Sports Officiating

Recommended Preparation: eligibility for English A or 84

9817 11:00-12:30pm MTWTh Lecture L. Mendoza MS 207
12:30-2:55pm MTWTh Lab L. Mendoza MS 207
Section 9817 meets for 5 weeks from: July 20 to August 20, 2009.

9829 8:00-9:30am MTWTh Lecture A. Turner V 70
9:30-11:55am MTWTh Lab A. Turner CFLD
Section 9829 meets for 5 weeks from: June 15 to July 16, 2009.

Physical Education 224abcd - 1 Unit

Golf

9822 8:00-9:30am MTWTh Lab Staff CGC
Section 9822 meets for 5 weeks from: June 15 to July 16, 2009.

9824 8:00-9:30am MTWTh Lab L. Biffle X 20
Section 9824 meets for 5 weeks from: July 20 to August 20, 2009.

Section #	Time	Instructor	Room #
-----------	------	------------	--------

Physical Education 234abcd - 1 Unit

Off Season Training for Pep Squad

9833 12:30-2:00pm MTWTh Lab S. Murray CTRK
Section 9833 meets for 5 weeks from: June 15 to July 16, 2009.

9837 12:30-2:00pm MTWTh Lab S. Murray CTRK
Section 9837 meets for 5 weeks from: July 20 to August 20, 2009.

Physical Education 272 - 3 Units

Care and Prevention of Athletic Injuries

Recommended Preparation: eligibility for English A or 84

Note: Formerly First Aid 3

9823 10:30-11:55am MTWTh Lecture J. Diaz MS 206
Section 9823 meets for 8 weeks from: June 22 to August 13, 2009.

Physical Education 300abcd - 1 Unit

Aerobic Fitness

Evening Hours

9818 6:00-7:30pm MTWTh Lab O. Goudeau X 15
Section 9818 meets for 5 weeks from: June 15 to July 16, 2009.

9821 6:00-7:30pm MTWTh Lab O. Goudeau X 15
Section 9821 meets for 5 weeks from: July 20 to August 20, 2009.

Physics

(Division of Natural Sciences 310-900-1600 ext 2332)

Physics 11 - 3 Units

Descriptive Introduction to Physics

Recommended Preparation: eligibility for English 84

Note: Credit will not be granted to student who has completed a college physics course.

9155 8:00-9:25am MTWTh Lecture M. Khan MS 126
Section 9155 meets for 8 weeks from: June 22 to August 13, 2009.

Physics 12 - 1 Unit

Laboratory for Introductory Physics

Prerequisite: Physics 11 with a minimum grade of C or concurrent enrollment

Note: Credit will not be granted to student who has completed a college physics course with laboratory. Physics 12 satisfies a CSU and IGETC general education laboratory requirement if paired with Physics 11.

9156 10:00-11:25am MTWTh Lab M. Khan MS 126
Section 9156 meets for 8 weeks from: June 22 to August 13, 2009.

Physics 1A - 4 Units (CAN PHYS 8)

Mechanics of Solids

Prerequisite: Physics 11 and 13, or Physics 2A with a minimum grade of C in prerequisite or one year of high school physics; Mathematics 190 with a minimum grade of C or concurrent enrollment

9153 2:45-4:50pm MTWTh Lecture W. Keig MS 126
4:55-5:56pm MTWTh Lab W. Keig MS 126
Section 9132 meets for 8 weeks from: June 22 to August 13, 2009.

Physics 1C - 4 Units (CAN PHYS 12)

Electricity and Magnetism

Prerequisite: Physics 1A with a minimum grade of C; Mathematics 191 with a minimum grade of C

9154 11:30-1:35pm MTWTh Lecture M. Khan MS 126
1:40-2:41pm MTWTh Lab M. Khan MS 126
Section 9154 meets for 8 weeks from: June 22 to August 13, 2009.

Physiology

(Division of Natural Sciences 310-900-1600 ext 2332)

Physiology 31 - 4 Units (CAN BIOL 12)

Human Physiology

Prerequisite: Anatomy 30 or 32 and Chemistry 20, 21A, or 4 with a minimum grade of C in prerequisite

9160 1:00-2:01pm MTWTh Lecture E. Boatwright MS 105
2:15-5:25pm MTWTh Lab E. Boatwright MS 105
Section 9160 meets for 8 weeks from: June 22 to August 13, 2009.

Political Science

(Division of Behavioral & Social Sciences 310-900-1600 ext 2210)

Political Science 1 - 3 Units (CAN GOVT 2)

Governments of the United States and California

Recommended Preparation: eligibility for English 1A

9280 7:45-10:55am TTh Lecture P. Flor. E 10
Section 9280 meets for 8 weeks from: June 22 to August 13, 2009.

Political Science 2 - 3 Units

Introduction to Comparative Politics

Recommended Preparation: Political Science 1 and eligibility for English 1A

9487 See Distance Education Website Staff ONLINE
Section 9487 is a Distance Education online course. You must attend the first class meeting on Wednesday, June 17, from 4:30 p.m. to 6:30 p.m., in E 10 or you may be dropped from the course. Before the session begins, you must obtain the Student Handbook for Online Courses available in the Distance Education Office or on the Distance Education website. Section 9487 meets for 5 weeks from: June 15 to July 16, 2009.

Political Science 5 - 3 Units

Ethnicity in the American Political Process

Recommended Preparation: eligibility for English 1A

9284 11:00-1:25pm MTWTh Lecture Staff E 10
Section 9284 meets for 5 weeks from: July 20 to August 20, 2009.

Psychology

(Division of Behavioral & Social Sciences 310-900-1600 ext 2210)

Psychology 5 - 3 Units (CAN PSY 2)

General Psychology

Recommended Preparation: eligibility for English 1A

9272 8:00-10:25am MTWTh Lecture D. McPatchell. MS 205
Section 9272 meets for 5 weeks from: June 15 to July 16, 2009.
9274 8:00-10:25am MTWTh Lecture D. McPatchell. MS 205
Section 9274 meets for 5 weeks from: July 20 to August 20, 2009.
9273 11:00-1:25pm MTWTh Lecture D. McPatchell. MS 205
Section 9273 meets for 5 weeks from: July 20 to August 20, 2009.
9484 See Distance Education Website H. Williams. ONLINE
Section 9484 is a Distance Education online course. You must attend the first class meeting on Monday, June 22, from 4:00 p.m. to 5:30 p.m., in MS 206 or you may be dropped from the course. Before the session begins, you must obtain the Student Handbook for Online Courses available in the Distance Education Office or on the Distance Education website. Section 9484 meets for 8 weeks from: June 22 to August 13, 2009.

Psychology 7 - 3 Units (CAN PSY 10)

Physiological Psychology

Prerequisite: Psychology 5 with a minimum grade of C

9277 11:00-1:25pm MTWTh Lecture D. McPatchell. MS 205
Section 9277 meets for 5 weeks from: June 15 to July 16, 2009.

Psychology 15 - 3 Units

Abnormal Psychology

Prerequisite: Psychology 5 with a minimum grade of C

Recommended Preparation: eligibility for English 1A

9275 11:00-1:25pm MTWTh Lecture Staff E 38
Section 9275 meets for 5 weeks from: July 20 to August 20, 2009.

Psychology 16 - 3 Units

Lifespan Development

Prerequisite: Psychology 5 with a minimum grade of C

Evening Hours

9278 6:00-8:25pm MTWTh Lecture H. Williams. MS 105
Section 9278 meets for 5 weeks from: June 15 to July 16, 2009.

Real Estate

(Division of Business 310-900-1600 ext 2271)

Real Estate 11 - 3 Units

Real Estate Principles

Recommended Preparation: eligibility for English 1A

Evening Hours

9317 6:00-8:25pm MTWTh Lecture R. Morgan. VT 128
Section 9317 meets for 5 weeks from: June 15 to July 16, 2009.

Real Estate 26 - 3 Units

Principles of Escrow

Recommended Preparation: Real Estate 11, 12A, or California Department of Real Estate (DRE) license or equivalent experience; Business 1A or Business 15

9318 2:30-4:55pm MTWTh Lecture R. Morgan. VT 128
Section 9318 meets for 5 weeks from: July 20 to August 20, 2009.

Evening Hours

9325 6:00-8:25pm MTWTh Lecture R. Morgan. VT 128
Section 9325 meets for 5 weeks from: July 20 to August 20, 2009.

Recreation

(Division of Health Sciences & Athletics 310-900-1600 ext 2273)

Recreation 207 - 3 Units (CAN REC 2)

Introduction to Recreation

Recommended Preparation: eligibility for English A or 84

9828 1:00-2:25pm MTWTh Lecture Staff MS 206
Section 9828 meets for 8 weeks from: June 22 to August 13, 2009.

Sociology

(Division of Behavioral & Social Sciences 310-900-1600 ext 2210)

Sociology 101 - 3 Units (CAN SOC 2)

Introduction to Sociology

Prerequisite: eligibility for English 1A

Note: formerly Sociology 5

9489 See Distance Education Website V. Haynes. ONLINE
Section 9489 is a Distance Education online course. You must attend the first class meeting on Thursday, July 2, from 4:00 p.m. to 5:00 p.m., in VT 209 or you may be dropped from the course. Before the session begins, you must obtain the Student Handbook for Online Courses available in the Distance Education Office or on the Distance Education website. Section 9489 meets for 8 weeks from: June 22 to August 13, 2009.

Spanish

(Division of Humanities 310-900-1600 ext 2554)

Spanish 1 - 4 Units (CAN SPAN 2)

Elementary Spanish I

Recommended Preparation: eligibility for English A

Note: Approved by State Department of Education as an ethnic studies course.

This course is comparable to two years of high school Spanish.

9690 8:00-12:15pm MTWTh Lecture A. Maradiaga F 25
Section 9690 meets for 5 weeks from: June 15 to July 16, 2009.

9696 8:00-12:15pm MTWTh Lecture N. Parker F 24
Section 9696 meets for 5 weeks from: July 20 to August 20, 2009.

9694 11:00-3:15pm MTWTh Lecture A. Maradiaga F 40
Section 9694 meets for 5 weeks from: July 20 to August 20, 2009.

Evening Hours

9691 5:45-10:00pm MTWTh Lecture D. Uribe AS 8
Section 9691 meets for 5 weeks from: June 15 to July 16, 2009.

Section #	Time	Instructor	Room #
-----------	------	------------	--------

Spanish 2 - 4 Units (CAN SPAN 4)

Elementary Spanish II

Prerequisite: Spanish 1 with a minimum grade of C or equivalent
 Note: The prerequisite for this course is comparable to two years of high school Spanish.

9692 8:00-12:15pm MTWTh Lecture N. Parker F 24
 Section 9692 meets for 5 weeks from: June 15 to July 16, 2009.

Evening Hours

9695 5:45-10:00pm MTWTh Lecture D. Uribe F 24
 Section 9695 meets for 5 weeks from: July 20 to August 20, 2009.

Spanish 3 - 4 Units (CAN SPAN 8)

Intermediate Spanish I

Prerequisite: Spanish 2 with a minimum grade of C or equivalent
 Note: The prerequisite for this course is comparable to three years of high school Spanish.

Evening Hours

9693 5:45-10:00pm MTWTh Lecture A. Maradiaga F 24
 Section 9693 meets for 5 weeks from: June 15 to July 16, 2009.

Speech Communication

(Division of Fine Arts 310-900-1600 ext 2235)

Speech Communication 1 - 3 Units (CAN SPCH 4)

Effective Speaking

Recommended Preparation: eligibility for English 1A

9565 8:00-10:25am MTWTh Lecture E. Stewart E 34
 Section 9565 meets for 5 weeks from: June 15 to July 16, 2009.

9567 8:00-10:25am MTWTh Lecture Staff E 34
 Section 9567 meets for 5 weeks from: July 20 to August 20, 2009.

9566 10:30-12:55pm MTWTh Lecture E. Stewart E 34
 Section 9566 meets for 5 weeks from: June 15 to July 16, 2009.

Evening Hours

9569 6:00-8:25pm MTWTh Lecture Staff E 38
 Section 9569 meets for 5 weeks from: July 20 to August 20, 2009.

Speech Communication 3 - 3 Units

Group Discussion

Recommended Preparation: eligibility for English 1A

9574 10:30-12:55pm MTWTh Lecture Staff E 34
 Section 9574 meets for 5 weeks from: July 20 to August 20, 2009.

Evening Hours

9573 6:00-8:25pm MTWTh Lecture Staff E 34
 Section 9573 meets for 5 weeks from: June 15 to July 16, 2009.

Section #	Time	Instructor	Room #
-----------	------	------------	--------

Theatre

(Division of Fine Arts 310-900-1600 ext 2210)

Theatre 1 - 3 Units

Theatre Appreciation

Recommended Preparation: eligibility for English 84 or ESL 52C

9580 11:00-1:25pm MTWTh Lecture P. Van Niel Y 82
 Section 9580 meets for 5 weeks from: July 20 to August 20, 2009.

Theatre 8 - 3 Units

Introduction to Acting

Recommended Preparation: eligibility for English 84 or ESL 52C

9586 1:30-3:00pm MTWTh Lecture P. Van Niel Y 82
 3:05-5:30pm MTWTh Lab P. Van Niel Y 82
 Section 9586 meets for 5 weeks from: June 15 to July 16, 2009.

Theatre 70abcd - 1 Unit

Beginning Theatre Production

Enrollment Limitation: audition

Evening Hours

9584 5:30-6:55pm MTWTh Lab P. Van Niel Y 82
 Section 9584 meets for 8 weeks from June 22 to August 13, 2009. Section 9584 is combined with Section 9585. Additional rehearsal time is required.

Theatre 72ab - 1 Unit

Advanced Theatre Production

Enrollment Limitation: audition

Evening Hours

9585 5:30-6:55pm MTWTh Lab P. Van Niel Y 82
 Section 9585 meets for 8 weeks from June 22 to August 13, 2009. Section 9585 is combined with Section 9584. Additional rehearsal time is required.

Welding

(Division of Industry & Technology 310-900-1600 ext 2620)

Welding 21 - 3 Units

Basic Shielded Metal Arc Welding (SMAW)

9768 7:00-10:20am MTWTh Lab E. Benson VT 173
 10:20-11:50am MTWTh Lecture E. Benson VT 173
 Section 9768 meets for 5 weeks from: June 15 to July 16, 2009.

Welding 45ab - 5 Units

Structural Fabrication and Blueprint Reading

Prerequisite: Welding 1 or 21 with a minimum grade of C in prerequisite

9769 7:00-10:20am MTWTh Lab E. Benson VT 173
 10:30-1:50pm MTWTh Lecture E. Benson VT 173
 Section 9769 meets for 5 weeks from: June 15 to July 16, 2009.



Sexual Harassment Policy

It is the policy of the El Camino Community College District and the Compton Community College District to provide an educational, employment and business environment free of unwelcome sexual advances, requests for sexual favor/s, and other verbal or physical conduct or communications constituting sexual harassment as defined and otherwise prohibited by state and federal statutes. Within the El Camino Community College District and the Compton Community College District, sexual harassment is prohibited regardless of the status and/or relationships the affected parties may have.

Sexual harassment violates the policy of the Districts and provisions of the California Fair Employment Act, Education Code and Federal rules, regulations and laws.

Sexual harassment complaint forms are available in the Human Resources Office. Sexual harassment shall be immediately reported to the Compton Center Dean of Human Resources, or to any dean, director, or manager for immediate reporting to the El Camino Community College District's Equal Employment/ Education Officer.

Discrimination/Sexual Harassment Complaints

El Camino College Compton Center is committed to providing equal opportunity in education and employment. The college affirms its policy to provide fair and equitable treatment of students and employees and prohibit discrimination based on ethnic group identification, national origin, religion, age, sex (harassment), race, color, ancestry, sexual orientation, physical or mental disability, or retaliation.

Students or employees with questions, concerns or complaints of discrimination may contact and/or file an official complaint with these offices or agencies to initiate an El Camino College Compton Center discrimination investigation:

El Camino College Compton Center está comprometido a brindar igualdad de oportunidades de empleo y educación.

Esta institución reitera su póliza de proveer un trato justo y equitativo a estudiantes y empleados y prohibir la discriminación basada en identificación étnica, nacionalidad, religión, edad, género, raza, color, descendencia, orientación sexual, incapacidad (mental o física), o represalia.

Estudiantes y empleos con preguntas, dudas o quejas de discriminación pueden comunicarse y/o presentar una queja oficialmente con las oficinas o agencias que se nombran a continuación para iniciar una investigación de discriminación por parte de El Camino College Compton Center:

Students:

- El Camino College Compton Center
Equal Employment Officer,
Rachelle Sasser (310) 900-1600
- California Community Colleges
System Office
Attention: Legal Affairs Division
1102 Q Street
Sacramento, CA 95814-6511
- U.S. Department of Education,
Office for Civil Rights
50 Beale Street, Suite 7200
San Francisco, CA 94105
- California Department of Fair
Employment and Housing
600 W. Sixth Street, Suite 1600
Los Angeles, CA 90017-3316
- U.S. Equal Employment
Opportunity Commission,
255 E. Temple Street, 4th Floor
Los Angeles, CA 90012

Employees:

- El Camino College Compton Center
Equal Employment Officer,
Rachelle Sasser (310) 900-1600
- California Community Colleges
System Office
Attention: Legal Affairs Division
1102 Q Street
Sacramento, CA 95814-6511
- California Department of Fair
Employment and Housing
611 W. Sixth St., Suite 1600,
Los Angeles, CA 90017-3316
- U.S. Equal Employment
Opportunity Commission,
255 E. Temple Street, 4th Floor
Los Angeles, CA 90012

Special Resource Center (DSP&S)

The DSP&S offers a wide range of classes, supportive services and equipment designed to meet the educational needs of students with disabilities.

Eligibility is determined by specially trained staff. Each student is assessed on an individual basis. Specific educational needs are identified and a plan is developed with each student.

Examples of services or accommodations include sign language interpreters, testing accommodations, or printed materials available in alternate formats.

Courses are designed to address the specific and unique needs of students with disabilities. These courses are listed under "Educational Development" in this Schedule of Classes and are described in the college catalog.

El Camino College Compton Center recognizes its responsibility to provide an equal opportunity to education for all students. The courses, programs and facilities are designed to accommodate the needs of students with disabilities.

Students with verifiable disabilities who do not wish to avail themselves of the services of the DSP&S Office may still be eligible for reasonable accommodation and service. Contact the Director of the Special Resource Center at (310) 900-1600, ext. 2069, or the reception desk at ext. 2402 for more information.



Transfer Center

Transfer services are offered Monday through Thursday from 8:30 a.m. to 6:30 p.m. in the Welcome Center, Room D-29. The Transfer Center offers a wide range of activities designed to assist students in transferring successfully to the four-year college or university of their choice. Among the transfer services offered are advisement, regularly scheduled visits by admissions office representatives from four-year colleges and universities, and workshops on major steps in the transfer process. Other services offered include university fairs on the El Camino College Compton Center campus and field trips to major universities. Choose and apply to universities online, explore majors, and much more.

Library

The Library is open Monday - Thursday, 8 a.m.-8 p.m., and closed Fridays. The Library is closed on Sundays and holidays. The collection includes books, periodicals, and over a dozen online computer databases.

A campus photo ID is required to check materials out of the library and for use of the computers in the facility. The Textbook Collection provides materials for use within the library. For additional information call the El Camino College Compton Center Library at 310-900-1600, ext. 2175.

Learning Resource Center

The Learning Resources Center (LRC) is open to all currently enrolled El Camino College Compton Center students. The LRC includes the Open Lab and the LRC Tutorial Program. The hours are Monday - Thursday, 8 a.m. - 6 p.m., closed Fridays.

The LRC houses an extensive media collection to supplement instruction in many disciplines. The LRC and other open computer labs (Math and Science and Vocational/Technology) provide individualized computer-assisted instruction in reading and math. The LRC Tutorial Program offers free drop-in tutoring for over 40 subjects.

Abel B. Sykes Jr. Child Development Center

The Abel B. Sykes Jr. Child Development Center is accepting applications for Fall 2008 enrollment of infants, toddlers, preschool and school age children. If you are a student and/or working parent you may be eligible for FREE or low-cost child care. For further information, please call (310) 900-1600 ext. 2902 or drop by our office, which is located at the Compton Center Campus in Building T behind the Bookstore.

Open Labs

Dills Vocational Technology Center Open Lab:

Monday - Thursday, 8 a.m. - 8 p.m.
Friday, 8 a.m. - 5 p.m.

Mathematics and Science Open Lab:

Monday - Thursday, 8 a.m. - 9 p.m.
Friday, 8 a.m. - 4:30 p.m.

Reading Center (VT-209)

Monday - Thursday, 8 a.m. - 8 p.m.
Friday, 8 a.m. - 12 p.m.

Language Lab(F-39)

Monday - Thursday, 8 a.m. - 8 p.m.
Friday, 8 a.m. - 12 p.m.

Compton Center Bookstore

Hours:

Monday - Tuesday 9 a.m. to 4 p.m.
Wednesday & Thursday 11 a.m. to 6 p.m.
Closed Friday

Compton Center Cafeteria

Hours:

Monday - Thursday 8 a.m. to 6:30 p.m.
Friday - closed

Reciprocal Services for All Students

For your convenience...reciprocal services are available to students enrolled at both El Camino College and El Camino College Compton Center. Students in good standing at either campus have access to services at both campuses, including the bookstore, library and computer labs. Additionally, one parking permit is valid at both campuses.



Universal Beauty College

718 West Compton Boulevard
Compton, CA 90220

Universal Beauty College

8619 South Vermont Avenue
Los Angeles, CA 90044

Study Abroad for Summer 2009

Two different study abroad programs will be held during the Summer 2009 Session.

China

The China program will run from June 21 - July 18, 2009 with English 1C (Critical Thinking and Composition), English 25A (Creative Writing), History 37 (History of World Religions), and History 14A (History of Asian Civilizations) offered. Total program cost of \$3,599.00 includes airfare, lodging, and various excursions. For more information contact Dr. Joy Zhao at 310-660-3593, ext. 3168, or via e-mail at jzhao@elcamino.edu.

South Africa

The South Africa program will run from June 15 - July 7, 2009 with Geography 1 (Physical Geography) and Geography 2 (Cultural Geography) offered. Total program cost of \$4,950.00 includes airfare, lodging, and various excursions. This program offers an extension to Victoria Falls and Botswana for five days for \$1,100.00. For more information contact Professor Matt Ebner at 310-660-3593, ext. 3369, or via e-mail at mebner@elcamino.edu.

Financial Aid is available to interested/qualified students

Please contact Molly Villalobos in the Financial Aid & Scholarship office at 310-660-3488, or via e-mail at mvillalo@elcamino.edu.

What are YOU doing this Summer?

Check out El Camino College Compton Center - The Place To Be!



High School Reception Tuesday, June 9th • 5 - 7 pm • Student Lounge

**Learn about Campus Support Programs and Concurrent Enrollment
Financial Aid • Transfer Assistance • Tutoring • Programs for High School Students
Childcare • Book Vouchers • Counseling**

This is a FREE Event!

RSVP: 310-900-1600, ext 2765 by June 2nd or by e-mail outreach@compton.edu

EL CAMINO COLLEGE COMPTON CENTER

1111 E. Artesia Blvd. Compton, CA 90221 • www.compton.edu • 310-900-1600

CAMPUS DIRECTORY 2008 - 2009

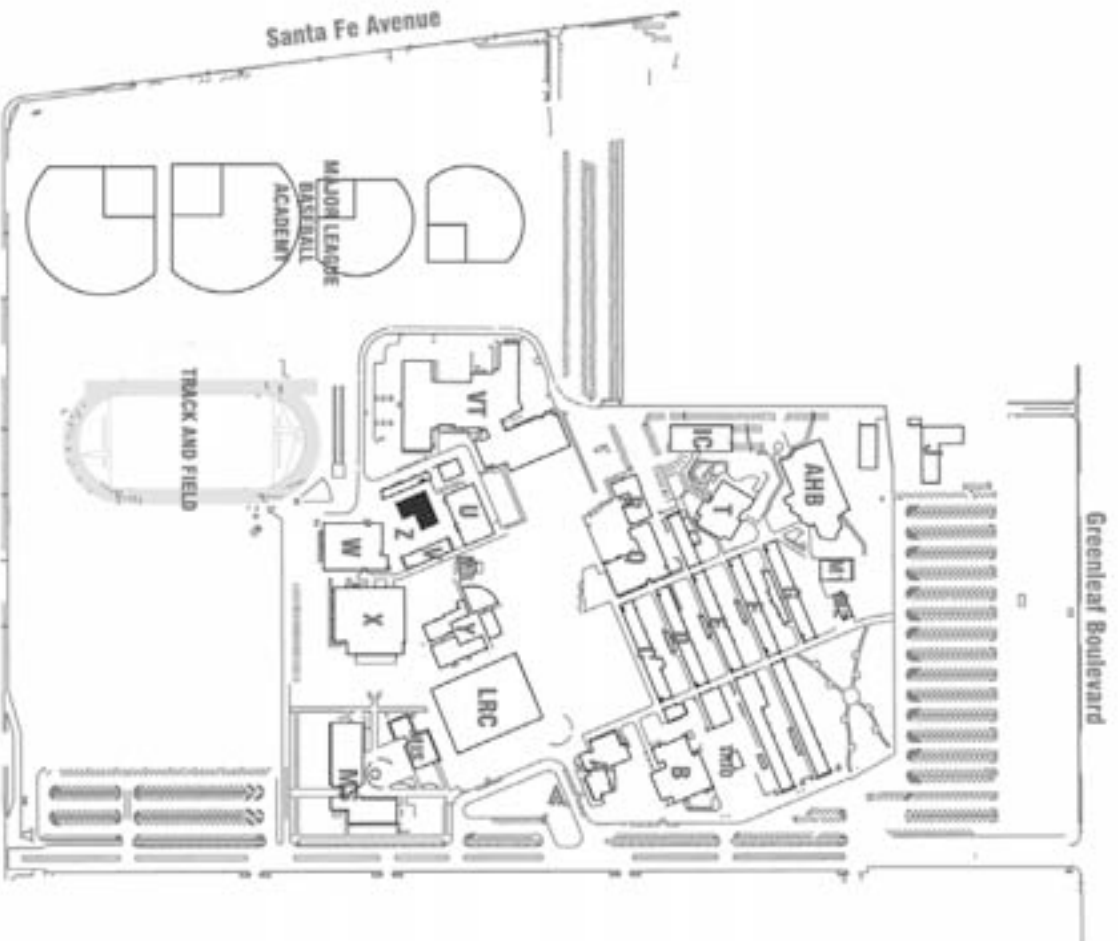

EL CAMINO COLLEGE - COMPTON CENTER

1111 E. Artesia Boulevard - Compton, CA 90221 (310) 900-1600 www.compton.edu

- A** - Administration, Provost/CEO, Admissions & Records, Counseling, Student Services
- AHB** - Allied Health Building (Closed during Renovation)
- B** - Library, Health and Human Services Division, Nursing
- C** - Academic Affairs, Business Affairs, Human Resources
- D** - Welcome Center, Transfer Center, Student Support Services, Outreach and School Relations
- DELTA** - Foster and Kinship Care Education
- E** - Social Science, Family Studies, Ethnic Studies, TV Studio, Digital Photography, Financial Aid
- F** - Journalism Lab, Language/Writing Lab, Special Resource Center (DSP/AS)
- G** - Spanish, Academic Senate, Assessment Center
- IC** - Child Development Center- Infant/Toddler Building
- J** - Maintenance
- LRC** - Learning Resource Center
- MS** - Math Science
- MSI** - Management Information Systems
- MI** - ESL/Philosophy
- MD** - Police Department
- O** - Student Lounge, Cafeteria, Faculty & Staff Lounge
- R** - Bookstore/ Student Life
- T** - Axel B. Sykes, Jr. Building- Child Development Center
- TRIO** - Talent Search, Upward Bound, Upward Bound Math & Science
- U** - EOP/SL CARE, Women's Locker Room
- V** - Classrooms
- VT** - Engineering, Business, CIS, Machine Shop, Diesel, Auto Shop, Welding, CallWorks, Job Placement & Career Center, Print Shop
- W** - Physical Education, Athletics, Men's Locker Room
- X** - Gymnasium
- Y** - Music, Theater Arts
- Z** - Swimming Pool

DIRECTORIO del CAMPUS 2008-2009

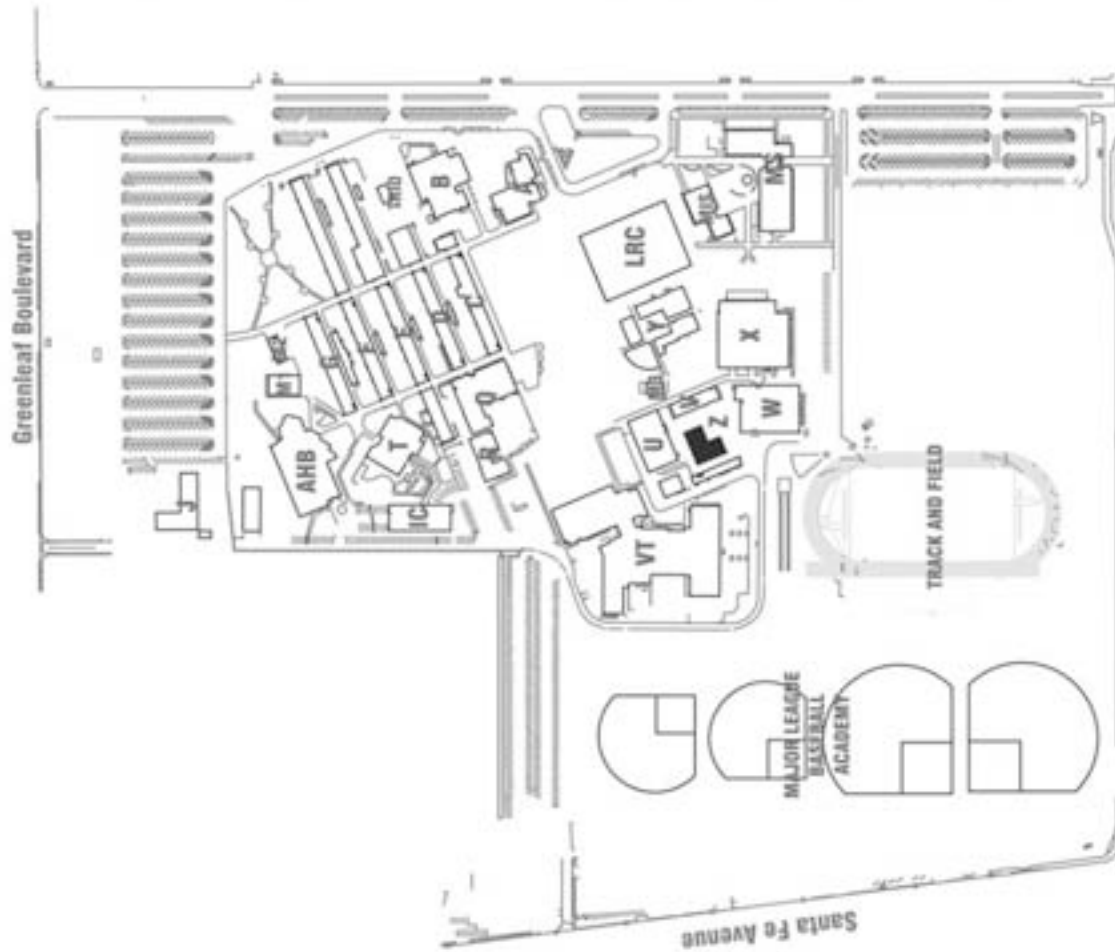

- A - Administración, Superintendencia Ejecutiva, Ingresos y Documentos, Consejerías y Servicios Estudiantiles
- AHB - Edificio de Salud Alada (cerrado durante renovación)
- B - Biblioteca, Divisiones de la Salud y Servicios Humanos, Enfermería
- C - Asesoría Académica, Asesoría de Negocios, Recursos Humanos
- D - Centro de Bienvenida, Centro de Trabajos, Servicios de Apoyo Estudiantil, Servicio Acogedor y Relaciones Colaborales
- Delta - Enseñanza Acogedora y Cuidado Parentesco
- E - Ciencias Sociales, Estudios de Familia, Estudios Éticos, Estudio (salón) de Televisión, Fotografía Digital, Ayuda Financiera
- F - Laboratorios para Periodismo, Idiomas/Ensayos y Centro de Recursos Especiales (DRPMS)
- G - Español, Sembrar Académico, Centro de Evaluación
- IC - Centro para el Desarrollo de Infantes/Niños Pequeños
- J - Mantenimiento
- LRC - Centro de Recursos de Aprendizaje
- MS - Matemáticas/Ciencias
- MIS - Sistemas de Información Administrativa
- M1 - Flexionar/Inglés Como Segundo Idioma(ESL)
- M3 - Departamento de Policía
- O - Salón Estudiantil de Descanso, Cafetería, Salón de la Ejecutiva y Empleados
- R - Librería/Vóts Estudiantil
- T - Edificio Abel B. Sykes, Jr. Centro de Desarrollo de Niños
- TRIO - Búsqueda de Talento, Camino Hacia el Éxito, Éxito con Matemáticas y Ciencias
- U - CARE/ EOPMS, Área para Vestuarios de Mujeres
- V - Las Aulas/Clases de Clases
- VT - Ingeniería, Negocios, CIS, Taller de Maquinaria, Diesel, Taller de Autos, Soldadura, CalWorks, Posiciones de Empleo y Centro para Carreras, Imprenta
- W - Educación Física, Atletismo, Vestuarios (salón) de Hombres
- X - Gimnasio
- Y - Música, Artes de Teatro
- Z - Piscina (alberca)

EL CAMINO COLLEGE - COMPTON CENTER

1111 E. Artesia Boulevard - Compton, CA 90221 (310) 900-1600 www.compton.edu



EL CAMINO COLLEGE COMPTON CENTER

All roads lead to Compton Center

EARN YOUR DEGREE

TRANSFER TO A FOUR YEAR COLLEGE OR UNIVERSITY

PREPARE FOR YOUR CAREER IN VOCATIONAL TECHNOLOGY

Apply and Register at www.compton.edu
and click on **MyECC**.

Once registered through MyECC, you can...

Add and Drop Classes, View the Current Class Schedule,
Search for Classes, See Test Scores, Check Grades,
Pay Fees or View Accounts, Check Financial Aid and
Award Letter Status, Locate Faculty, Print Unofficial
Transcripts, and **Receive the Latest Campus
Updates and Information.**

GOT E-MAIL?

Have you checked your **MyECC** e-mail today?
Find out what you're missing!

IMPORTANT REMINDER:

Visit **MyECC** to check registration
appointment dates. This information will no longer
be available via mail.



El Camino College Compton Center
1111 E. Artesia Blvd
Compton, CA 90221

www.compton.edu • 310-900-1600

SUMMER SESSION BEGINS JUNE 15